



**Reichhardt & Ebe**  
ENGINEERING INC

## TRANSMITTAL SHEET

**Date sent:** Monday, October 5, 2020  
**Sent to:** All Planholders  
**Deliver to:** Project Estimator  
**Transmission sent from:** Reichhardt & Ebe Engineering  
**Number of pages including this page:** 16

## CONFIRMATION OF RECEIPT OF ADDENDUM

**PROJECT: Complete Streets Project**  
**City Project Number ST2019-02**  
**TIB Project Number C-W-985(001)-1**

---

**Please complete the following form and  
email back to Reichhardt & Ebe Engineering, Inc. at  
[officeadmin@recivil.com](mailto:officeadmin@recivil.com) as soon as possible.**

**Have you received Addendum No. 1 for the above-mentioned  
project?**

☐ **YES, we received Addendum No. 1**

**Signed:** \_\_\_\_\_ **Dated:** \_\_\_\_\_

**Company name (Please Print):** \_\_\_\_\_

## TRANSMITTAL SHEET

TO:	FROM:
ALL BIDDERS	Luis Ponce, P.E.
COMPANY:	DATE:
	October 5, 2020
ADDRESS:	TOTAL NO. OF PAGES INCLUDING COVER:
	16
RE:	
City of Ferndale	
Addendum 1	
Complete Streets Project	
City Project Number ST2019-02	
TIB Project Number C-W-985(001)-1	

NOTES/COMMENTS:

### To the attention of all bidders for the above project:

Please find the enclosed Addendum for the above referenced project.

The enclosed ADDENDUM is to be considered as much a part of the Contract Documents as if it were included in the body of the plans and specifications, and will be incorporated in and made a part of the contract when awarded and when formally executed.

The Bidder shall acknowledge in writing, on the bid form, this addendum in order to have the bid considered.

Luis Ponce, P.E.



**ADDENDUM NO. 1**  
**To the Contract Provisions for**  
**CITY OF FERNDAL, WASHINGTON**

**Complete Streets Project**  
**City Project Number ST2019-02**  
**TIB Project Number C-W-985(001)-1**

**ITEM 1**  
**BID PROPOSAL FORM**

The Bid Proposal Form is replaced in its entirety with the attached **REVISED BID PROPOSAL FORM**. Only bids submitted on the **REVISED BID PROPOSAL FORM** will be considered responsive.

The Bid Proposal Form has been revised as follows:

Bid Proposal Form, ITEM NO. 4, 'Flaggers', the quantity has been increased.

Bid Proposal Form, ITEM NO. 5, 'Other Traffic Control Labor', the quantity has been increased.

Bid Proposal Form, ITEM NO. 8, 'Sawcut ACP', the quantity has been increased.

Bid Proposal Form, ITEM NO. 17, 'Self-Adhering Rubberized Asphalt Membrane', has been removed from the Bid Proposal Form.

Bid Proposal Form, ITEM NO. 33, 'Cement Conc. Traffic Curb and Gutter', the quantity has been increased.

Bid Proposal Form, ITEM NO. 34, 'Cement Conc. Sidewalk', the quantity has been increased.

**ITEM 2**

**1-10.4(3) Reinstating Unit Items With Lump Sum Traffic Control**

Section 1-10.4(3) of the special provisions, page 59, lines 38-42 are deleted and replaced with the following:

The bid proposal contains the item "Project Temporary Traffic Control," lump sum and the additional temporary traffic control items listed below. "Flaggers" and "Other Traffic Control Labor" will only be measured and paid for the Vista St and Seamount St Intersection Work and the Thornton St and Maureen Dr Intersection Work. The provisions of Section 1-10.4(1), Section 1-10.4(3), and Section 1-10.5(3) shall apply.

### **ITEM 3**

#### **PLANS**

The following sheets shall be deleted and replaced with the attached plan sheets.

##### Sheet 3

- 2" asphalt planing labels were added for clarity.

##### Sheet 6

- Sawcut and demolition were extended on southwest and southeast corners of the intersection.
- Existing maple tree removed from southeast corner of intersection (outside of right-of-way).

##### Sheet 7

- Sidewalk, curb and gutter, and asphalt were extended on southwest and southeast corners of the intersection.
- Existing maple tree removed from southeast corner of intersection (outside of right-of-way).

##### Sheet 8

- Updated grade ticks for extended sidewalk, curb and gutter, and asphalt on southwest and southeast corners of the intersection.
- Existing maple tree removed from southeast corner of intersection (outside of right-of-way).

##### Sheet 9

- 2" asphalt planing label was added for clarity.

##### Sheet 20

- Roadway Pavement Match Section detail was modified.

**CITY OF FERNDALE  
COMPLETE STREETS**

( ) SECTION REFERENCE

**ADDENDUM 1**

October 2, 2020

ITEM NO.	QUANTITY	DESCRIPTION	UNIT PRICE	TOTAL
1	1 LUMP SUM	MOBILIZATION (1-09.7)		
			\$	\$
			per LS	
2	1 LUMP SUM	SPCC PLAN (1-07)		
			\$	\$
			per LS	
3	1 LUMP SUM	PROJECT TEMPORARY TRAFFIC CONTROL (1-10)		
			\$	\$
			per LS	
4	200 HOUR	FLAGGERS (1-10)		
			\$	\$
			per HR	
5	20 HOUR	OTHER TRAFFIC CONTROL LABOR (1-10)		
			\$	\$
			per HR	
6	1 LUMP SUM	CLEARING AND GRUBBING (2-01)		
			\$	\$
			per LS	
7	1 LUMP SUM	REMOVAL OF STRUCTURES AND OBSTRUCTIONS (2-02)		
			\$	\$
			per LS	
8	3,855 LINEAR FOOT-INCH	SAWCUT ACP (2-02)		
			\$	\$
			per LF-IN	
9	1,035 LINEAR FOOT-INCH	SAWCUT PCC (2-02)		
			\$	\$
			per LF-IN	

**CITY OF FERNDALE  
COMPLETE STREETS**

( ) SECTION REFERENCE

**ADDENDUM 1**

October 2, 2020

ITEM NO.	QUANTITY	DESCRIPTION	UNIT PRICE	TOTAL
10	60 CUBIC YARD	ROADWAY EXCAVATION INCL. HAUL (2-03)	\$	\$
			per CY	
11	20 M GAL.	WATER (2-07)	\$	\$
			per M GAL.	
12	70 SQUARE FOOT	SHORING OR EXTRA EXCAVATION CLASS B (2-09)	\$	\$
			per SF	
13	152 TON	GRAVEL BASE (4-02)	\$	\$
			per TON	
14	40 TON	CRUSHED SURFACING TOP COURSE (4-04)	\$	\$
			per TON	
15	90 TON	COMMERCIAL HMA (5-04)	\$	\$
			per TON	
16	175 SQUARE YARD	PLANING BITUMINOUS PAVEMENT (5-04)	\$	\$
			per SY	
17		THIS ITEM INTENTIONALLY LEFT BLANK		
18	7 LINEAR FOOT	SOLID WALL PVC STORM SEWER PIPE 8 IN. DIAM. (7-04)	\$	\$
			per LF	

**CITY OF FERNDALE  
COMPLETE STREETS**

( ) SECTION REFERENCE

**ADDENDUM 1**

October 2, 2020

ITEM NO.	QUANTITY	DESCRIPTION	UNIT PRICE	TOTAL
19	24 LINEAR FOOT	DUCTILE IRON STORM SEWER PIPE 6 IN. DIAM. (7-04)	\$	\$
			per LF	
20	3 EACH	CATCH BASIN TYPE 1 (7-05)	\$	\$
			per EA	
21	1 EACH	CATCH BASIN TYPE 1L (7-05)	\$	\$
			per EA	
22	4 EACH	STANDARD FRAME & ADA GRATE ALT. 1 (7-05)	\$	\$
			per EA	
23	3 EACH	STANDARD FRAME & HERRINGBONE GRATE (7-05)	\$	\$
			per EA	
24	1 LUMP SUM	ADJUSTMENTS TO FINISHED GRADE (7-05)	\$	\$
			per LS	
25	1 LUMP SUM	ESC LEAD (8-01)	\$	\$
			per LS	
26	40 HOUR	STREET CLEANING (8-01)	\$	\$
			per HR	
27	1 EST	EROSION/WATER POLLUTION CONTROL (8-01)	\$	\$
			2,000.00	2,000.00
			EST	

**CITY OF FERNDALE  
COMPLETE STREETS**

( ) SECTION REFERENCE

**ADDENDUM 1**

October 2, 2020

ITEM NO.	QUANTITY	DESCRIPTION	UNIT PRICE	TOTAL
28	15 EACH	INLET PROTECTION (8-01)		
			\$	\$
			per EA	
29	14 LINEAR FOOT	CHECK DAM (8-01)		
			\$	\$
			per LF	
30	83 SQUARE YARD	SEEDING, FERTILIZING, AND MULCHING (8-02)		
			\$	\$
			per SY	
31	7 SQUARE YARD	BARK OR WOOD CHIP MULCH (8-02)		
			\$	\$
			per SY	
32	1 EST	LANDSCAPE RESTORATION (8-02)		
			\$	\$
			1,500.00	1,500.00
			EST	
33	395 LINEAR FOOT	CEMENT CONC. TRAFFIC CURB AND GUTTER (8-04)		
			\$	\$
			per LF	
34	170 SQUARE YARD	CEMENT CONC. SIDEWALK (8-14)		
			\$	\$
			per SY	
35	4 EACH	CEMENT CONC. CURB RAMP TYPE PARALLEL A (8-14)		
			\$	\$
			per EA	
36	4 EACH	CEMENT CONC. CURB RAMP TYPE PERPENDICULAR A (8-14)		
			\$	\$
			per EA	



**CITY OF FERNDALE  
COMPLETE STREETS**

( ) SECTION REFERENCE

**ADDENDUM 1**

October 2, 2020

ITEM NO.	QUANTITY	DESCRIPTION	UNIT PRICE	TOTAL
37	5 EACH	CEMENT CONC. CURB RAMP TYPE SINGLE DIRECTION A (8-14)		
			\$	\$
			per EA	
38	9 SQUARE YARD	CEMENT CONC. RAMP LANDING (8-14)		
			\$	\$
			per SY	
39	1 LUMP SUM	RRFB SYSTEMS (8-20)		
			\$	\$
			per LS	
40	1 LUMP SUM	PERMANENT SIGNING (8-21)		
			\$	\$
			per LS	
41	1,442 SQUARE FOOT	PLASTIC CROSSWALK LINE (8-22)		
			\$	\$
			per SF	
42	72 LINEAR FOOT	PLASTIC STOP LINE (8-22)		
			\$	\$
			per LF	
43	555 SQUARE FOOT	REMOVING PLASTIC CROSSWALK LINE (8-22)		
			\$	\$
			per SF	
44	91 LINEAR FOOT	REMOVING PLASTIC LINE (8-22)		
			\$	\$
			per LF	
45	6 EACH	POTHOLE EXISTING UNDERGROUND UTILITY (8-30)		
			\$	\$
			per EA	

**CITY OF FERNDALE  
COMPLETE STREETS**

( ) SECTION REFERENCE

**ADDENDUM 1**

October 2, 2020

ITEM NO.	QUANTITY	DESCRIPTION	UNIT PRICE	TOTAL
46	1 EST	REPAIR EXISTING PUBLIC AND PRIVATE FACILITIES (8-31)		
			\$ 2,500.00	\$ 2,500.00
			EST	

**Total \$**

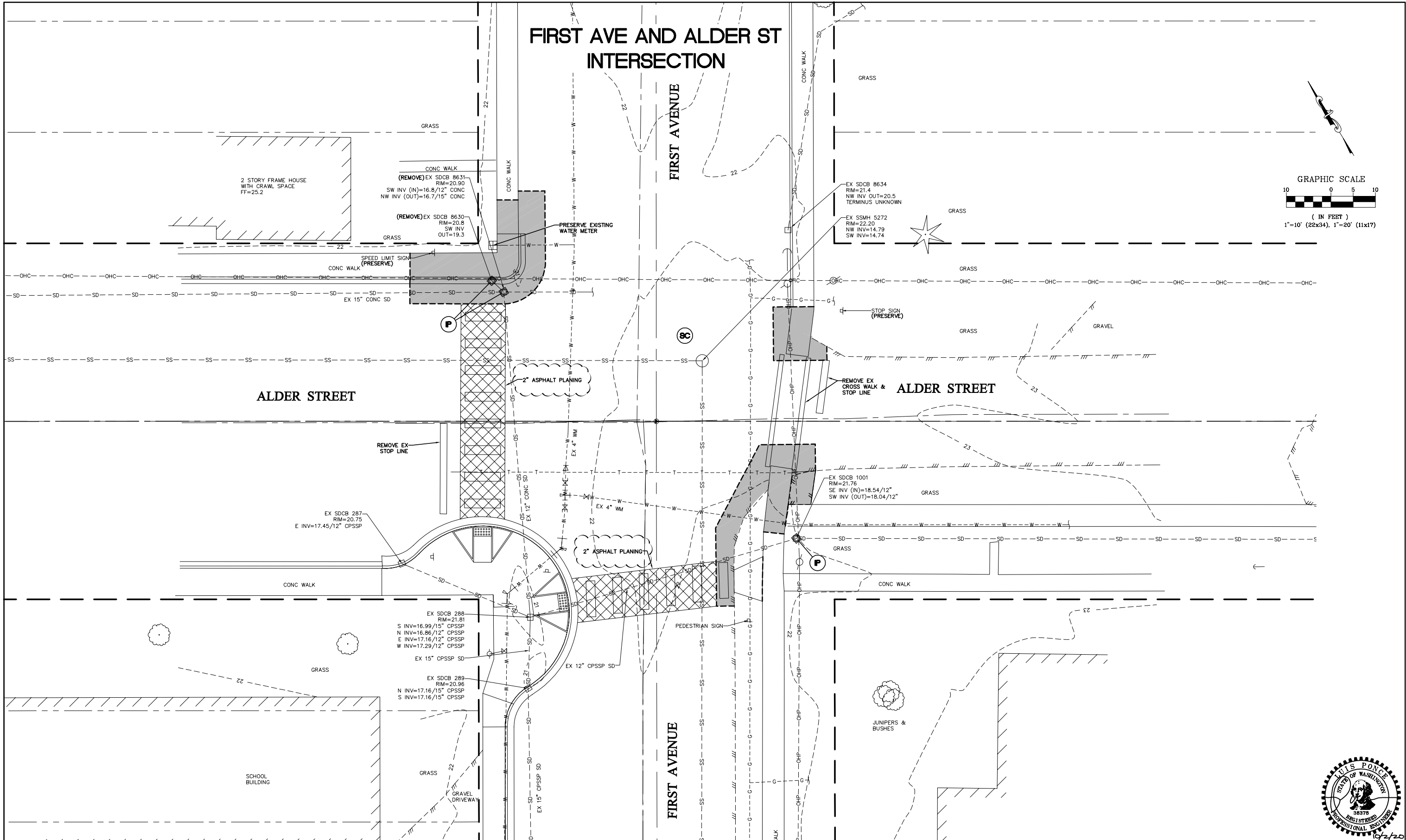

ADDENDUM

DESIGNED BY  
OAM  
DRAWN BY  
LMH  
CHECKED BY  
LP

**R&E** Reichhardt & Ebe  
ENGINEERING INC  
P.O. Box 978 | 423 Front Street  
Lynden, WA 98264 (360) 354-3687

NO.	DATE	DESCRIPTION	BY
1	10/2/20	ADDENDUM No. 1	OAM

CITY OF FERNDALE  
2095 MAIN ST  
FERNDALE, WA 98226

COMPLETE STREETS

EX COND, DEMO AND TESC - 1ST AND ALDER

DWG 19024 PLOT

JOB#

19024

SCALE

H: 1"=10'

V: N/A

DATE

10/2/20

SHEET

3

of 23

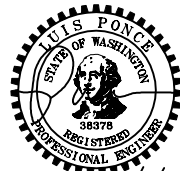



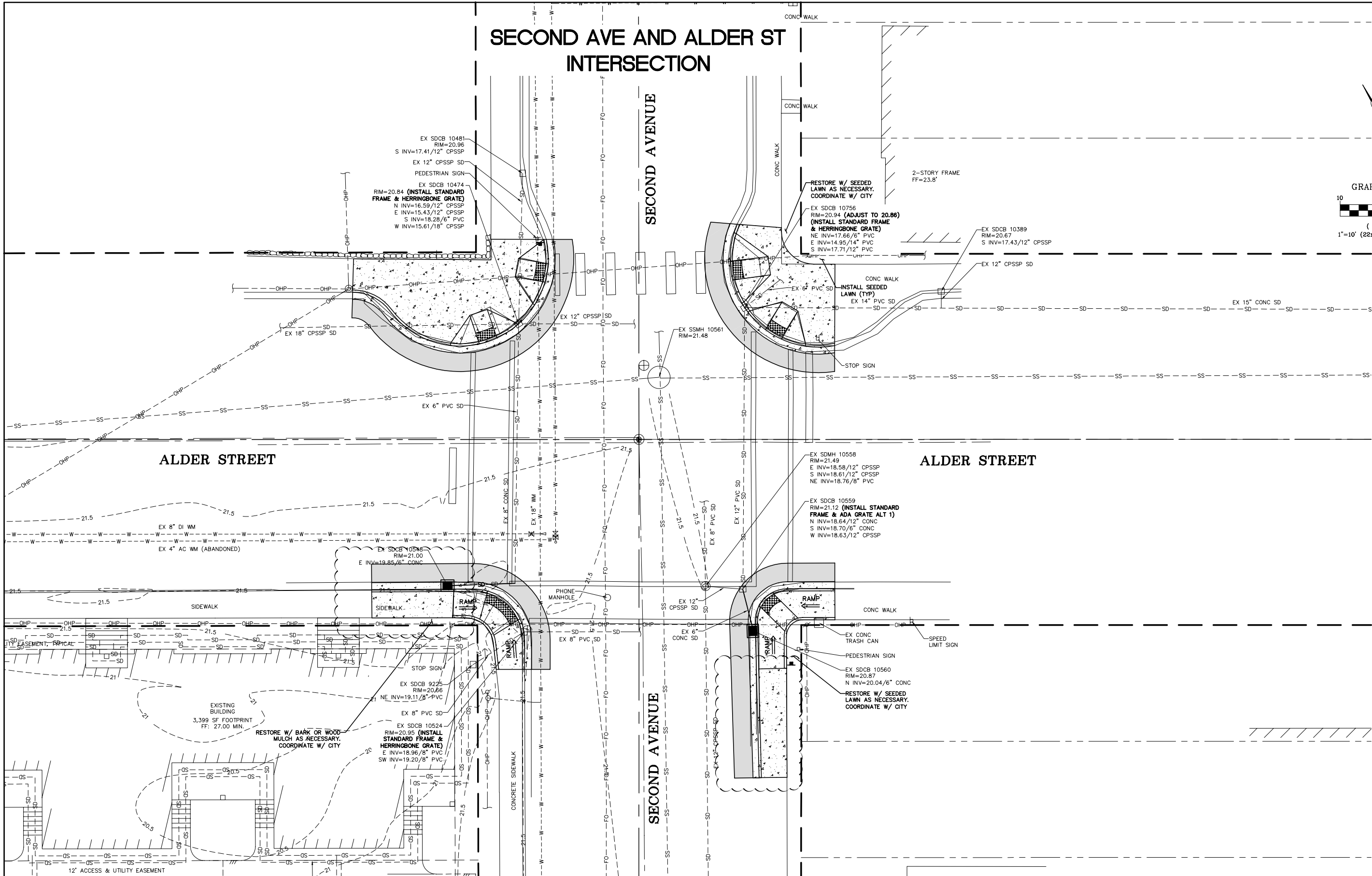

ADDENDUM

DESIGNED BY  
OAM  
DRAWN BY  
LMH  
CHECKED BY  
LP

**R&E** Reichhardt & Ebe  
ENGINEERING INC  
P.O. Box 978 | 423 Front Street  
Lynden, WA 98264 (360) 354-3687

NO.	DATE	DESCRIPTION	BY
1	10/2/20	ADDENDUM No. 1	OAM

CITY OF FERDALE  
2095 MAIN ST  
FERDALE, WA 98226

COMPLETE STREETS  
PLAN - 2ND AND ALDER

DWG 19024 PLOT  
JOB# 19024

SCALE  
H: 1"=10' V: N/A

DATE 10/2/20  
SHEET 7 of 23



SECOND AVE AND ALDER ST  
INTERSECTION

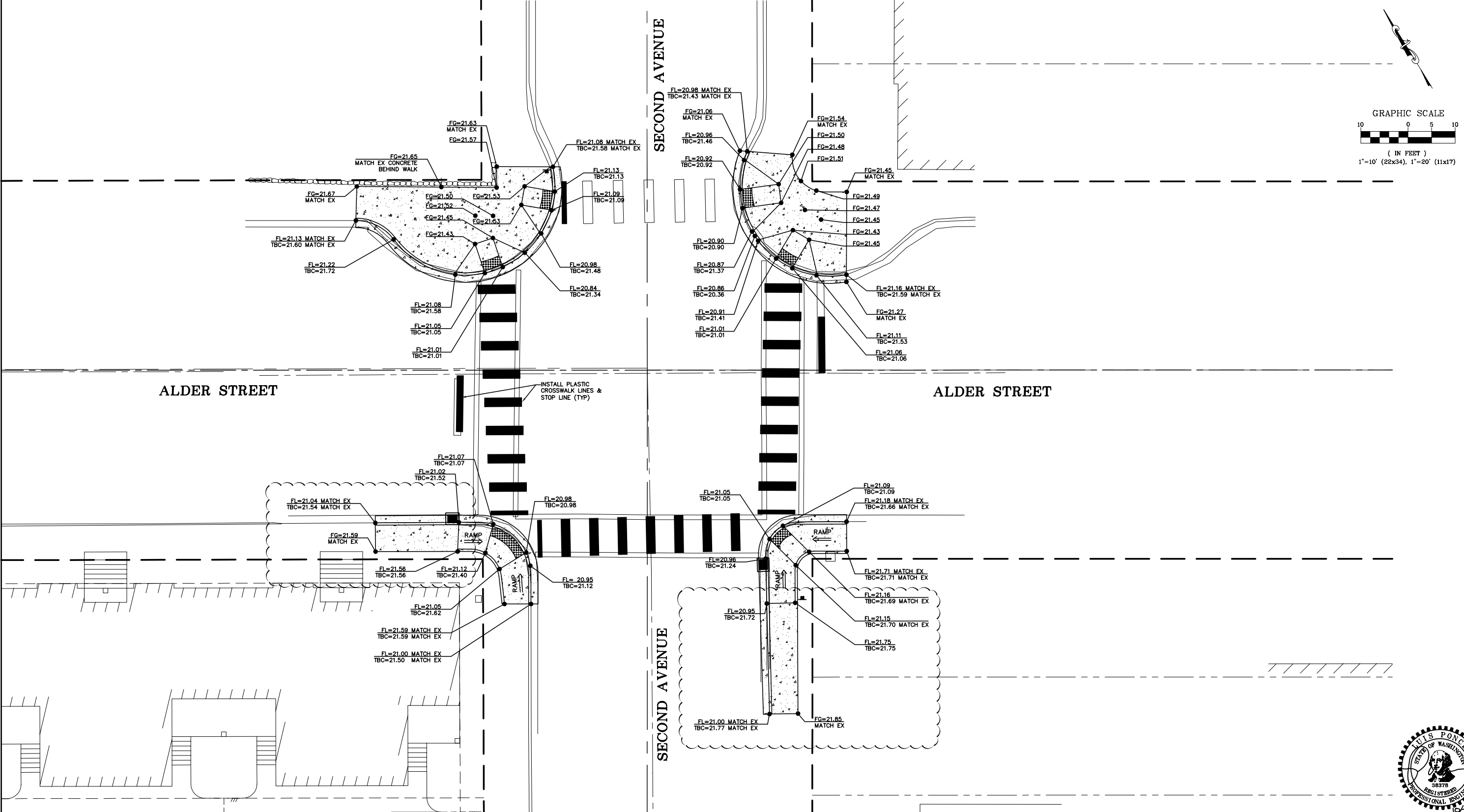

ALDER STREET

ALDER STREET

SECOND AVENUE

SECOND AVENUE

ADDENDUM

DESIGNED BY  
OAM  
DRAWN BY  
LMH  
CHECKED BY  
LP

**R&E** Reichhardt & Ebe  
ENGINEERING INC  
P.O. Box 978 | 423 Front Street  
Lynden, WA 98264 (360) 354-3687

NO.	DATE	DESCRIPTION	BY
1	10/2/20	ADDENDUM No. 1	OAM

CITY OF FERNDAL  
2095 MAIN ST  
FERNDAL, WA 98226

COMPLETE STREETS  
GRADING AND CHANNELIZATION - 2ND AND ALDER

DWG	19024 PLOT	DATE	10/2/20
JOB#	19024	SCALE	H: 1"=10' V: N/A
SHEET	8	of 23	



P:\Projects\19024\19024\_PLOT.dwg, 6 SEP 2020 10:57 AM, P:\ACAD\pdx\luis.ponce

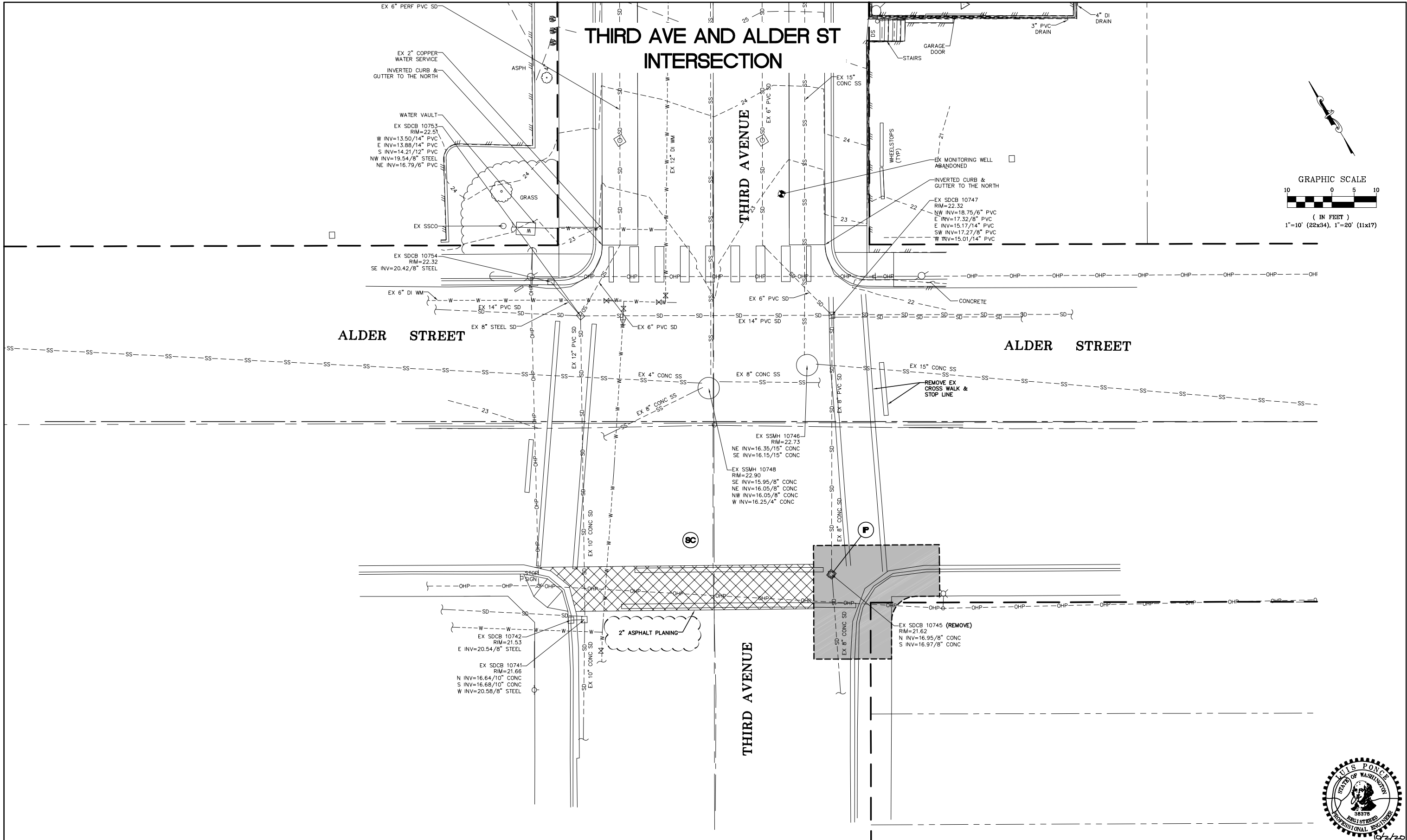

ADDENDUM

DESIGNED BY  
OAM  
DRAWN BY  
LMH  
CHECKED BY  
LP



**Reichhardt & Ebe**  
**ENGINEERING INC**  
P.O. Box 978 | 423 Front Street  
Lynden, WA 98264 (360) 354-3687

NO.	DATE	DESCRIPTION	BY
1	10/2/20	ADDENDUM No. 1	OAM

CITY OF FERNDAL  
2095 MAIN ST  
FERNDAL, WA 98226

COMPLETE STREETS

EX COND, DEMO AND TESC - 3RD AND ALDER

DWG 19024 PLOT

JOB#

19024

SCALE

H: 1"=10'

V: N/A

DATE

10/2/20

SHEET

9  
of 23



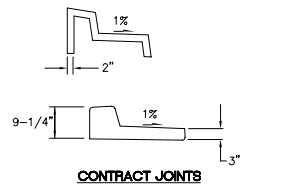

8. FURTHER REQUIREMENTS SHALL BE AS SPECIFIED IN THE STANDARD SPECIFICATIONS.

## CURB AND GUTTER INSTALLATION REVERSE SLOPE

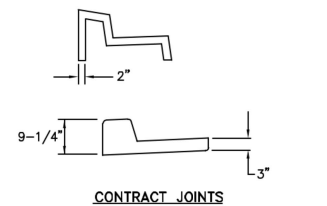

8. FURTHER REQUIREMENTS SHALL BE AS SPECIFIED IN THE STANDARD SPECIFICATIONS.

Public Works Director

Date: \_\_\_\_\_

**CURB AND GUTTER  
INSTALLATION**

**STANDARD DETAIL R-9**

NOT TO SCALE



## ADDENDUM

**R&E** Reichhardt & Ebe  
ENGINEERING INC  
P.O. Box 978 | 423 Front Street  
Lynden, WA 98264 (360) 354-3687

ADDENDUM No	DESCRIPTION
-------------	-------------

CITY OF FERNDALE  
2095 MAIN ST  
FERNDALE, WA 98226

## COMPLETE STREETS

### ROAD DETAILS

19024

H: **N/A**v: **N/A**

DATE 10/2/20  
SHEET 20 of 23

