



Reichhardt & Ebe
ENGINEERING INC

TRANSMITTAL SHEET

Date sent: Monday, July 2, 2018
Sent to: All Planholders
Deliver to: Project Estimator
Transmission sent from: Reichhardt & Ebe Engineering
Number of pages including this page: 21

CONFIRMATION OF RECEIPT OF ADDENDUM

PROJECT: City of Ferndale Cherry Street Sidewalk Project
(Schedule A and Schedule B) and Pioneer Park
Sidewalk Project (Schedule C)

Please complete the following form and
email back to Reichhardt & Ebe Engineering, Inc. at
officeadmin@recivil.com as soon as possible.

Have you received Addendum No. 1 for the above-mentioned
project?

☐ YES, we received Addendum No. 1

Signed: _____ Dated: _____

Company name (Please Print): _____

ADDENDUM NO. 1
To the Contract Provisions for
CITY OF FERNDAL, WASHINGTON

Cherry Street Sidewalk Project, City Project No. ST2015-09 (Schedule A and Schedule B)
Pioneer Park Sidewalk Project, City Project No. PA2018-01 (Schedule C)

ITEM 1

The Bid Proposal Form is deleted and replaced with the **Revised Bid Proposal Form**.

Only bids submitted on the **Revised Bid Proposal Form** labeled “**ADDENDUM NO. 1**”, as included in the Addendum shall be accepted as responsive bids.

The Bid Proposal Form has been revised as follows:

- Bid Item 8 “Sawcut ACP”, the quantity was increased.
- Bid Item 10 “Roadway Excavation Incl. Haul”, the quantity was decreased.
- Bid Item 15 “HMA Cl. 1/2” PG 64-22”, the quantity was increased.
- Bid Item 18A, “Corrugated Polyethylene Storm Sewer Pipe 18 In. Diam.”, has been added to the Bid Proposal Form.
- Bid Item 19 “Corrugated Polyethylene Storm Sewer Pipe 8 In. Diam”, the quantity was increased.
- Bid Item 20 “Concrete Inlet”, the quantity was increased.
- Bid Item 21 “Catch Basin Type 1”, the quantity was increased.
- Bid Item 22 “Standard Frame & Solid Locking Lid”, the quantity was decreased.
- Bid Item 53 “Roadway Excavation Incl. Haul”, the quantity was decreased.
- Bid Item 56 “Gravel Base”, the quantity was increased.
- Bid Item 62 “Corrugated Polyethylene Storm Sewer Pipe 12 In. Diam.”, the quantity was decreased.
- Bid Item 64A, “Concrete Inlet”, has been added to the Bid Proposal Form.
- Bid Item 64 “Catch Basin Type 1”, the quantity was decreased.
- Bid Item 66 “Catch Basin – PVC”, was deleted.
- Bid Item 67 “Standard Frame & Solid Locking Lid”, the quantity was increased.
- Bid Item 68 “Standard Frame & Grate”, the quantity was decreased.

ITEM 2

The following sheets shall be deleted and replaced with the attached plan sheets.

Schedule A and Schedule B, All Plan Sheets

The standard frame for solid locking cover shall be per WSDOT Standard Plan B-30.10-02.

Schedule A and Schedule B, Plan Sheet 5

Demolition areas revised and sign/storm notes revised as shown.

Schedule A and Schedule B, Plan Sheet 8

Storm drain catchbasins and storm drain pipes revised as shown.

Schedule A and Schedule B, Plan Sheet 10

Seeded lawn added at relocated catchbasin as shown.

Schedule A and Schedule B, Plan Sheet 13

Grade information added at relocated catchbasin as shown.

Schedule C, Plan Sheet 3

The removal of pavers between approximately STA 1+00 RT to STA 1+50 RT were added.

Schedule C, Plan Sheet 4

- The sidewalk layout between approximately STA 1+00 RT to STA 1+50 RT was revised.
- The conduit at approximately STA 2+60 RT, STA 2+60 LT, and STA 3+90 LT were removed.
- Conduit location were revised as shown.

ITEM 3**1-08.4 Notice to Proceed and Prosecution of Work**

Page 92, line 41, is revised to read:

The Contractor shall begin Schedule A and Schedule B work no earlier than *****August 6, 2018*****.
The Contractor shall begin Schedule C work no earlier than *****August 13, 2018*****.

Point of clarification.

The first Invitation for Bids advertisement called out the schedules incorrectly. Subsequent advertisements corrected this error.

END OF ADDENDUM NO. 1

Acknowledgement that this addendum has been received is required on the Bid Proposal.

Sincerely,



Luis Ponce, P.E.
Project Engineer

ADDENDUM NO. 1

**CITY OF FERNDALE
CHERRY STREET SIDEWALK PROJECT AND PIONEER PARK SIDEWALK PROJECT**

() SECTION REFERENCE

July 2, 2018

ITEM NO.	QUANTITY	DESCRIPTION	UNIT PRICE	TOTAL
Schedule A				
1	1 LUMP SUM	MOBILIZATION (1-09.7)		
			\$	\$
			per LS	
2	1 LUMP SUM	SPCC PLAN (1-07)		
			\$	\$
			per LS	
3	120 HOUR	FLAGGERS (1-10)		
			\$	\$
			per HR	
4	20 HOUR	OTHER TRAFFIC CONTROL LABOR (1-10)		
			\$	\$
			per HR	
5	1 LUMP SUM	PROJECT TEMPORARY TRAFFIC CONTROL (1-10)		
			\$	\$
			per LS	
6	1 LUMP SUM	CLEARING AND GRUBBING (2-01)		
			\$	\$
			per LS	
7	1 LUMP SUM	REMOVAL OF STRUCTURES AND OBSTRUCTIONS (2-02)		
			\$	\$
			per LS	
8	3,735 LINEAR FOOT-INCH	SAWCUT ACP (2-02)		
			\$	\$
			per LF-IN	
9	240 LINEAR FOOT-INCH	SAWCUT PCC (2-02)		
			\$	\$
			per LF-IN	
10	180 CUBIC YARD	ROADWAY EXCAVATION INCL. HAUL (2-03)		
			\$	\$
			per CY	

ADDENDUM NO. 1

**CITY OF FERNDALE
CHERRY STREET SIDEWALK PROJECT AND PIONEER PARK SIDEWALK PROJECT**

() SECTION REFERENCE

July 2, 2018

ITEM NO.	QUANTITY	DESCRIPTION	UNIT PRICE	TOTAL
11	12 M GAL.	WATER (2-07)		
			\$	\$
			per M GAL.	
12	15 SQUARE FOOT	SHORING OR EXTRA EXCAVATION CLASS B (2-09)		
			\$	\$
			per SF	
13	220 TON	GRAVEL BASE (4-02)		
			\$	\$
			per TON	
14	20 TON	CRUSHED SURFACING TOP COURSE (4-04)		
			\$	\$
			per TON	
15	45 TON	HMA CL. 1/2" PG 64-22 (5-04)		
			\$	\$
			per TON	
16	0 CALC	JOB MIX COMPLIANCE PRICE ADJUSTMENT (5-04)		
			\$	0
			CALC	
17	0 CALC	COMPACTION PRICE ADJUSTMENT (5-04)		
			\$	0
			CALC	
18A	70 LINEAR FOOT	CORRUGATED POLYETHYLENE STORM SEWER PIPE 18 IN. DIAM. (7-04)		
			\$	\$
			per LF	
18	25 LINEAR FOOT	CORRUGATED POLYETHYLENE STORM SEWER PIPE 12 IN. DIAM. (7-04)		
			\$	\$
			per LF	
19	40 LINEAR FOOT	CORRUGATED POLYETHYLENE STORM SEWER PIPE 8 IN. DIAM. (7-04)		
			\$	\$
			per LF	

ADDENDUM NO. 1

**CITY OF FERNDALE
CHERRY STREET SIDEWALK PROJECT AND PIONEER PARK SIDEWALK PROJECT**

() SECTION REFERENCE

July 2, 2018

ITEM NO.	QUANTITY	DESCRIPTION	UNIT PRICE	TOTAL
20	3 EACH	CONCRETE INLET (7-05)		
			\$	\$
			per EA	
21	2 EACH	CATCH BASIN TYPE 1 (7-05)		
			\$	\$
			per EA	
22	3 EACH	STANDARD FRAME & SOLID LOCKING LID (7-05)		
			\$	\$
			per EA	
23	2 EACH	STANDARD FRAME & GRATE (7-05)		
			\$	\$
			per EA	
24	1 LUMP SUM	ADJUSTMENTS TO FINISHED GRADE (7-05)		
			\$	\$
			per LS	
25	1 LUMP SUM	ESC LEAD (8-01)		
			\$	\$
			per LS	
26	1 FORCE ACCOUNT	EROSION/WATER POLLUTION CONTROL (8-01)		
			\$ 1,300.00	\$ 1,300.00
			FA	
27	11 EACH	INLET PROTECTION (8-01)		
			\$	\$
			per EA	
28	250 LINEAR FOOT	SILT FENCE (8-01)		
			\$	\$
			per LF	
29	210 SQUARE YARD	SEEDED LAWN INSTALLATION (8-02)		
			\$	\$
			per SY	

ADDENDUM NO. 1

**CITY OF FERNDALE
CHERRY STREET SIDEWALK PROJECT AND PIONEER PARK SIDEWALK PROJECT**

() SECTION REFERENCE

July 2, 2018

ITEM NO.	QUANTITY	DESCRIPTION	UNIT PRICE	TOTAL
30	1 FORCE ACCOUNT	LANDSCAPE RESTORATION (8-02)		
			\$ 700.00	\$ 700.00
			FA	
31	485 LINEAR FOOT	CEMENT CONC. TRAFFIC CURB AND GUTTER (8-04)		
			\$	\$
			per LF	
32	185 SQUARE YARD	CEMENT CONC. SIDEWALK (8-14)		
			\$	\$
			per SY	
33	1 EACH	CEMENT CONC. CURB RAMP TYPE SINGLE DIRECTION A (8-14)		
			\$	\$
			per EA	
34	4 EACH	CEMENT CONC. CURB RAMP TYPE PERPENDICULAR A (8-14)		
			\$	\$
			per EA	
35	1 EACH	CEMENT CONC. CURB RAMP TYPE COMBINATION (8-14)		
			\$	\$
			per EA	
36	1 EACH	CEMENT CONC. CURB RAMP TYPE COMBINATION (MODIFIED) (8-14)		
			\$	\$
			per EA	
37	300 LINEAR FOOT	PAINT LINE (8-22)		
			\$	\$
			per LF	
38	90 LINEAR FOOT	PLASTIC STOP LINE (8-22)		
			\$	\$
			per LF	
39	720 SQUARE FOOT	PLASTIC CROSSWALK LINE (8-22)		
			\$	\$
			per SF	

ADDENDUM NO. 1

CITY OF FERNDALE
CHERRY STREET SIDEWALK PROJECT AND PIONEER PARK SIDEWALK PROJECT

() SECTION REFERENCE

July 2, 2018

ITEM NO.	QUANTITY	DESCRIPTION	UNIT PRICE	TOTAL
40	130 LINEAR FOOT	REMOVING PLASTIC LINE (8-22)		
			\$	\$
			per LF	
41	650 SQUARE FOOT	REMOVING PLASTIC CROSSWALK LINE (8-22)		
			\$	\$
			per SF	
42	4 EACH	POTHOLE EXISTING UNDERGROUND UTILITY (8-30)		
			\$	\$
			per EA	
43	1 EST	REPAIR EXISTING PUBLIC AND PRIVATE FACILITIES (8-31)		
			\$	\$
			1,500.00	1,500.00
			EST	

Total Schedule A \$

ADDENDUM NO. 1

**CITY OF FERNDALE
CHERRY STREET SIDEWALK PROJECT AND PIONEER PARK SIDEWALK PROJECT**

() SECTION REFERENCE

July 2, 2018

ITEM NO.	QUANTITY	DESCRIPTION	UNIT PRICE	TOTAL
Schedule B				
44	1 LUMP SUM	MOBILIZATION (1-09.7)		
			\$	\$
			per LS	
45	1 LUMP SUM	SPCC PLAN (1-07)		
			\$	\$
			per LS	
46	180 HOUR	FLAGGERS (1-10)		
			\$	\$
			per HR	
47	30 HOUR	OTHER TRAFFIC CONTROL LABOR (1-10)		
			\$	\$
			per HR	
48	1 LUMP SUM	PROJECT TEMPORARY TRAFFIC CONTROL (1-10)		
			\$	\$
			per LS	
49	1 LUMP SUM	CLEARING AND GRUBBING (2-01)		
			\$	\$
			per LS	
50	1 LUMP SUM	REMOVAL OF STRUCTURES AND OBSTRUCTIONS (2-02)		
			\$	\$
			per LS	
51	1,430 LINEAR FOOT-INCH	SAWCUT ACP (2-02)		
			\$	\$
			per LF-IN	
52	620 LINEAR FOOT-INCH	SAWCUT PCC (2-02)		
			\$	\$
			per LF-IN	
53	130 CUBIC YARD	ROADWAY EXCAVATION INCL. HAUL (2-03)		
			\$	\$
			per CY	

ADDENDUM NO. 1

**CITY OF FERNDALE
CHERRY STREET SIDEWALK PROJECT AND PIONEER PARK SIDEWALK PROJECT**

() SECTION REFERENCE

July 2, 2018

ITEM NO.	QUANTITY	DESCRIPTION	UNIT PRICE	TOTAL
54	18 M GAL.	WATER (2-07)		
			\$	\$
			per M GAL.	
55	20 SQUARE FOOT	SHORING OR EXTRA EXCAVATION CLASS B (2-09)		
			\$	\$
			per SF	
56	280 TON	GRAVEL BASE (4-02)		
			\$	\$
			per TON	
57	30 TON	CRUSHED SURFACING TOP COURSE (4-04)		
			\$	\$
			per TON	
58	15 TON	HMA CL. 1/2" PG 64-22 (5-04)		
			\$	\$
			per TON	
59	0 CALC	JOB MIX COMPLIANCE PRICE ADJUSTMENT (5-04)		
			\$	0
			CALC	
60	0 CALC	COMPACTION PRICE ADJUSTMENT (5-04)		
			\$	0
			CALC	
61	35 LINEAR FOOT	CORRUGATED POLYETHYLENE STORM SEWER PIPE 18 IN. DIAM. (7-04)		
			\$	\$
			per LF	
62	90 LINEAR FOOT	CORRUGATED POLYETHYLENE STORM SEWER PIPE 12 IN. DIAM. (7-04)		
			\$	\$
			per LF	
63	25 LINEAR FOOT	CORRUGATED POLYETHYLENE STORM SEWER PIPE 8 IN. DIAM. (7-04)		
			\$	\$
			per LF	

ADDENDUM NO. 1

CITY OF FERNDALE CHERRY STREET SIDEWALK PROJECT AND PIONEER PARK SIDEWALK PROJECT

() SECTION REFERENCE

July 2, 2018

ITEM NO.	QUANTITY	DESCRIPTION	UNIT PRICE	TOTAL
64A	2 EACH	CONCRETE INLET (7-05)		
			\$	\$
			per EA	
64	3 EACH	CATCH BASIN TYPE 1 (7-05)		
			\$	\$
			per EA	
65	1 EACH	CATCH BASIN TYPE 1L (7-05)		
			\$	\$
			per EA	
66	0	THIS ITEM INTENTIONALLY LEFT BLANK		
			\$	0
			\$	-
67	3 EACH	STANDARD FRAME & SOLID LOCKING LID (7-05)		
			\$	\$
			per EA	
68	2 EACH	STANDARD FRAME & GRATE (7-05)		
			\$	\$
			per EA	
69	1 LUMP SUM	ADJUSTMENTS TO FINISHED GRADE (7-05)		
			\$	\$
			per LS	
70	1 LUMP SUM	ESC LEAD (8-01)		
			\$	\$
			per LS	
71	1 FORCE ACCOUNT	EROSION/WATER POLLUTION CONTROL (8-01)		
			\$	1,700.00
			FA	1,700.00
72	17 EACH	INLET PROTECTION (8-01)		
			\$	\$
			per EA	

ADDENDUM NO. 1

**CITY OF FERNDALE
CHERRY STREET SIDEWALK PROJECT AND PIONEER PARK SIDEWALK PROJECT**

() SECTION REFERENCE

July 2, 2018

ITEM NO.	QUANTITY	DESCRIPTION	UNIT PRICE	TOTAL
73	360 LINEAR FOOT	SILT FENCE (8-01)	\$	\$
			per LF	
74	310 SQUARE YARD	SEEDED LAWN INSTALLATION (8-02)	\$	\$
			per SY	
75	1 FORCE ACCOUNT	LANDSCAPE RESTORATION (8-02)	\$ 500.00	\$ 500.00
			FA	
76	75 LINEAR FOOT	CEMENT CONC. TRAFFIC CURB AND GUTTER (8-04)	\$	\$
			per LF	
77	60 SQUARE YARD	CEMENT CONC. DRIVEWAY ENTRANCE (8-06)	\$	\$
			per SY	
78	240 SQUARE YARD	CEMENT CONC. SIDEWALK (8-14)	\$	\$
			per SY	
79	1 EACH	CEMENT CONC. CURB RAMP TYPE SINGLE DIRECTION A (8-14)	\$	\$
			per EA	
80	1 EACH	CEMENT CONC. CURB RAMP TYPE SINGLE DIRECTION B (8-14)	\$	\$
			per EA	
81	25 LINEAR FOOT	PLASTIC STOP LINE (8-22)	\$	\$
			per LF	
82	195 SQUARE FOOT	PLASTIC CROSSWALK LINE (8-22)	\$	\$
			per SF	

ADDENDUM NO. 1**CITY OF FERNDALE
CHERRY STREET SIDEWALK PROJECT AND PIONEER PARK SIDEWALK PROJECT**

() SECTION REFERENCE

July 2, 2018

ITEM NO.	QUANTITY	DESCRIPTION	UNIT PRICE	TOTAL
83	15 LINEAR FOOT	REMOVING PLASTIC LINE (8-22)		
			\$	\$
			per LF	
84	80 SQUARE FOOT	REMOVING PLASTIC CROSSWALK LINE (8-22)		
			\$	\$
			per SF	
85	4 EACH	POTHOLE EXISTING UNDERGROUND UTILITY (8-30)		
			\$	\$
			per EA	
86	1 EST	REPAIR EXISTING PUBLIC AND PRIVATE FACILITIES (8-31)		
			\$	\$
			2,000.00	2,000.00
			EST	

Total Schedule B \$

ADDENDUM NO. 1

**CITY OF FERNDALE
CHERRY STREET SIDEWALK PROJECT AND PIONEER PARK SIDEWALK PROJECT**

() SECTION REFERENCE

July 2, 2018

ITEM NO.	QUANTITY	DESCRIPTION	UNIT PRICE	TOTAL
Schedule C				
87	1 LUMP SUM	MOBILIZATION (1-09.7)	\$	\$
			per LS	
88	1 LUMP	SPCC PLAN (1-07)	\$	\$
			per LS	
89	1 LUMP SUM	CLEARING AND GRUBBING (2-01)	\$	\$
			per LS	
90	1 LUMP SUM	REMOVAL OF STRUCTURES AND OBSTRUCTIONS (2-02)	\$	\$
			per LS	
91	32 LINEAR FOOT-INCH	SAWCUT ACP (2-02)	\$	\$
			per LF-IN	
92	150 CUBIC YARD	ROADWAY EXCAVATION INCL. HAUL (2-03)	\$	\$
			per CY	
93	10 M GAL.	WATER (2-07)	\$	\$
			per M GAL.	
94	270 TON	GRAVEL BASE (4-02)	\$	\$
			per TON	
95	1 LUMP SUM	ESC LEAD (8-01)	\$	\$
			per LS	
96	1 EST	EROSION/WATER POLLUTION CONTROL (8-01)	\$	\$
			1,000.00	1,000.00
			EST	

ADDENDUM NO. 1

**CITY OF FERNDALE
CHERRY STREET SIDEWALK PROJECT AND PIONEER PARK SIDEWALK PROJECT**

() SECTION REFERENCE

July 2, 2018

ITEM NO.	QUANTITY	DESCRIPTION	UNIT PRICE	TOTAL
97	3,000 SQUARE YARD	SEEDING, FERTILIZING, AND MULCHING – CONSTRUCTION EQUIPMENT (8-01)	\$	\$
			per SY	
98	550 SQUARE YARD	SEEDED LAWN INSTALLATION (8-02)	\$	\$
			per SY	
99	20 SQUARE YARD	STABILIZED CONSTRUCTION ENTRANCE (8-01)	\$	\$
			per SY	
100	680 SQUARE YARD	TEXTURED CEMENT CONC. SIDEWALK (8-14)	\$	\$
			per SY	
101	150 SQUARE YARD	REINFORCED TEXTURED CEMENT CONC. SIDEWALK, 8 IN. THICK (8-14)	\$	\$
			per SY	
102	50 LINEAR FOOT	CONDUIT PIPE 4 IN. DIAM. (8-20)	\$	\$
			per LF	
103	2 EACH	POTHOLE EXISTING UNDERGROUND UTILITY (8-30)	\$	\$
			per EA	
104	1 FORCE ACCOUNT	REPAIR EXISTING PUBLIC AND PRIVATE FACILITIES (8-31)	\$	\$
			3,000.00 FA	3,000.00

Total Schedule C \$

Total Schedules A, B, and C \$

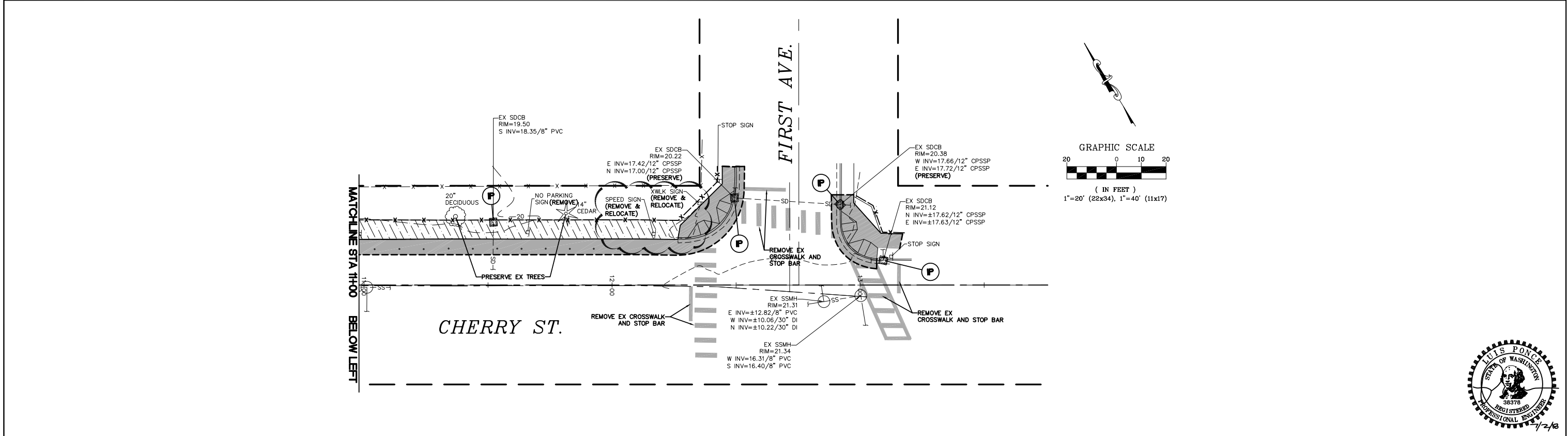
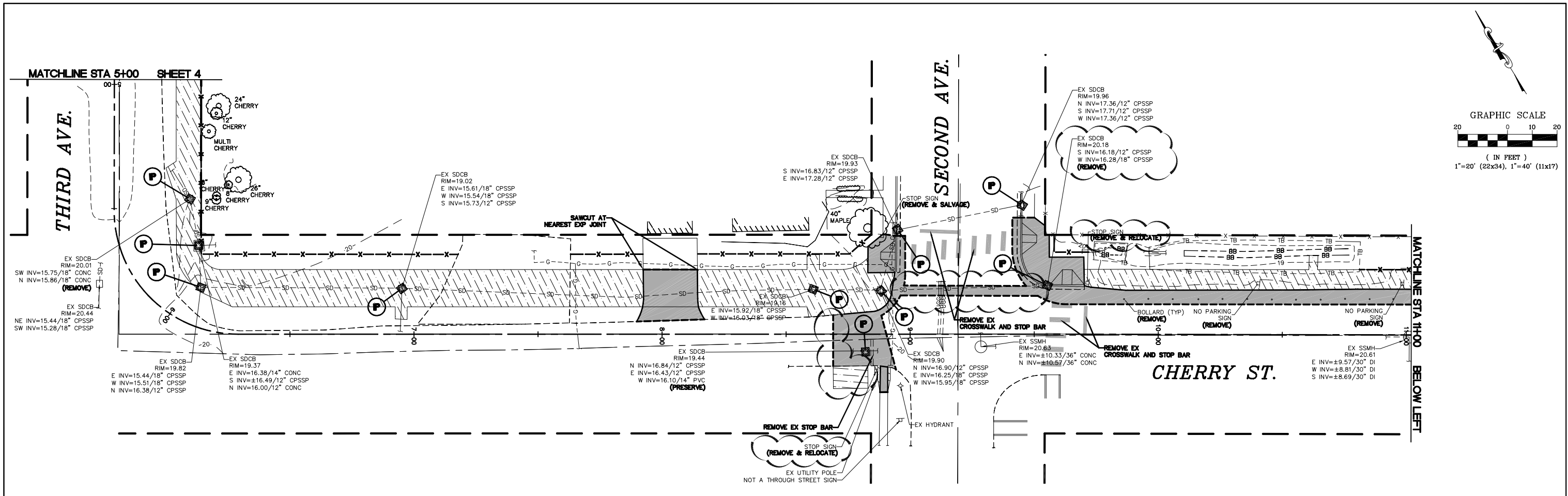

BID SET

DESIGNED BY
OAM
DRAWN BY
PJC/LMH
CHECKED BY
LP

R&E Reichhardt & Ebe
ENGINEERING INC
P.O. Box 978 | 423 Front Street, Lynden, WA 98264 (360) 354-3687
813 Metcalf Street, Sedro-Woolley, WA 98284 (360) 855-1713

NO.	DATE	DESCRIPTION	OAM BY
001	07/02/18	ADDENDUM 001 - CB REMOVAL, CLEARING & GRUBBING LIMIT CHANGE & SAWCUT LINE CHANGE, SIGN LABELS FIXED	

CITY OF FERNDAL
2095 MAIN STREET
FERNDAL, WA 98248

CHERRY STREET
FIRST TO THIRD AVENUE SIDEWALK PROJECT
SCHEDULE A AND B
EX COND, DEMO, TESC - CHERRY STREET

DWG 17009 EX COND DEMO TESC.DWG
JOB# 17009
SCALE H: 1"=20' V: NA

DATE 7/2/2018
SHEET 5 of 17

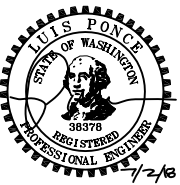
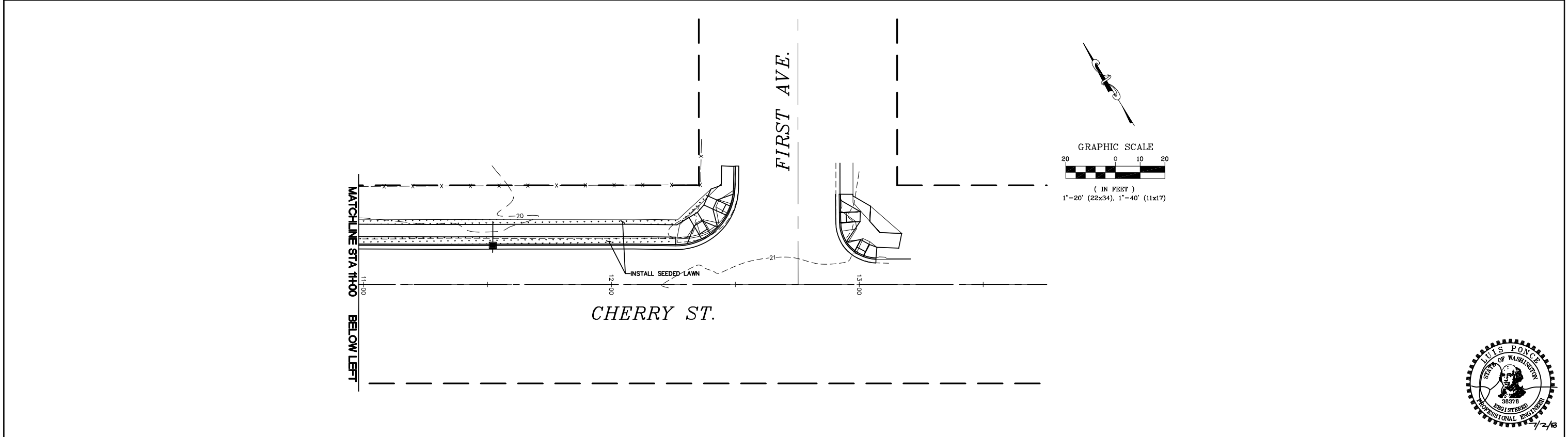
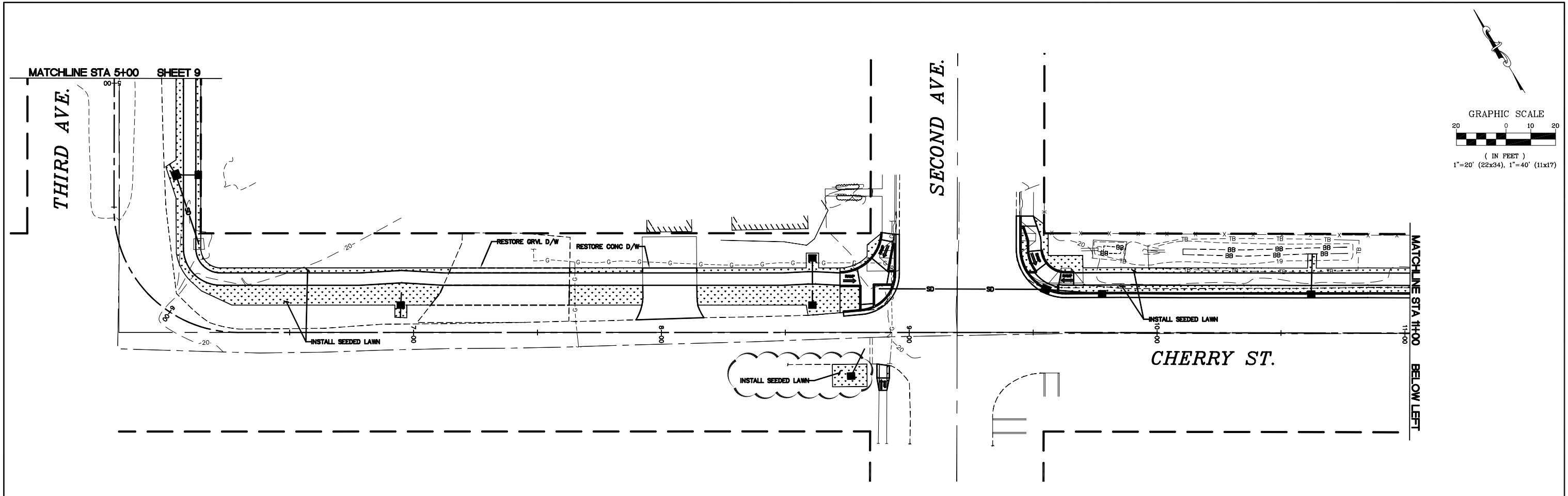

BID SET

DESIGNED BY
OAM
DRAWN BY
PJC/LMH
CHECKED BY
LP



Reichhardt & Ebe
ENGINEERING INC

P.O. Box 978 | 423 Front Street, Lynden, WA 98264 (360) 354-3687
813 Metcalf Street, Sedro-Woolley, WA 98284 (360) 855-1713

NO.	DATE	DESCRIPTION	BY
001	07/02/18	ADDENDUM 001 - SEEDED LAWN ADDITION	OAM

CITY OF FERNDALE
2095 MAIN STREET
FERNDALE, WA 98248

CHERRY STREET
FIRST TO THIRD AVENUE SIDEWALK PROJECT
SCHEDULE A AND B
RESTORATION PLAN CHERRY STREET

DWG 17009 PLAN AND PROFILE.DWG

JOB#

17009

SCALE

H: 1"=20'

V: NA

DATE 7/2/2018

SHEET

10

of 17

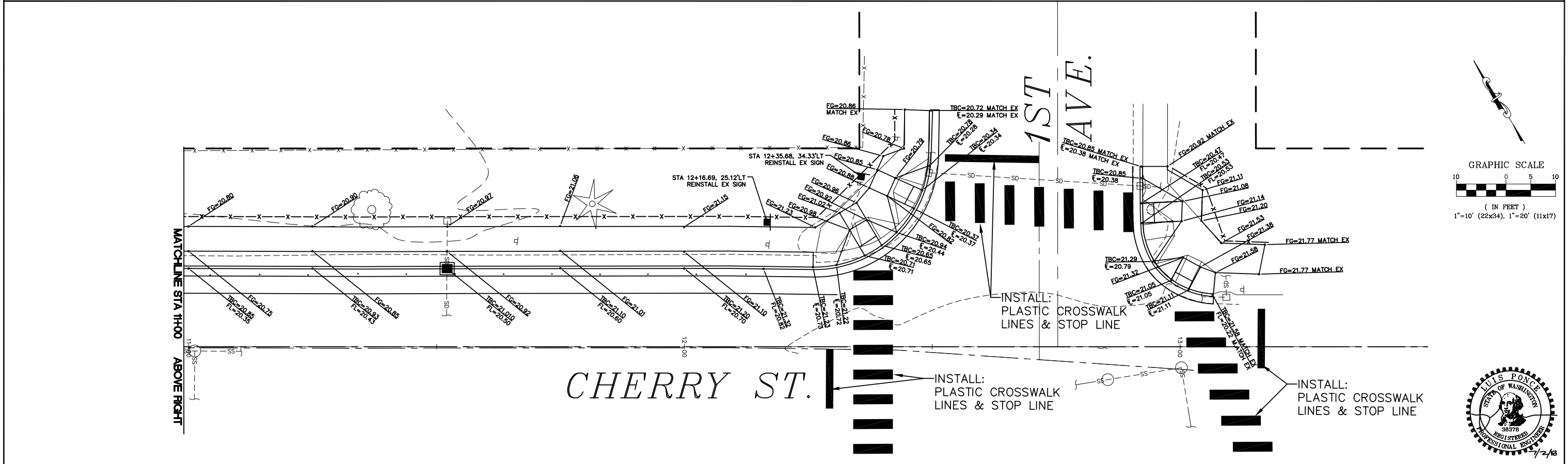
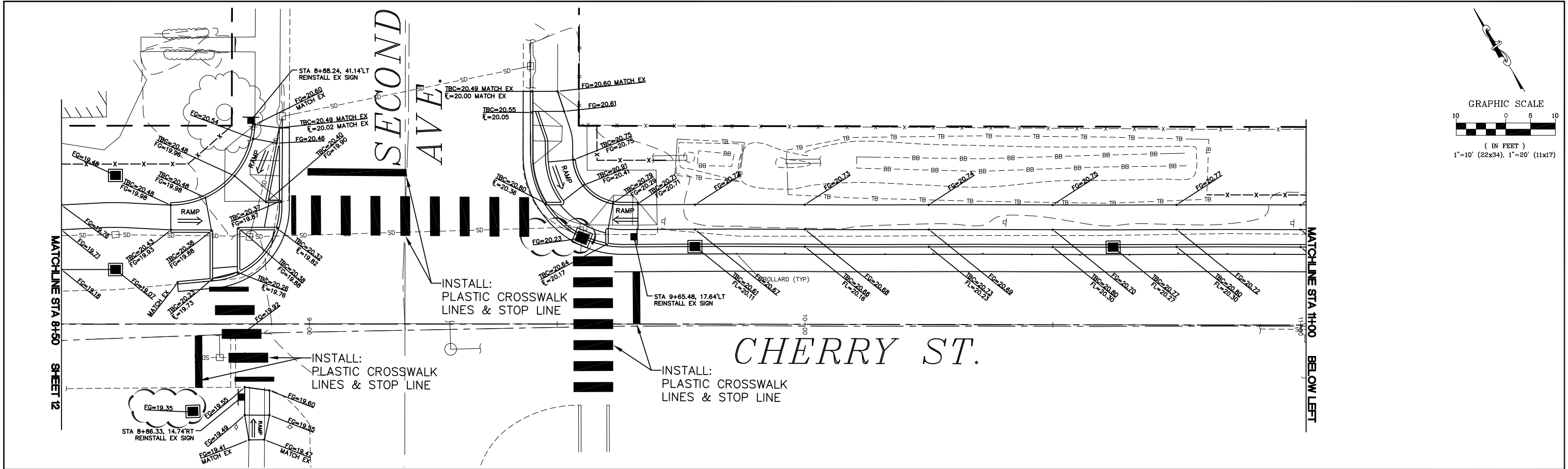

BID SET		DESIGNED BY OAM	R&E Reichhardt & Ebe ENGINEERING INC P.O. Box 978 423 Front Street, Lynden, WA 98264 (360) 354-3687 813 Metcalf Street, Sedro-Woolley, WA 98284 (360) 855-1713	001	07/02/18	ADDENDUM 001 - NEW GRADE POINTS/ELEVATIONS	OAM	BY	CITY OF FERNDAL 2095 MAIN STREET FERNDAL, WA 98248	CHERRY STREET FIRST TO THIRD AVENUE SIDEWALK PROJECT SCHEDULE A AND B GRADING + CHANNELIZATION PLAN STA 8+50 TO 13+50	DWG 17009 GRADING.DWG		DATE 7/2/2018	
		DRAWN BY PJC/LMH									JOB#	SCALE	SHEET	13
		CHECKED BY LP									17009	H: 1"=10' V: NA		
													of 17	



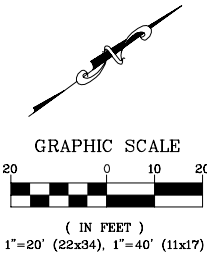
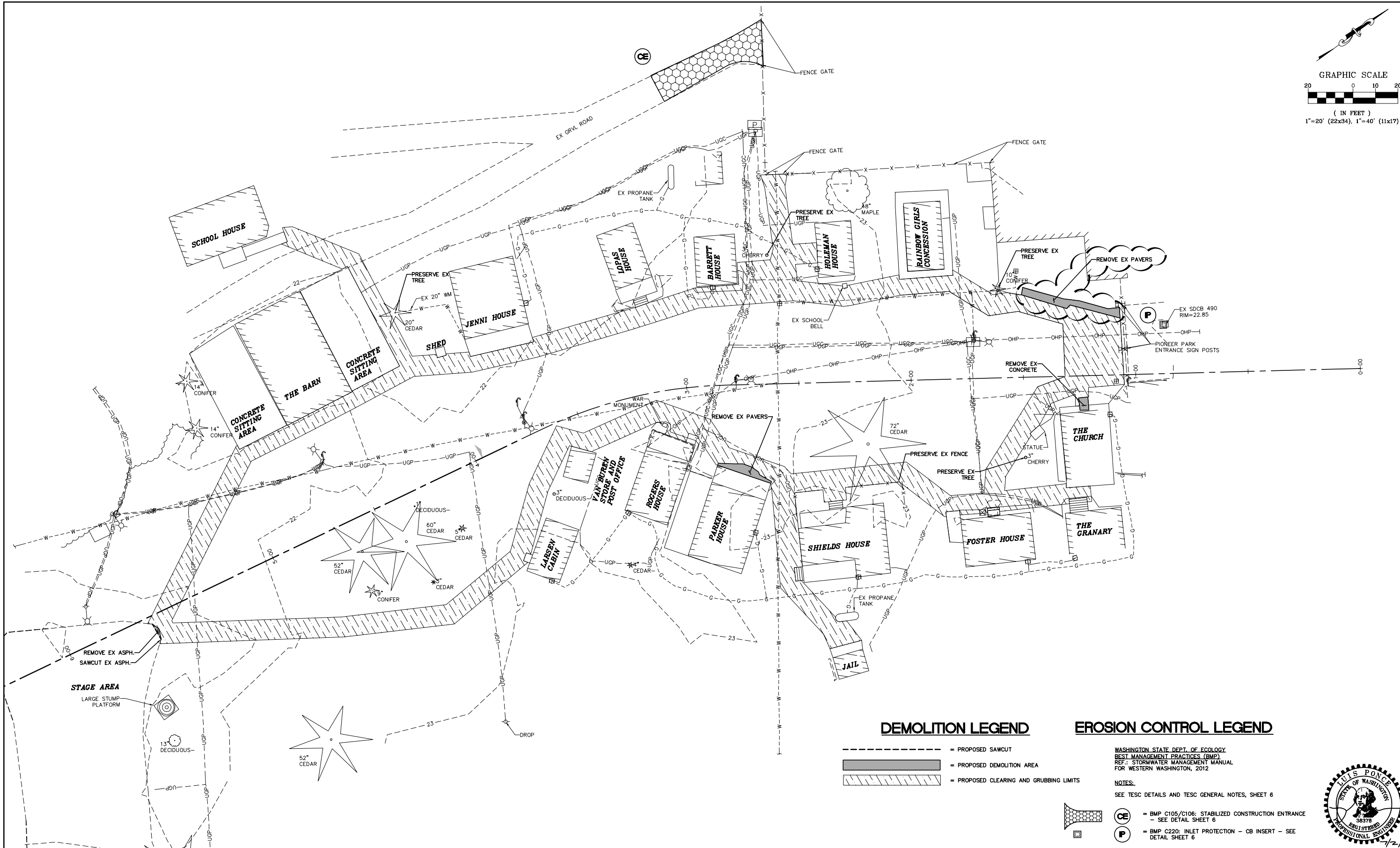

DEMOLITION LEGEND

- - - - - PROPOSED SAWCUT
- [Hatched Box] PROPOSED DEMOLITION AREA
- [Dashed Line Box] PROPOSED CLEARING AND GRUBBING LIMITS

EROSION CONTROL LEGEND

- WASHINGTON STATE DEPT. OF ECOLOGY
BEST MANAGEMENT PRACTICES (BMP)
REF.: STORMWATER MANAGEMENT MANUAL
FOR WESTERN WASHINGTON, 2012
- NOTES:
SEE TESC DETAILS AND TESC GENERAL NOTES, SHEET 6
- [CE Symbol] = BMP C105/C106: STABILIZED CONSTRUCTION ENTRANCE - SEE DETAIL SHEET 6
 - [P Symbol] = BMP C220: INLET PROTECTION - CB INSERT - SEE DETAIL SHEET 6

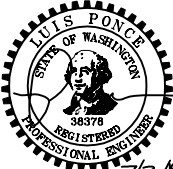

BID SET

DESIGNED BY
PJC
DRAWN BY
PJC
CHECKED BY
LP

R&E Reichhardt & Ebe
ENGINEERING INC
P.O. Box 978 | 423 Front Street, Lynden, WA 98264 (360) 354-3687
813 Metcalf Street, Sedro-Woolley, WA 98284 (360) 855-1713

NO.	DATE	DESCRIPTION	BY
1	7/02/18	ADDITIONAL DEMO REMOVE EX PAVERS	PJC

CITY OF FERNDALE
2095 MAIN ST
FERNDALE, WA 98248

PIONEER PARK
SIDEWALK PROJECT SCHEDULE C
EX COND, DEMO, TESC

DWG 18007 PROBASE
JOB# 18007

SCALE
H: 1"=20' V: NA

DATE
7/2/2018
SHEET
3 of 7

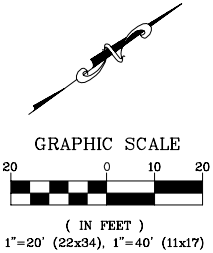
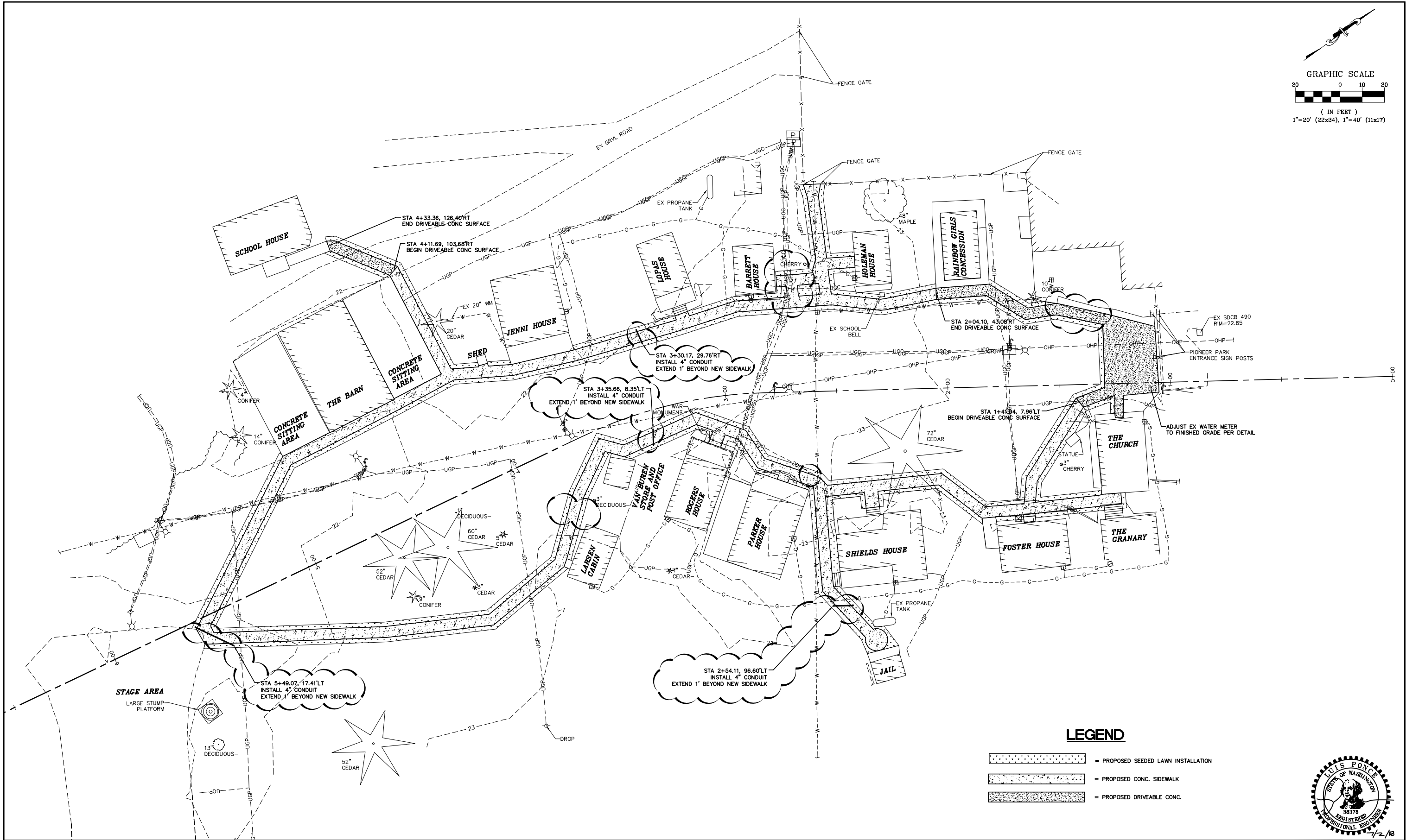

LEGEND

- [Patterned box] = PROPOSED SEEDED LAWN INSTALLATION
- [Patterned box] = PROPOSED CONC. SIDEWALK
- [Patterned box] = PROPOSED DRIVEABLE CONC.



BID SET

DESIGNED BY
PJC
DRAWN BY
PJC
CHECKED BY
LP



Reichhardt & Ebe
ENGINEERING INC
P.O. Box 978 | 423 Front Street, Lynden, WA 98264 (360) 354-3687
813 Metcalf Street, Sedro-Woolley, WA 98284 (360) 855-1713

NO.	DATE	DESCRIPTION	PJC BY
1	7/02/18	ADDED ADDITIONAL AND MOVED 4" GAS CONDUITS, RELOCATED SIDEWALK LOCATION	PJC

CITY OF FERNDAL
2095 MAIN ST
FERNDAL, WA 98248

PIONEER PARK
SIDEWALK PROJECT SCHEDULE C
SIDEWALK AND RESTORATION PLAN

DWG **18007 PROBASE**
JOB# **18007**
SCALE **H: 1"=20'** V: **NA**

DATE **7/2/2018**
SHEET **4**
of **7**