

**REICHHARDT & EBE ENGINEERING, INC.
CONSULTING ENGINEERS**

TRANSMITTAL

TO: ALL BIDDERS	FROM: Luis Ponce, P.E. 
COMPANY:	DATE: 8/05/09
FAX NUMBER:	TOTAL NO. OF PAGES INCLUDING COVER:
PHONE NUMBER:	SENDER'S PHONE NUMBER: (360) 354-3687
RE: City of Ferndale Addendum 1 Main Street Phase 2a Project Federal Aid No. STPUS - 8030(005)	SENDER'S FAX NUMBER: (360) 354-0407

ADDENDUM 1

**MAIN STREET PHASE 2a PROJECT
FEDERAL AID NO. STPUS - 8030(005)**

To the attention of all bidders for the above project:

Please find the enclosed Addendum No. 1 for the above referenced project.

The enclosed ADDENDUM is to be considered as much a part of the Contract Documents as if it were included in the body of the plans and specifications, and will be incorporated in and made a part of the contract when awarded and when formally executed.

The Bidder shall acknowledge in writing, on the bid form, this addendum in order to have the bid considered.

Luis Ponce, P.E.

423 FRONT STREET
LYNDEN, WASHINGTON 98264
360-354-3687

ADDENDUM NO. 1
To the Contract Provisions for
City of Ferndale, Washington

MAIN STREET PHASE 2a PROJECT
FEDERAL AID NO. STPUS - 8030(005)

ITEM A

The Bid Proposal Form is replaced in its entirety with the attached **REVISED BID PROPOSAL FORM**. Only bids submitted on the **REVISED BID PROPOSAL FORM** will be considered responsive.

Storm drain work has been deleted from Schedule A and placed into separate bid schedule. Deleted storm drain work items were intentionally left blank.

Bid Proposal Form, ITEM NO. 6, 'Temporary Traffic Control' has been revised to read 'Project Temporary Traffic Control'.

Bid Proposal Form, ITEM NO. 12, 'Saw-cut PCC - Trench' has been reduced as quantity required for the Storm Drain placed on separate schedule.

Bid Proposal Form, ITEM NO. 24, the quantity for 'Gravel Base' has been reduced as quantity required for the Storm Drain placed on separate bid schedule.

Bid Proposal Form, ITEM NO. 27, the quantity for 'HMA Class 1/2" PG 64-22' has been decreased.

Bid Proposal Form, ITEM NO. 28, the quantity for 'HMA Class 1" PG 64-22' has been decreased.

Bid Proposal Form, ITEM NO. 28A, 'HMA Temporary Pavement Section Class 1/2" PG 64-22' has been added to the Bid Proposal Form.

Bid Proposal Form, ITEM NO. 28B, 'HMA for Trench Section Class 1/2" PG 64-22' has been added to the Bid Proposal Form.

Bid Proposal Form, ITEM NO. 32A, 'Pedestrian Railing' for the existing wall has been added to the Bid Proposal Form.

Bid Proposal Form, ITEM NO. 58 through ITEM NO. 60, have been deleted. Deleted items were intentionally left blank.

Bid Proposal Form, ITEM NO. 72, 'Conduit Pipe 4 In. Diameter' has been revised to read 'Conduit Pipe 2 In. Diameter' and the quantity has been decreased.

Bid Proposal Form, ITEM NO. 76, 'Loop Replacement Type 3' has been revised to read 'Loop Replacement Type 3A' and the quantity has been decreased.

Bid Proposal Form, ITEM NO. 88, the quantity for 'D.I. Pipe for Water Main 6 In. Diam.' has been decreased.

Bid Proposal Form, ITEM NO. 96, the quantity for 'Connect to Existing Watermain 12 In. Diam.' has been increased.

Bid Proposal Form, 'Alternate A1 - Retaining Wall, 3-8 Feet and 2.5 Feet' has been revised to read 'Schedule D - Retaining Wall, 3-8 Feet and 2.5 Feet'.

Bid Proposal Form, 'Schedule D - Retaining Wall, 3-8 Feet and 2.5 Feet', ITEM NO. A1-8, the quantity for 'Permanent Erosion Control Blanket', has been increased

Bid Proposal Form, 'Schedule D - Retaining Wall, 3-8 Feet and 2.5 Feet', ITEM NO. A1-9, the quantity for 'Chain Link Fence Type 1 (MOD)' has been decreased.

Bid Proposal Form, 'Schedule D - Retaining Wall, 3-8 Feet and 2.5 Feet', ITEM NO. A1-11, 'Seeded Lawn Installation', has been added to the Bid Proposal Form.

Bid Proposal Form, 'Schedule D - Retaining Wall, 3-8 Feet and 2.5 Feet', ITEM NO. A1-12, 'Plant Selection English Ivy Hederahelix - 1 Gallon Container', has been added to the Bid Proposal Form.

Bid Proposal Form, 'Alternate A2 -Retaining Wall, 8 Feet and 4.5 Feet' has been deleted.

ITEM 1

Plan Sheet 9

The attached Plan Sheet 9 shall replace the Plan Sheet 9 dated 7-21-10. Watermain is relocated.

ITEM 2

Plan Sheet 10

The "(Connect to existing service lines)" called out in the water service callout at station 37+96.0, 28.8'R shall be deleted.

ITEM 3

Plan Sheet 13

The attached Plan Sheet 13 shall replace the Plan Sheet 13 dated 7-21-10. Watermain is relocated.

ITEM 4

Plan Sheet 14

The attached Plan Sheet 14 shall replace the Plan Sheet 14 dated 7-21-10. Watermain is relocated.

ITEM 5

Plan Sheet 15

The attached Plan Sheet 15 shall replace the Plan Sheet 15 dated 7-21-10. Fence and typical wall call out are revised.

ITEM 6

Plan Sheet 16

The attached Plan Sheet 16 shall replace the Plan Sheet 16 dated 7-21-10. Typical sections are revised.

ITEM 7

Plan Sheet 17 and Plan Sheet 18

These Plan Sheets are deleted.

ITEM 8

Plan Sheet 23

The attached Plan Sheet 23 shall replace the Plan Sheet 23 dated 7-21-10. Grades added due to relocated watermain.

ITEM 9

Plan Sheet 30

The "Sewer Service Stake" detail shall specify a maximum top of stake height of one foot above the proposed ground elevation at the stake.

ITEM 10

Plan Sheet 31

The “City of Ferndale Typical Water Service (3/4” to 2”)” detail dimension of 12” – 20” from ground surface to top of setter shall be changed to 18”-20”. The 3/4” curb stop location shown in the detail shall be revised to show the curb stop within the meter box.

ITEM 11

Plan Sheet 33

The “Watermeter Location Detail” shall specify a distance for the water meter from the property line to the meter box of one foot. If the proposed back of sidewalk abuts the property line the water meter box shall be located at the back of sidewalk within the right of way.

ITEM 12

Plan Sheet 37 and Plan Sheet 38

The noted lane closure hours are deleted.

ITEM 13

Plan Sheet 37 and Plan Sheet 38

Note 5, which reads ‘APPLICABLE AT SR-544 AND HANNEGAN ROAD’ is deleted.

ITEM 14

Plan Sheet 39

The “Sweet Gum Tree (Liquidamber Styraciflua)”, “Callery (Bradford) Flowering Pear Tree”, and “Callery Flowering Pear Tree with Planter” called out on the Plan Sheet shall not be installed.

ITEM 15

Plan Sheet 40 and Plan Sheet 41

These Plan Sheets are deleted.

ITEM 16

The attached Plans Sheet 42 and 43 are added to the Contract Documents.

ITEM 17

DIVISION 1

INTRODUCTION TO THE SPECIAL PROVISIONS

Page 95, line 6 is revised to read:

for Road, Bridge and Municipal Construction, 2010 edition, as issued by the Washington State

ITEM 18

DIVISION 1

GENERAL REQUIREMENTS

1-02 BID PROCEDURES AND CONDITIONS

1-02.6 Preparation of Proposal

Page 101, lines 16-45 and Page 102, lines 1-8 are deleted and replaced with the following:

ITEM 19

DIVISION 1

GENERAL REQUIREMENTS

1-03 BID PROCEDURES AND CONDITIONS

1-05.3 Plans and Working Drawings

Page 107, lines 36-44 and Page 108, lines 1-2 are deleted.

ITEM 20

DIVISION 2

EARTHWORK

2-02.4 Measurement

Page 163, lines 4-5 are deleted and revised to read:

Saw-cut PCC will be measured by the linear foot-inch along the line and slope of the cut prior to sawcutting and as staked by the Engineer.

Saw-cut PCC Trench will be measured by the linear foot-inch along the line and slope of the cut in the utility trenches prior to sawcutting and as staked by the Engineer.

ITEM 21

DIVISION 5

SURFACE TREATMENT AND PAVEMENTS

5-04.4 Measurement

Section 5-04.54 is supplemented with the following:

HMA for Temporary Pavement Section Class 1/2" PG 64-22, and HMA for Trench Section Class 1/2" PG 64-22 will be measured by the ton in accordance with 1-09.2.

Addendum 1, Page 5 of 9

Main Street Phase 2a Project

P:\Projects\08018\Construction\Addendum\Addendum1.doc

ITEM 22
DIVISION 5
SURFACE TREATMENT AND PAVEMENTS

5-04.5 Payment

Section 5-04.5 is supplemented with the following:

HMA for Temporary Pavement Section Class 1/2" PG 64-22, per ton.

HMA for Trench Section Class 1/2" PG 64-22, per ton.

ITEM 23

DIVISION 7
DRAINAGE STRUCTURES, STORM SEWERS, SANITARY SEWERS, WATER MAINS,
AND CONDUITS

7-05.3 Construction Requirements

Page 180, line 20 is revised to read:

system at a sanitary sewer manhole located at the intersection of 2nd and Maple.

ITEM 24

DIVISION 7
DRAINAGE STRUCTURES, STORM SEWERS, SANITARY SEWERS, WATER MAINS,
AND CONDUITS

7-09.3(19)A Connections to Existing Mains

Page 190, line 43 is revised to read:

the pipe over or under existing or new pipe or other utilities and all other work and materials

ITEM 25

DIVISION 7
DRAINAGE STRUCTURES, STORM SEWERS, SANITARY SEWERS, WATER MAINS,
AND CONDUITS

7-14.2 Materials

Page 194, line 8 is revised to read:

The City of Ferndale Standard Fire Hydrants are "M&H model 929". The pumper

ITEM 26

**DIVISION 7
DRAINAGE STRUCTURES, STORM SEWERS, SANITARY SEWERS, WATER MAINS,
AND CONDUITS**

7-15.5 Materials

Page 196, line 31 is revised to read:

work to install the meter boxes, meter setter, service connection, including but not limited

ITEM 27

**DIVISION 8
MISCELLANEOUS CONSTRUCTION**

8-02.2 Materials

Page 200, lines 14-19 are deleted.

ITEM 28

**DIVISION 8
MISCELLANEOUS CONSTRUCTION**

8-02.2 Materials

Page 201, lines 4-7 are deleted.

ITEM 29

**DIVISION 8
MISCELLANEOUS CONSTRUCTION**

8-02.3 Construction Requirements

Page 201, lines 13-17 are deleted.

ITEM 30

**DIVISION 8
MISCELLANEOUS CONSTRUCTION**

8-02.3 Construction Requirements

Section 8-02.3 is supplemented with the following:

Plants shall be installed at a spacing of 2 feet on center. The area to be planted is approximately 520 square feet with 1:1 grades. All plants shall be properly protected against harm from wind, unusual weather, and the public. The Contractor shall perform all necessary maintenance including watering, pruning, and spraying trees during the contract period.

ITEM 31

**DIVISION 8
MISCELLANEOUS CONSTRUCTION**

8-02.4 Measurement

Page 202, line 46 is deleted.

ITEM 32

**DIVISION 8
MISCELLANEOUS CONSTRUCTION**

8-02.4 Measurement

Section 8-02.4 is supplemented with the following:

No separate measurement will be made for Topsoil Type A, Medium Bark, water and fertilizer, and binding agent, where applied for “Plant Selection English Ivy, Hederahelix – 1 Gallon Container.”

ITEM 33

**DIVISION 8
MISCELLANEOUS CONSTRUCTION**

8-02.5 Payment

Page 203, lines 24-31 are deleted.

ITEM 34

**DIVISION 8
MISCELLANEOUS CONSTRUCTION**

8-02.5 Payment

Section 8-02.5 is supplemented with the following:

“Plant Selection English Ivy, Hederahelix – 1 Gallon Container” per each. This item shall include all labor tools equipment and materials (topsoil type A, medium bark, fertilizer, mulch, soil amendments, and water), necessary to excavate and prepare plant pits, plant, fertilize, and water the plant selection as indicated in the contract documents.

ITEM 35

The attached PSE/Potelco and PSE/Intolight Plan Sheets are added to the Contract Documents.

ITEM 36

The attached Frontier Handhole Schedule and Handhole detail is added to the Contract Documents.

POINT OF CLARIFICATION

The vacant City owned property, located between approximately STA 47+00 RT to STA 50+00 RT is not available for use by the Contractor as other work is scheduled for this area.

The following items shall be incidental to the Bid Item "Removal of Structures and Obstructions".

<u>STATION/OFFSET</u>	<u>OBSTRUCTION</u>
44+98, 25'R +/-	ROCK WALL
45+36, 48.5'L +/-	STEPS
46+64, 19'L +/-	FIR TREES
46+67, 35'L to 46+70, 30'L +/-	ROCK WALL

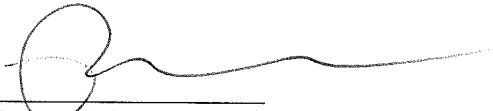

Luis Ponce, P.E.
Project Manager

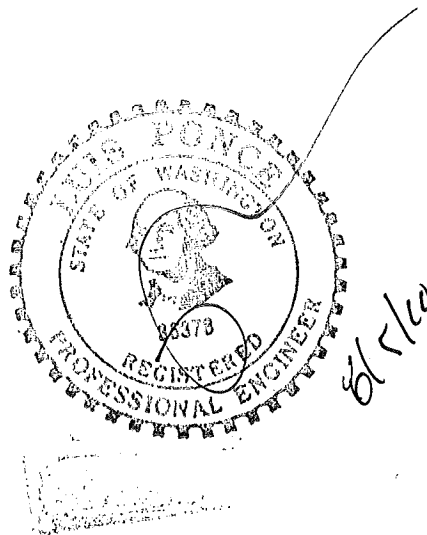

BID PROPOSAL FORM

Main Street Phase 2a Project
 Ferndale, Washington 98248

ITEM NO.	APPROX. QUANTITY	ITEM	UNIT PRICE	TOTAL
Schedule A - Civil Items				
1	1 LS	Mobilization 1-09		\$
			LS	
2	1 FA	Minor Changes 1-04		\$ 40,000.00
			FA	
3	1 LS	SPCC Plan 1-07		\$
			LS	
4	3,000 HR	Flaggers and Spotters 1-10	\$	\$
			per HR	
5	450 HR	Other Traffic Control Labor 1-10	\$	\$
			per HR	
6	1 LS	Project Temporary Traffic Control 1-10		\$
			LS	
7	1 LS	Clearing and Grubbing 2-01		\$
			LS	
8	1 LS	Removal of Structures and Obstructions 2-02		\$
			LS	
9	26 EA	Removing Drainage Structures 2-02	\$	\$
			per EA	
10	50,000 LF-IN	Saw-cut ACP 2-02	\$	\$
			per LF-IN	

BID PROPOSAL FORMMain Street Phase 2a Project
Ferndale, Washington 98248

ITEM NO.	APPROX. QUANTITY	ITEM	UNIT PRICE	TOTAL
11	1,500 LF-IN	Saw-cut PCC 2-02	\$ per LF-IN	\$
12	1,700 LF-IN	Saw-cut PCC - Trench 2-02	\$ per LF-IN	\$
13	1 FA	Hazardous Material Handling And Disposal 2-02	FA	\$ 30,000.00
14	500 CY	Hazardous Material Excavation Incl. Haul 2-02	\$ per CY	\$
15	0 0	This Item Intentionally Left Blank		\$0.00
16	4500 CY	Roadway Excavation Including Haul 2-03	\$ per CY	\$
17	300 CY	Unsuitable Foundation Excavation Including Haul 2-03	\$ per CY	\$
18	250 CY	Embankment Compaction 2-03	\$ per CY	\$
19	100 MGal	Water 2-07	\$ per MGal	\$
20	3,100 CY	Structure Excavation Class B Including Haul 2-09	\$ per CY	\$
21	18,000 SF	Shoring or Extra Excavation Class B Including Haul 2-09	\$ per SF	\$

BID PROPOSAL FORMMain Street Phase 2a Project
Ferndale, Washington 98248

ITEM NO.	APPROX. QUANTITY	ITEM	UNIT PRICE	TOTAL
22	8,000 SY	Construction Geotextile for Separation 2-12	\$ per SY	\$
23	1,500 SY	Construction Geotextile, Tack 2-12	\$ per SY	\$
24	11,150 Ton	Gravel Base 4-02	\$ per Ton	\$
25	400 Ton	Crushed Surfacing Top Course 4-04	\$ per Ton	\$
26	350 Ton	HMA for Preleveling Class 1/2" PG 64-22 5-04	\$ per Ton	\$
27	2,900 Ton	HMA Class 1/2" PG 64-22 5-04	\$ per Ton	\$
28	1,900 Ton	HMA Class 1" PG 64-22 5-04	\$ per Ton	\$
28A	200 Ton	HMA for Temporary Pavement Section Class 1/2" PG 64-22 0	\$ per Ton	\$
28B	250 Ton	HMA for Trench Section Class 1/2" PG 64-22 0	\$ per Ton	\$
29	8,200 SY	Planing Bituminous Pavement 5-04	\$ per SY	\$

BID PROPOSAL FORM
 Main Street Phase 2a Project
 Ferndale, Washington 98248

ITEM NO.	APPROX. QUANTITY	ITEM	UNIT PRICE	TOTAL
30	1 Calc	Job Mix Compliance Price Adjustment 5-04		\$ 20,000.00
			Calc	
31	1 Calc	Compaction Price Adjustment 5-04		\$
			Calc	
32	1 Calc.	Asphalt Cost Price Adjustment 5-04		\$
			Calc.	
32A	115 LF	Pedestrian Railing 6-06	\$ per LF	\$
33-48	0 0	These Items Intentionally Left Blank		\$0.00
49	1 LS	Adjustments to Finish Grades 7-05		\$
			LS	
50	0 0	This Item Intentionally Left Blank		0
51	1 LS	ESC Lead 8-01	\$ per LS	\$
52	45 EA	Inlet Protection 8-01	\$ per EA	\$
53	300 SY	Permanent Erosion Control Blanket 8-01	\$ per SY	\$

BID PROPOSAL FORMMain Street Phase 2a Project
Ferndale, Washington 98248

ITEM NO.	APPROX. QUANTITY	ITEM	UNIT PRICE	TOTAL
54	200 SY	Stabilized Construction Entrance 8-01	\$ per SY	\$
55	1,200 LF	Silt Fence 8-01	\$ per LF	\$
56	1,000 SY	Seeded Lawn Installation 8-02	\$ per SY	\$
57	1 FA	Landscaping Restoration 8-02	FA	\$ 15,000.00
58-60	12 EA	These Items Intentionally Left Blank 8-02	\$ per EA	\$
61	4,500 LF	Cement Concrete Curb & Gutter 8-04	\$ per LF	\$
62	325 LF	Cement Concrete Pedestrian Curb 8-04	\$ per LF	\$
63	350 LF	Painted Yellow Curb 8-04	\$ per LF	\$
64	420 SY	Cement Concrete Driveway 8-06	\$ per SY	\$
65	18.65 HUND	Raised Pavement Markers, Type 1 8-09	\$ per HUND	\$

BID PROPOSAL FORM
 Main Street Phase 2a Project
 Ferndale, Washington 98248

ITEM NO.	APPROX. QUANTITY	ITEM	UNIT PRICE	TOTAL
66	3.7 HUND	Raised Pavement Markers, Type 2 8-09	\$	\$
			per HUND	
67	2,500 SY	Cement Concrete Sidewalk 8-14	\$	\$
			per SY	
68	16 EA	Cement Conc. Curb Ramp Type Parallel A 8-14	\$	\$
			per EA	
69	0 0	This Item Intentionally Left Blank		\$0.00
70	2 EA	Mailbox Support, Type 1 8-18	\$	\$
			per EA	
71	2 EA	Mailbox Support, Type 2 8-18	\$	\$
			per EA	
72	2,700 LF	Conduit Pipe 2 In. Diameter 8-20	\$	\$
			per LF	
73	1 LS	Underground Electrical System Conversion 8-20		\$
			LS	
74	30 EA	Street Light Foundation 8-20	\$	\$
			per EA	
75	1 FA	Force Account Residential Overhead Service to Underground Service 8-20		\$ 60,000.00
			FA	

BID PROPOSAL FORM
 Main Street Phase 2a Project
 Ferndale, Washington 98248

ITEM NO.	APPROX. QUANTITY	ITEM	UNIT PRICE	TOTAL
76	5 EA	Loop Replacement Type 3A 8-20	\$ per EA	\$
77	1 LS	Permanent Signs 8-21	LS	\$
78	22 EA	Plastic Traffic Arrow 8-22	\$ per EA	\$
79	5,161 LF	Paint Line 8-22	\$ per LF	\$
80	220 LF	Plastic Stop Line 8-22	\$ per LF	\$
81	1,500 SF	Plastic Crosswalk Stripe 8-22	\$ per SF	\$
82	25 EA	Pothole Existing Underground Utility 8-30	\$ per EA	\$
83	1 FA	Repair Existing Public and Private Facilities 8-31	FA	\$ 40,000.00
Total Schedule A			\$	

BID PROPOSAL FORMMain Street Phase 2a Project
Ferndale, Washington 98248

ITEM NO.	APPROX. QUANTITY	ITEM	UNIT PRICE	TOTAL
Schedule B - Water Main Work				
84	20,000 LF-IN	Saw-cut ACP 2-02	\$ per LF-IN	\$
85	8,000 LF-IN	Saw-cut PCC Trench 2-02	\$ per LF-IN	\$
86	1,800 TON	Gravel Base 4-02	\$ per TON	\$
87	15 LF	D.I. Pipe for Water Main 4 In. Diam. 7-09	\$ per LF	\$
88	70 LF	D.I. Pipe for Water Main 6 In. Diam. 7-09	\$ per LF	\$
89	525 LF	D.I. Pipe for Water Main 8 In. Diam. 7-09	\$ per LF	\$
90	1,200 LF	D.I. Pipe for Water Main 12 In. Diam. 7-09	\$ per LF	\$
91	2 EA	Stovepipe Watermain, 8 In. Diam. 7-09	\$ per EA	\$
92	3 EA	Stovepipe Watermain, 12 In. Diam. 7-09	\$ per EA	\$
93	1 EA	Connect to Existing Watermain 4 In. Diam. 7-09	\$ per EA	\$

BID PROPOSAL FORM
Main Street Phase 2a Project
Ferndale, Washington 98248

ITEM NO.	APPROX. QUANTITY	ITEM	UNIT PRICE	TOTAL
94	2 EA	Connect to Existing Watermain 6 In. Diam. 7-09	\$	\$
			per EA	
95	4 EA	Connect to Existing Watermain 8 In. Diam. 7-09	\$	\$
			per EA	
96	6 EA	Connect to Existing Watermain 12 In. Diam. 7-09	\$	\$
			per EA	
97	1 EA	Blow off Assembly 7-09	\$	\$
			per EA	
98	200 LF	PVC C905 Casing 7-09	\$	\$
			per LF	
99	1 LS	Testing Water Main 7-09		\$
			LS	
100	1 EA	Gate Valve, 4 In. 7-12	\$	\$
			per EA	
101	7 EA	Gate Valve, 8 In. 7-12	\$	\$
			per EA	
102	8 EA	Gate Valve, 12 In. 7-12	\$	\$
			per EA	
103	1 EA	Tapping Sleeve and Gate Valve Assembly, 12"x6" 7-12	\$	\$
			per EA	

BID PROPOSAL FORM
 Main Street Phase 2a Project
 Ferndale, Washington 98248

ITEM NO.	APPROX. QUANTITY	ITEM	UNIT PRICE	TOTAL
104	4 EA	Tapping Sleeve and Gate Valve Assembly, 12"x8" 7-12	\$ _____ per EA	\$ _____
105	8 EA	Hydrant Assembly 7-14	\$ _____ per EA	\$ _____
106	26 EA	Service Connection 1 In. Diam. 7-15	\$ _____ per EA	\$ _____
107	4 EA	Service Connection 2 In. Diam. 7-15	\$ _____ per EA	\$ _____
Total Schedule B			\$ _____	
Sales Tax @ 8.5% (Schedule B)			\$ _____	
Total Schedule B			\$ _____	

BID PROPOSAL FORM
 Main Street Phase 2a Project
 Ferndale, Washington 98248

ITEM NO.	APPROX. QUANTITY	ITEM	UNIT PRICE	TOTAL
Schedule C - Sanitary Work				
108	1,700 LF-IN	Saw-cut ACP 2-02	\$ _____ per LF-IN	\$ _____
109	1,000 LF-IN	Saw-cut PCC Trench 2-02	\$ _____ per LF-IN	\$ _____
110	100 TON	Gravel Base 4-02	\$ _____ per TON	\$ _____
111	1 EA	Manhole 48 In. Diam. Type 3 7-05	\$ _____ per EA	\$ _____
112	15 EA	Solid Locking Ring and Cover 7-05	\$ _____ per EA	\$ _____
113	1 EA	Connection to Existing Manhole 7-05	\$ _____ per EA	\$ _____
114	260 LF	PVC Sanitary Sewer Pipe 8 In. Diam. 7-17	\$ _____ per LF	\$ _____
115	20 LF	PVC Sanitary Sewer Pipe 12 In. Diam. 7-17	\$ _____ per LF	\$ _____
116	270 LF	Testing Sewer Pipe 7-17	\$ _____ per LF	\$ _____
Total Schedule C			\$ _____	
Sales Tax @ 8.5% (Schedule C)			\$ _____	
TOTAL Schedule C			\$ _____	

BID PROPOSAL FORMMain Street Phase 2a Project
Ferndale, Washington 98248

ITEM NO.	APPROX. QUANTITY	ITEM	UNIT PRICE	TOTAL
Schedule D - Retaining Wall, 3-8 Feet and 2.5 Feet				
A1-1	275 CY	Structure Excavation Class A Including Haul 2-09	\$ per CY	\$
A1-2	1 LS	Shoring or Extra Excavation Class A 2-09	LS	\$
A1-3	1,370 SF	Retaining Wall 6-02	\$ per SF	\$
A1-4	600 TON	Gravel Backfill for Wall 6-02	\$ per TON	\$
A1-5	100 LF	Pedestrian Railing 6-06	\$ per LF	\$
A1-6	300 LF	Underdrain Pipe, 4 In. Diam. 7-01	\$ per LF	\$
A1-7	31 LF	Solid Wall PVC Storm Sewer Pipe, 6 In. Diam. 7-04	\$ per LF	\$
A1-8	100 SY	Permanent Erosion Control Blanket 8-01	\$ per SY	\$
A1-9	170 LF	Chain Link Fence Type 1 (MOD) 8-12	\$ per LF	\$
A1-10	100 TON	Quarry Spalls 8-15	\$ per TON	\$

BID PROPOSAL FORM
 Main Street Phase 2a Project
 Ferndale, Washington 98248

ITEM NO.	APPROX. QUANTITY	ITEM	UNIT PRICE	TOTAL
A1-11	200 SY	Seeded Lawn Installation 8-02	\$ per SY	\$
A1-12	120 EA	Plant Selection English Ivy Hederahelix - 1 Gallon Container 8-02	\$ per EA	\$
Total Schedule D			\$	

BID PROPOSAL FORMMain Street Phase 2a Project
Ferndale, Washington 98248

ITEM NO.	APPROX. QUANTITY	ITEM	UNIT PRICE	TOTAL
Schedule E - Storm Drain Work				
117	3,400 LF-IN	Saw-cut PCC - Trench 2-02	\$	\$
			per LF-IN	
118	250 CY	Removing Portland Cement Concrete Pavement 2-02	\$	\$
			per CY	
119	1,200 Ton	Gravel Base 4-02	\$	\$
			per Ton	
120	15 LF	Corrugated Poly Storm Sewer Pipe 6 In. Diam. 7-04	\$	\$
			per LF	
121	45 LF	Corrugated Poly Storm Sewer Pipe 8 In. Diam. 7-04	\$	\$
			per LF	
122	900 LF	Corrugated Poly Storm Sewer Pipe 12 In. Diam. 7-04	\$	\$
			per LF	
123	970 LF	Corrugated Poly Storm Sewer Pipe 18 In. Diam. 7-04	\$	\$
			per LF	
124	20 LF	Corrugated Poly Storm Sewer Pipe 24 In. Diam. 7-04	\$	\$
			per LF	
125	75 LF	Corrugated Poly Storm Sewer Pipe 48 In. Diam. 7-04	\$	\$
			per LF	
126	70 LF	Ductile Iron Storm Sewer Pipe 8 In. Diam. 7-04	\$	\$
			per LF	
127	350 LF	Ductile Iron Storm Sewer Pipe 12 In. Diam. 7-04	\$	\$
			per LF	

BID PROPOSAL FORM
Main Street Phase 2a Project
Ferndale, Washington 98248

ITEM NO.	APPROX. QUANTITY	ITEM	UNIT PRICE	TOTAL
128	2,000 LF	Testing Storm Sewer Pipe 7-04	\$ per LF	\$
129	2 EA	Concrete Inlet 7-05	\$ per EA	\$
130	2 EA	Catch Basin Type 2, 48 In. Diam. 7-05	\$ per EA	\$
131	1 EA	Catch Basin Type 2, 54 In. Diam. 7-05	\$ per EA	\$
132	1 EA	Catch Basin Type 2, 60 In. Diam 7-05	\$ per EA	\$
133	7 EA	Catch Basin Type 1L 7-05	\$ per EA	\$
134	24 EA	Catch Basin Type 1 7-05	\$ per EA	
135	5 EA	Connect to Existing Roof Drain 7-05	\$ per EA	\$
136	150 CY	Removal of Unsuitable Material Including Haul 7-08	\$ per CY	
137	250 TON	Quarry Spalls 8-15	\$ per TON	\$
Total Schedule E			\$	_____
TOTAL BID (INCLUDING TAX)			\$	_____

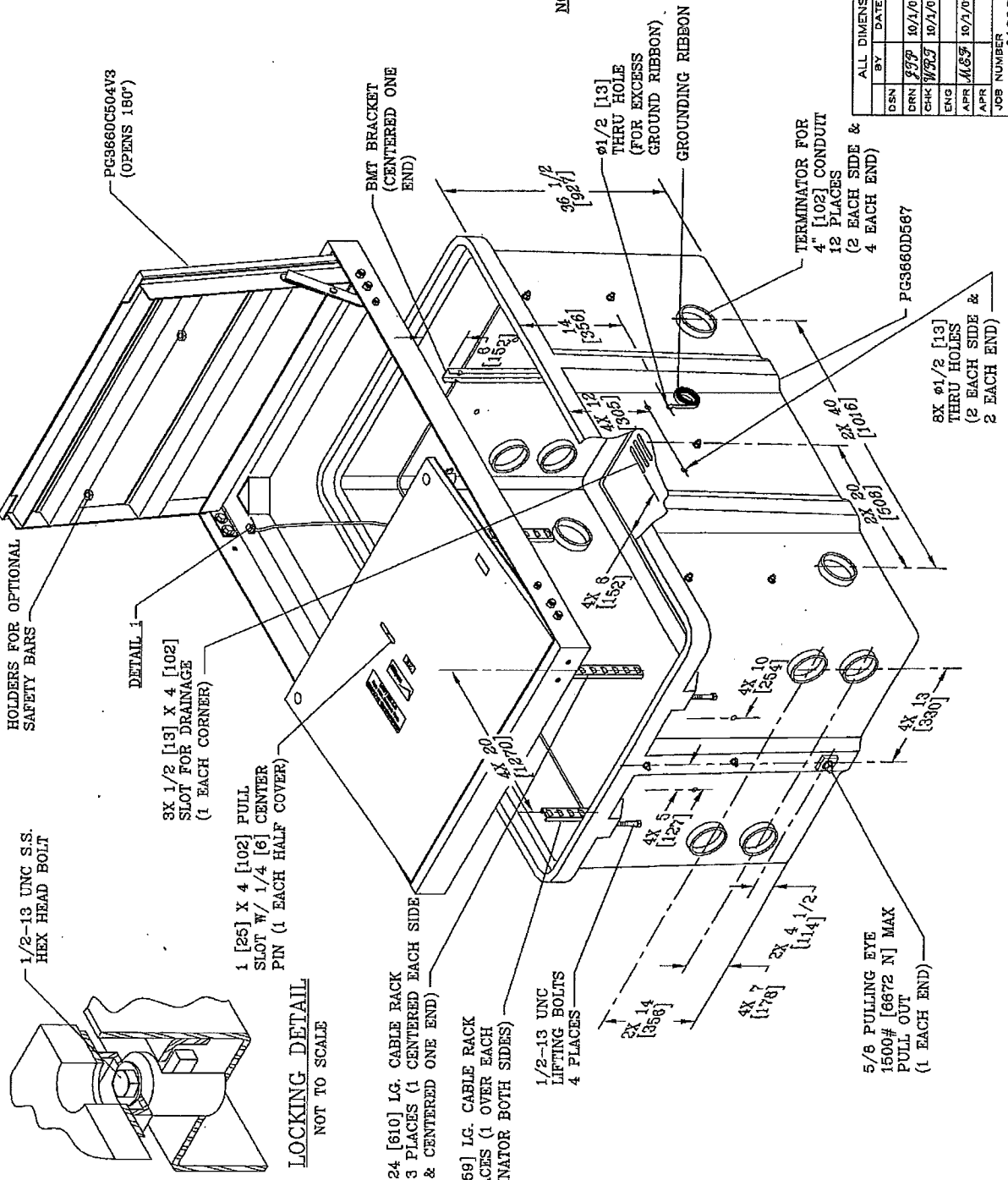
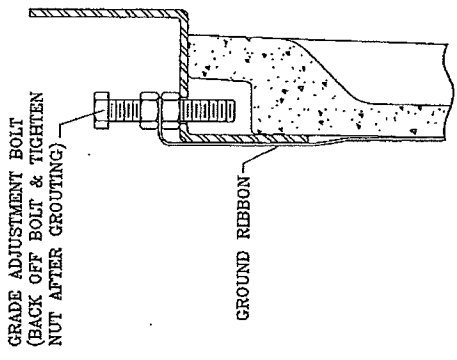

NOTES:

1. CUSTOMER IS VERIZON LOGO TO BE SPECIFIED:
2. THIS ASSEMBLY IS RATED FOR A STATIC DESIGN LOAD OF 10,400 LBS. [46,259 N] OVER A 10 [254] X 20 [508] AREA AND MUST PASS A MINIMUM STATIC TEST LOAD OF 20,800 LBS. [92,518 N] IN ACCORDANCE WITH TELECORDIA DOCUMENT TR-TSY-000902.
3. DIMENSIONS IN BRACKETS ARE IN MILLIMETERS UNLESS NOTED OTHERWISE.
4. THIS ENCLOSURE IS RECOMMENDED FOR 900 PAIR CABLES OR LESS.

STRONGWELL		LOG
EQ	12775#	EQ
S	578kg	S
REV	SCALE	REV
K	1'-1"	K
8/04	SIZE	8/04
	B	
DRAWING TITLE		DRAWING NUMBER
QUAZITE® BOX & COVER ASSEMBLY		PC36602587V3
CFN	SHEET 1 OF 1	
JOB NUMBER	01682	

HANDLE - 36x60x36
 20K RATING - BOX & TORSION ASSIST COVER

REPLACEMENT COVER - 36x60x4 3/8
 20K RATING - TORSION ASSIST COVER

SSI# (VERIZON EAST) - 700251280
 ITEM ID (VERIZON WEST) - 911697

SSI# (VERIZON EAST) - 700253055
 ITEM ID (VERIZON WEST) - 924077

1.17

07/01/04

ORDER OF WORK

- ① CONSTRUCT FOUNDATION TO BOTTOM OF SIDEWALK ELEVATION, ROUGHEN SURFACE
- ② CONSTRUCT SIDEWALK OVER FOUNDATION, BLOCK OUT AROUND FOUNDATION AS SHOWN

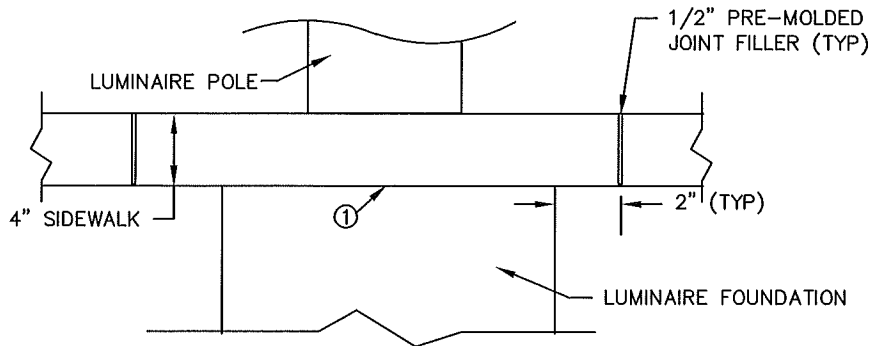

LUMINAIRE FOUNDATION AT SIDEWALK

NOTE: LUMINAIRE FOUNDATION DETAILS NOT SHOWN FOR CLARITY

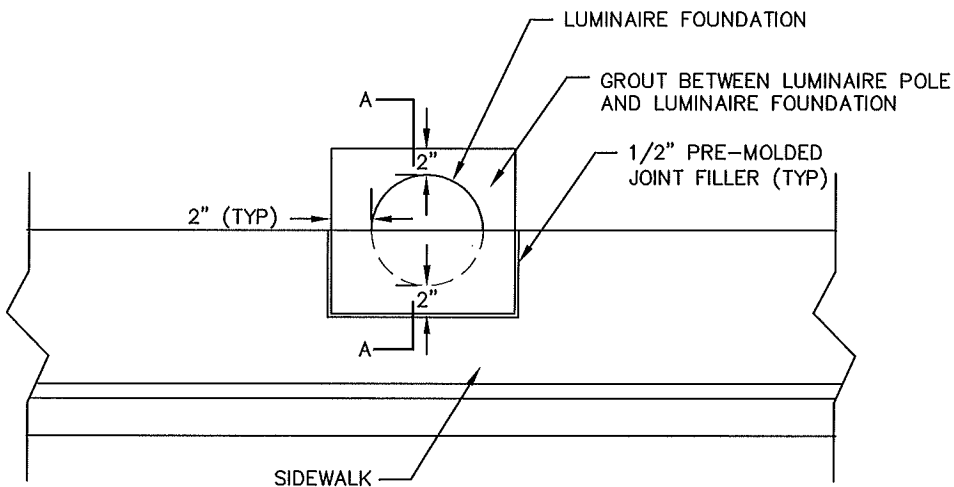

LUMINAIRE FOUNDATION AT SIDEWALK

NOTE: LUMINAIRE FOUNDATION DETAILS NOT SHOWN FOR CLARITY



REICHHARDT & EBE
ENGINEERING, INC.

423 Front St, Ste 201 Lynden, WA 98264
Phone 360-354-3687 FAX 360-354-0407

MAIN STREET
ADDENDUM 1

P:\Projects\08018\dwg\08018_SP1.dwg, ADDENDUM, 8/5/2010 2:19:06 PM

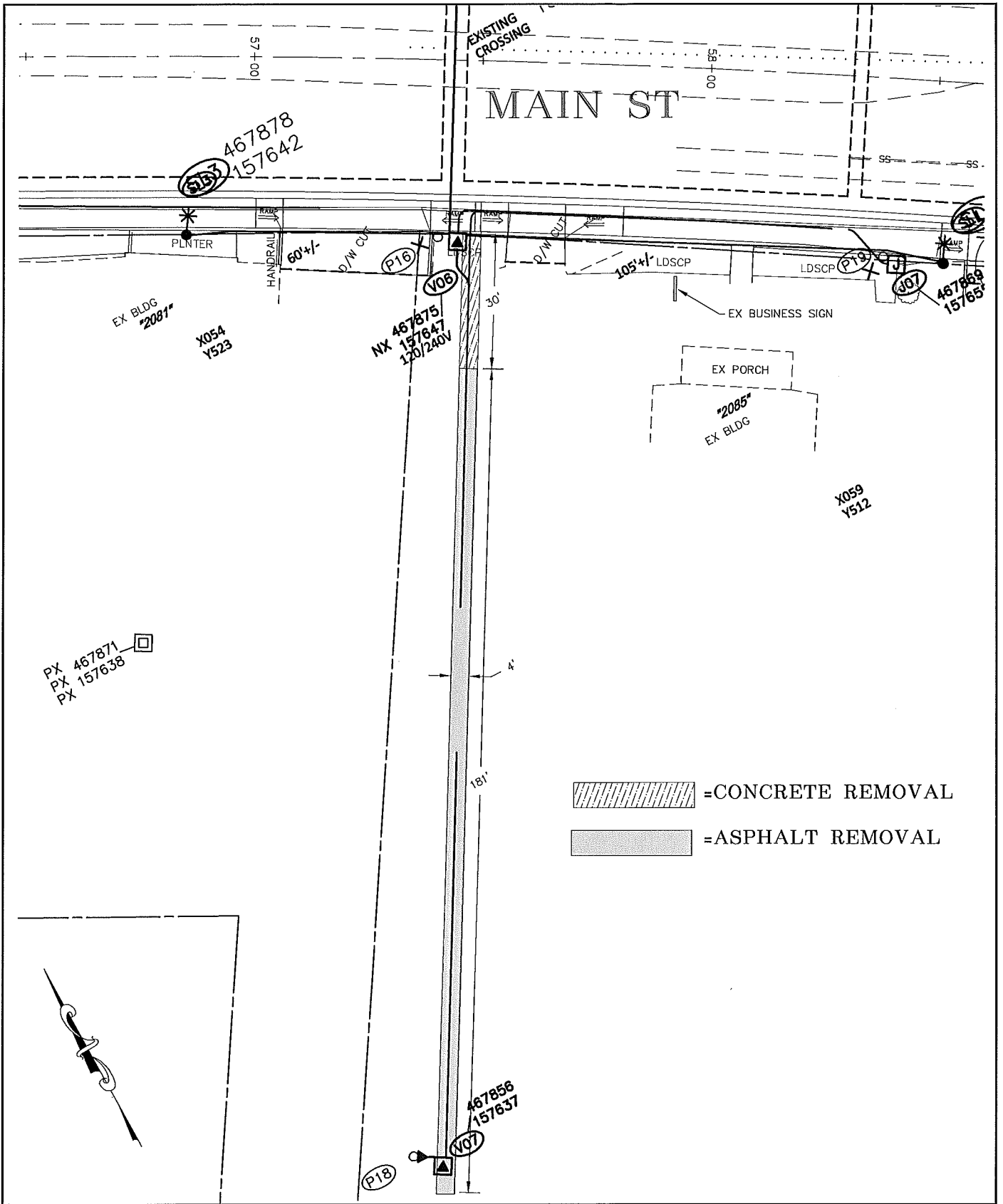

REICHHARDT & EBE
ENGINEERING, INC.

423 Front St, Ste 201 Lynden, WA 98264
Phone 360-354-3687 FAX 360-354-0407

**MAIN STREET
ADDENDUM 1**

8-5-10

1"=30' SHT 45

08018

P:\Projects\08018\dwg\08018_SP1.dwg_P&P_8/5/2010 2:36:41 PM

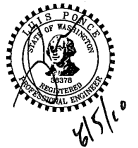
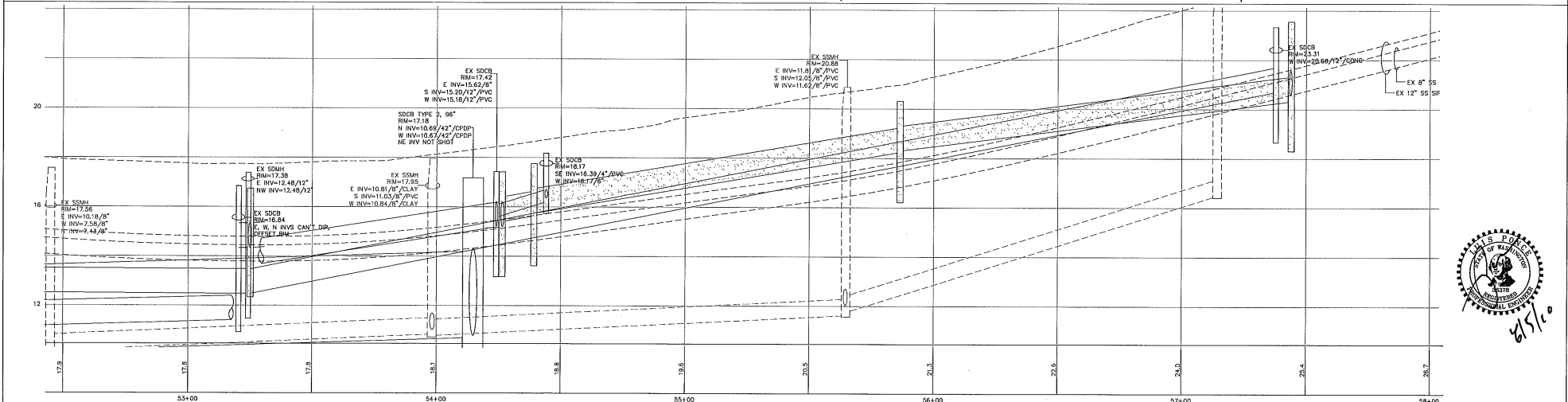
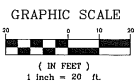
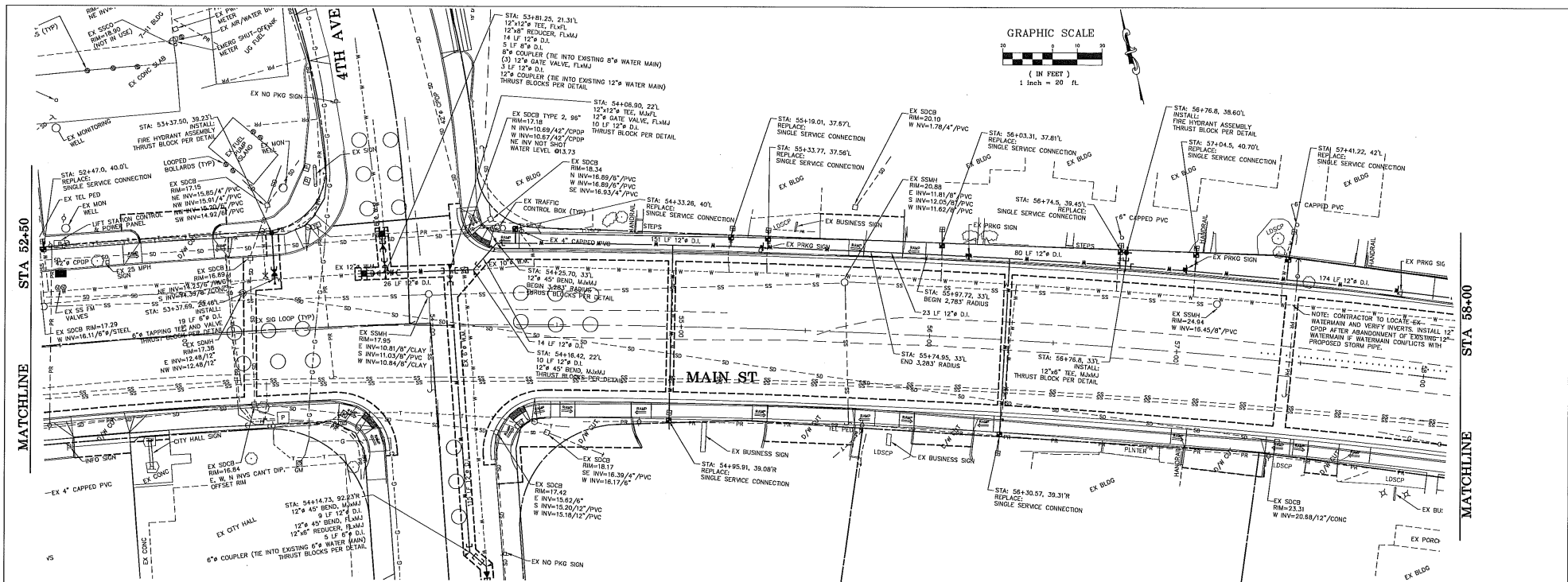

DESIGNED BY LP	REICHARDT & EBE ENGINEERING, INC. CONSULTING ENGINEERS PO Box 978 423 Front St., Ste 201 Ph (360) 354-3687 Lynden, Washington 98264 Fax (360) 354-0407	NO.	DATE	ADDENDUM 1	LP	CITY OF FERDALE PO BOX 936 FERDALE, WA 98248	MAIN STREET STREET IMPROVEMENTS STA 52+50 TO 58+00	JOB# / DWG	DATE	
DRAWN BY LMC		1	8-5-10	ADDENDUM 1	BY			08018	08018_SP1	7-21-10
CHECKED BY										SCALE
								H:1"=20' V:1"=2'	13	

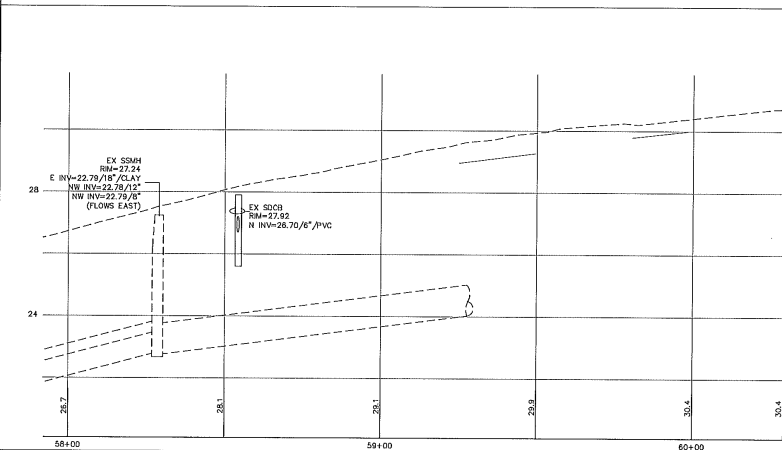
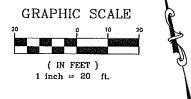
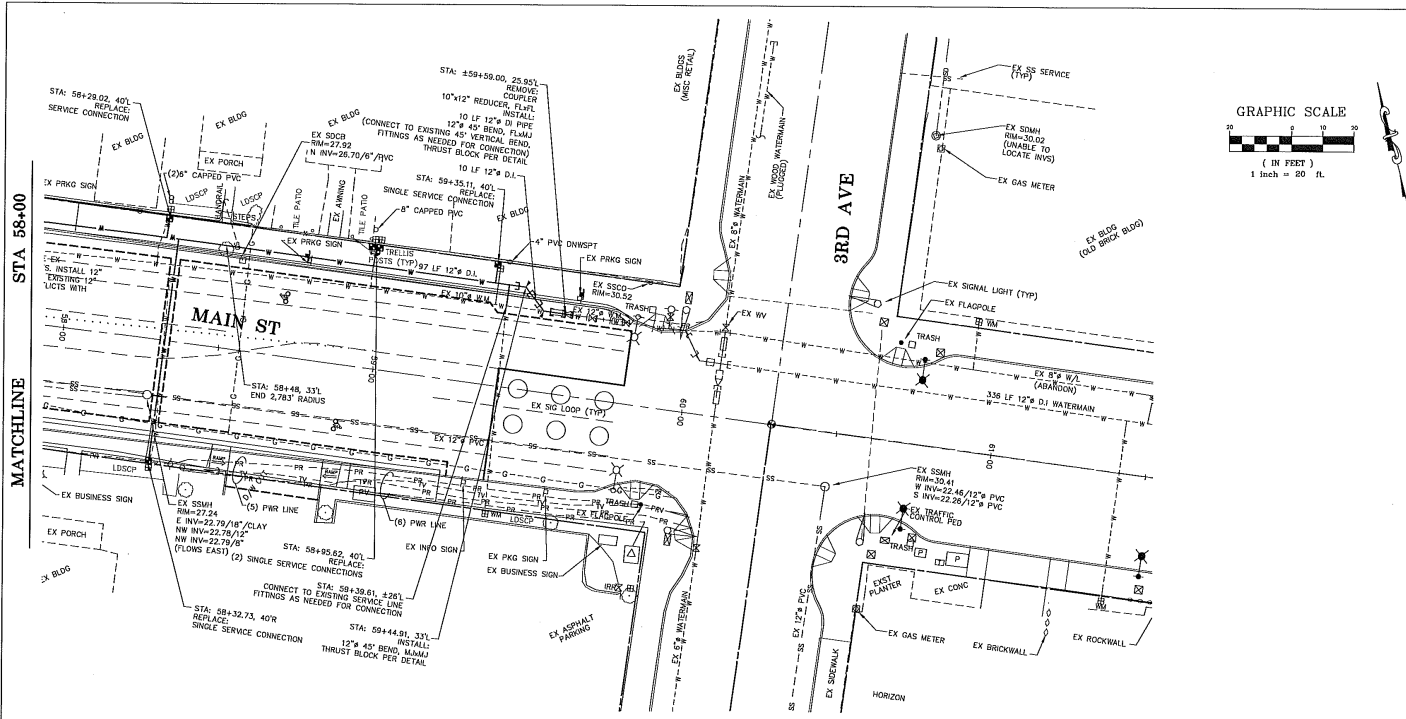

DESIGNED BY
LP
DRAWN BY
LMC
CHECKED BY



REICHARDT & EBE
ENGINEERING, INC.
CONSULTING ENGINEERS
PO Box 978 423 Front St., Ste 201 Ph (360) 354-2687
Lynden, Washington 98264 Fax (360) 354-0407

1	5-5-10	ADDENDUM 1	LP
NO.	DATE	REVISION	BY

CITY OF FERDALE
PO BOX 936
FERDALE, WA 98248

MAIN STREET
STREET IMPROVEMENTS
STA 58+00 TO 60+25

JOB# / DWG	DATE
08018 08018_SP1	7-21-10
SCALE	SHEET
H:1"=20' V:1"=2'	14

P:\Projects\08018.dwg\08018_SP1.dwg P&F 8/5/2010 2:37:00 PM

ALTERNATE A1

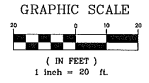
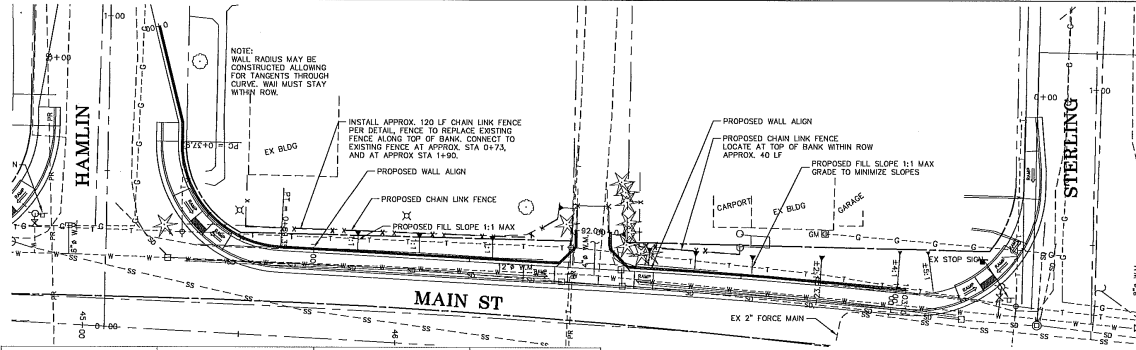

ALT A1 RETAINING WALL WEST

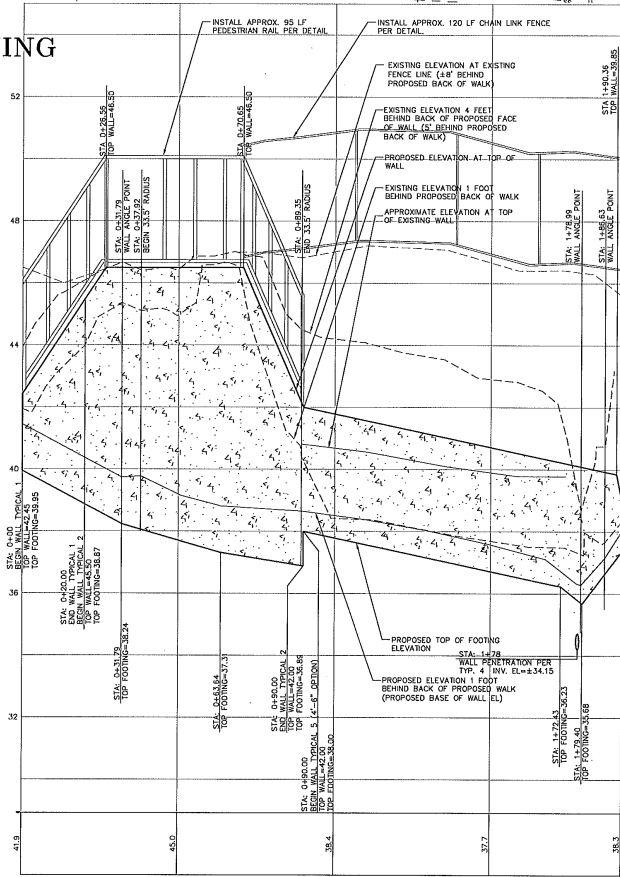

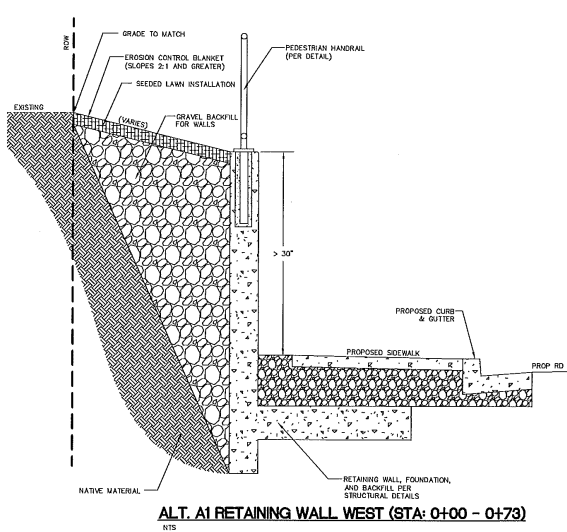

ALT. A1 RETAINING WALL WEST (STA: 0+00 - 0+73)
NTS

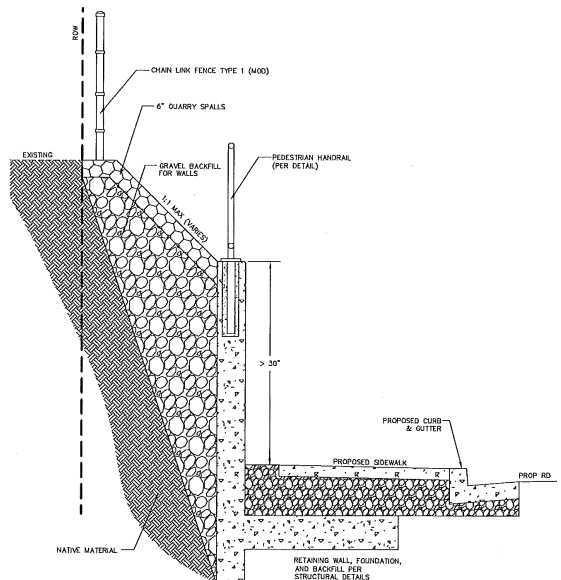

ALT. A1 RETAINING WALL WEST (STA: 0+73 - 0+90)
NTS

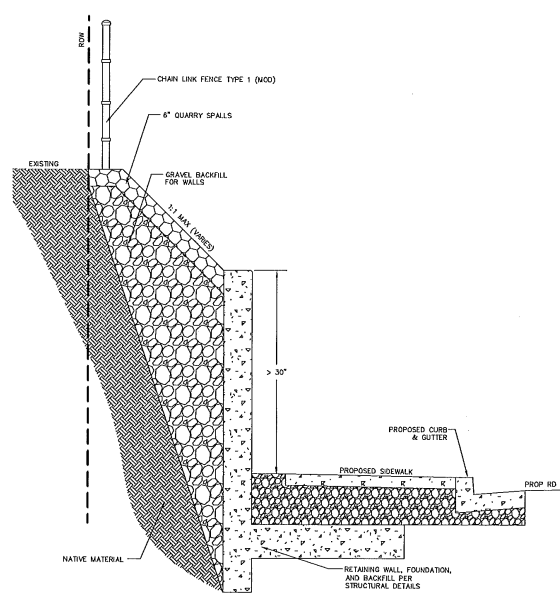

ALT. A1 RETAINING WALL WEST (STA: 0+90 - 1+90)
NTS

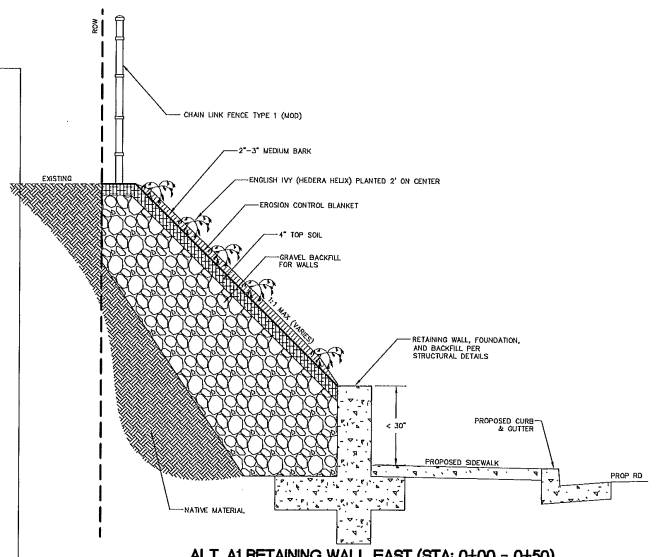

ALT. A1 RETAINING WALL EAST (STA: 0+00 - 0+50)
NTS

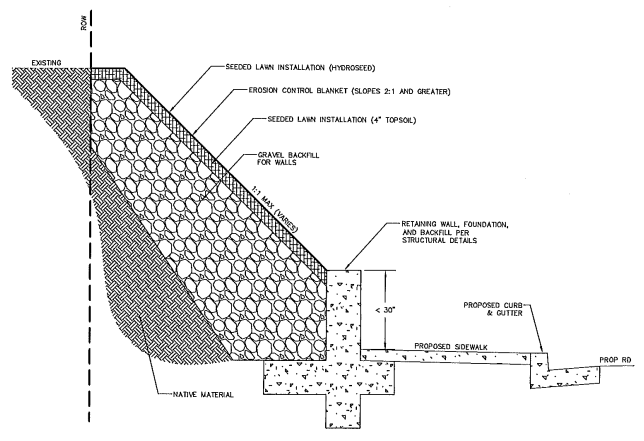

ALT. A1 RETAINING WALL EAST (STA: 0+50 - 1+03)
NTS

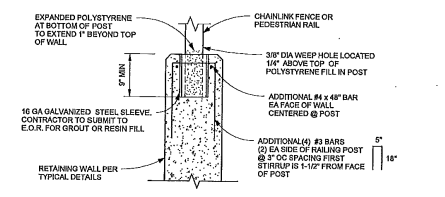

kingworks
CORNELIUS ENGINEERING, P.C.
10000 15TH AVENUE S.E.
BELLEVUE, WA 98005
WWW.KINGWORKS.COM

CHAINLINK POST DETAIL	
Project number	10000
City	20000
Drawn by	K01
Checked by	JPK
Scale	1/2" = 1'-0"
Sheet	S-2



ALTERNATE A1

DESIGNED BY LD
DRAWN BY MLK
CHECKED BY



REICHARDT & EBE
ENGINEERING, INC.
CONSULTING ENGINEERS
PO Box 978 423 Front St., Ste 201 Ph (360) 354-3687
Lynden, Washington 98264 Fax (360) 354-0407

NO.	DATE	REVISION	BY

CITY OF FERDALE
PO BOX 536
FERDALE, WA 98248

MAIN STREET
ADDENDUM 1
WALL SECTIONS, ALT A1

JOB# / DWG	DATE	SHEET
08018 08018_SP1	8-5-10	16
SCALE	H/n/a	v/n/a

P:\Projects\08018dwg\08018_SP1.dwg, ADDENDUM, 8/5/2010 2:14:10 PM

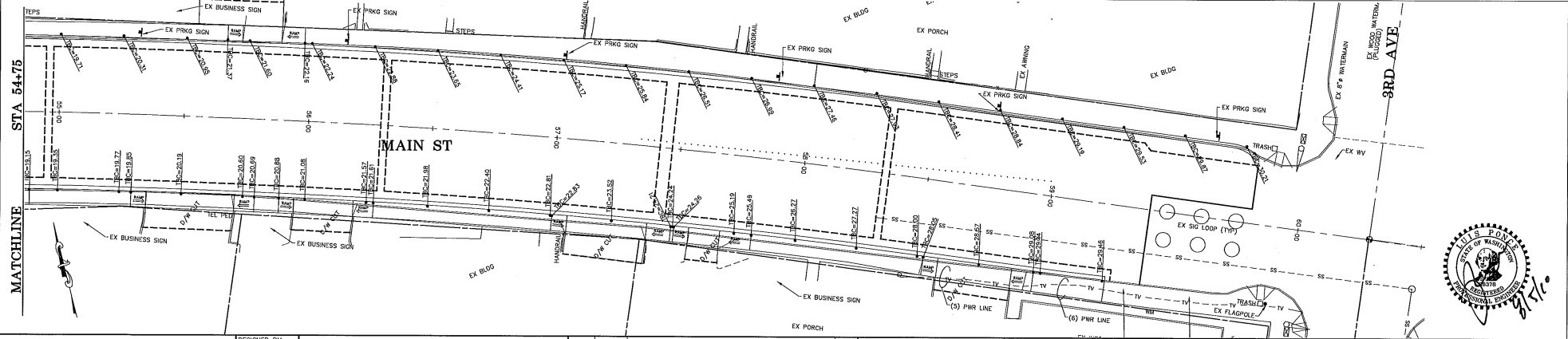
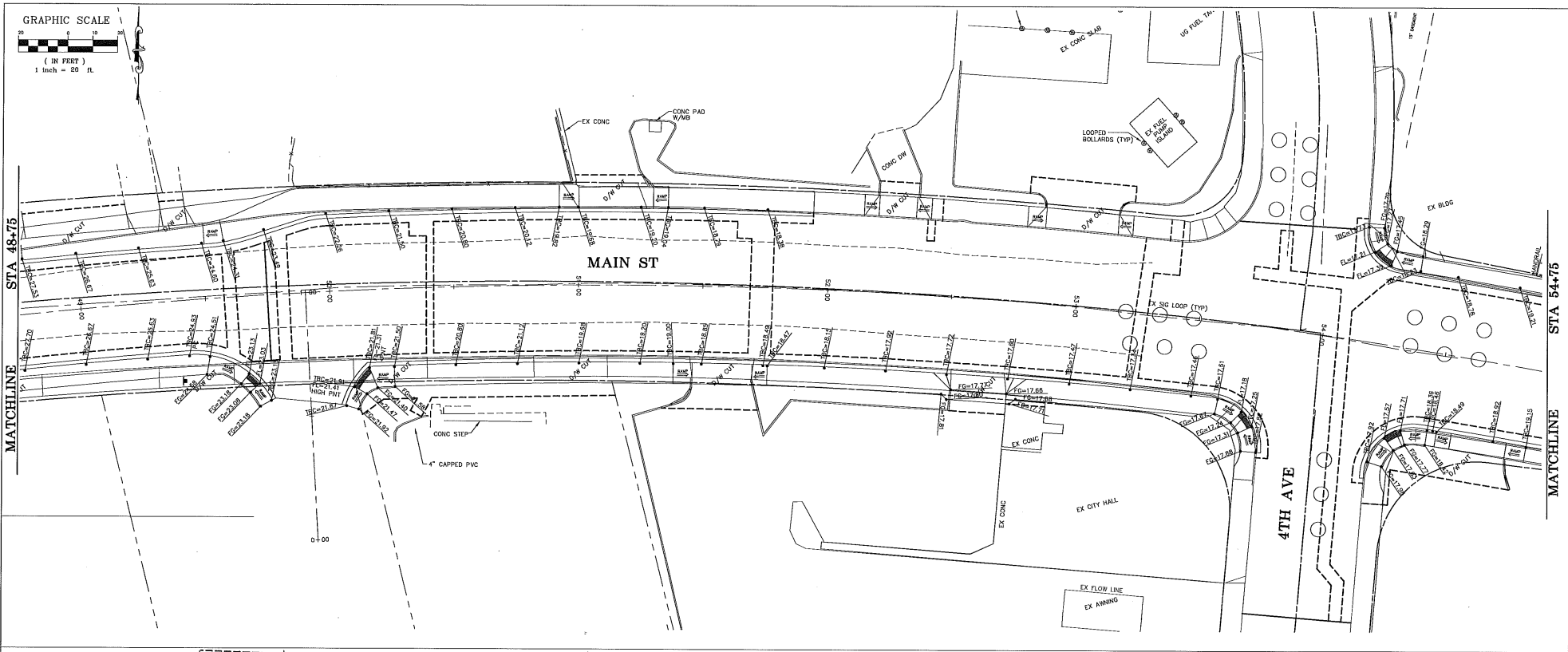
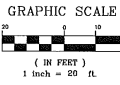

DESIGNED BY LP
 DRAWN BY MLK
 CHECKED BY



REICHHARDT & EBE
 ENGINEERING, INC.
 CONSULTING ENGINEERS
 PO Box 978 423 Front St, Ste 201 Ph (360) 354-3667
 Lynden, Washington 98284 Fax (360) 354-0407

NO.	DATE	REVISION
1	8-5-10	APPENDUM 1

LP
BY

CITY OF FERDALE
 PO BOX 936
 FERDALE, WA 98248

MAIN STREET
STREET IMPROVEMENTS
 GRADING PLAN STA 48+75 TO 60+75

JOB# / DWG	DATE
08018 08018_SP1	7-21-10
SCALE	SHEET
1/1" = 20' v.n/a	21



P:\Projects\08018\dwg\08018_SP1.dwg, GRADING, 8/5/2010 2:39:47 PM

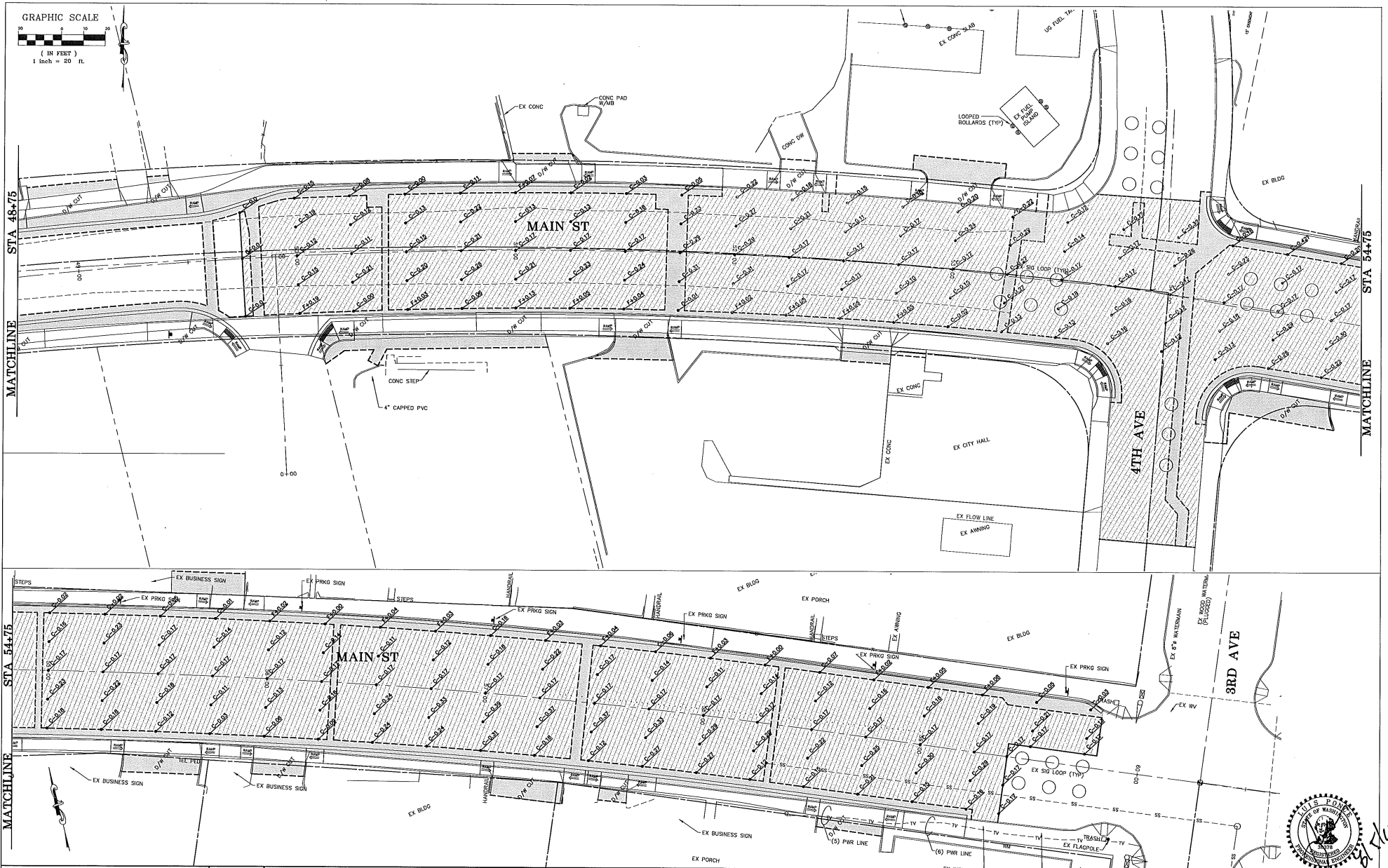
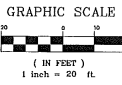

P:\Projects\08018\wg\08018_SP1.dwg, GRIND-GRADE, 8/5/2010 2:41:15 PM

DESIGNED BY LP
 DRAWN BY NZ
 CHECKED BY



REICHHARDT & EBE
 ENGINEERING, INC.
 CONSULTING ENGINEERS
 PO Box 978 423 Front St., Ste 201
 Lynden, Washington 98264 Ph (360) 354-3687
 Fax (360) 354-0407

NO.	1	DATE	8-5-10	ADDENDUM	I	LP	BY
REVISION							

CITY OF FERDALE
 PO BOX 936
 FERDALE, WA 98248

MAIN STREET
STREET IMPROVEMENTS
 GRINDING PLAN STA 48+75 TO 60+25

JOB# / DWG	08018	08018_SP1	DWG	7-21-10
SCALE	H:1"=20' V:n/a		SHEET	23



P:\Projects\08018\dwg\DET.dwg, DET, 8/5/2010 2:20:02 PM

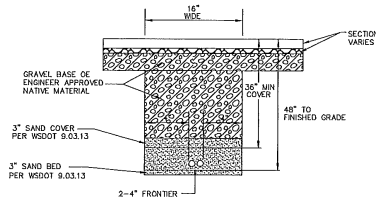

**COMMON UTILITY TRENCH
APPROX STA 36+00 TO 37+40, LT**

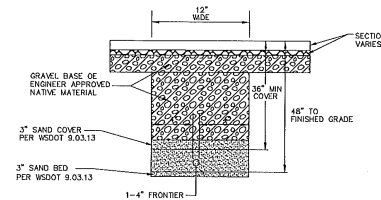

**COMMON UTILITY TRENCH
APPROX STA 36+60 TO 37+40, RT**

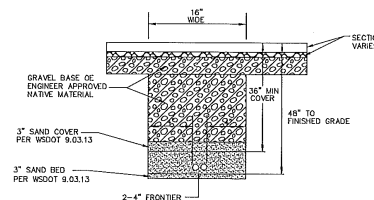

**COMMON UTILITY TRENCH
APPROX STA 37+40 TO 38+12, RT**

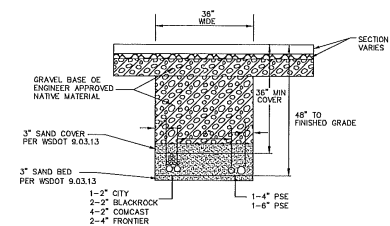

**COMMON UTILITY TRENCH
APPROX STA 44+00 TO 45+00, RT
APPROX STA 46+37 TO 47+57, RT**

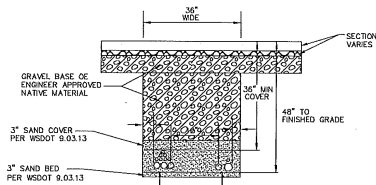

**COMMON UTILITY TRENCH
APPROX STA 38+12 TO 38+97, RT**

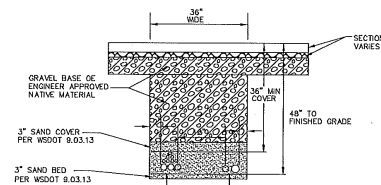

**COMMON UTILITY TRENCH
APPROX STA 38+97 TO 40+33, RT**

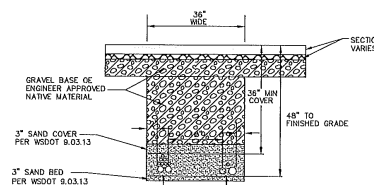

**COMMON UTILITY TRENCH
APPROX STA 40+33 TO 44+00, RT
APPROX STA 45+00 TO 46+37, RT
APPROX STA 47+57 TO 48+00, RT**

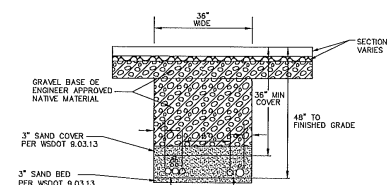

**COMMON UTILITY TRENCH
APPROX STA 48+00 TO 48+40, RT**

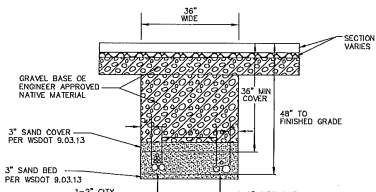

**COMMON UTILITY TRENCH
APPROX STA 48+40 TO 50+45, RT
APPROX STA 52+00 TO 52+44, RT**

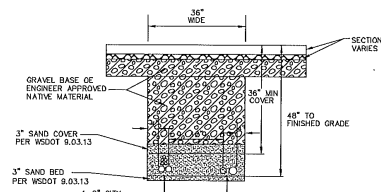

**COMMON UTILITY TRENCH
APPROX STA 50+45 TO 52+00, RT**

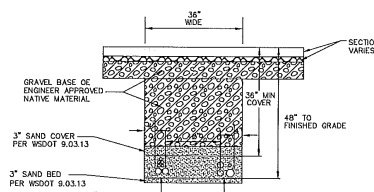

**COMMON UTILITY TRENCH
APPROX STA 52+44 TO 53+50, RT**

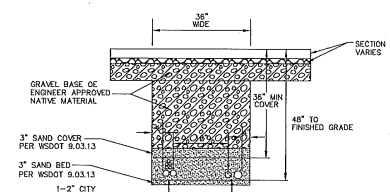

**COMMON UTILITY TRENCH
APPROX STA 53+50 TO 55+28, RT
APPROX STA 55+69 TO 56+85, RT**



DESIGNED BY
LP
DRAWN BY
LMC
CHECKED BY



REICHARDT & EBE
ENGINEERING, INC.
CONSULTING ENGINEERS
PO Box 978 493 Front St, Ste 201 FR (360) 354-3687
Lynden, Washington 98284 Fax (360) 354-0407

NO.	DATE	REVISION	BY

CITY OF FERDALE
PO BOX 936
FERDALE, WA 98248

MAIN STREET
ADDENDUM 1

JOB# / DWG	DET	DATE
08018	DET	8-5-10
SCALE		SHEET
n/a	n/a	42

P:\Projects\08018\dwg\DET.dwg, DET, 8/5/2010 2:21:16 PM

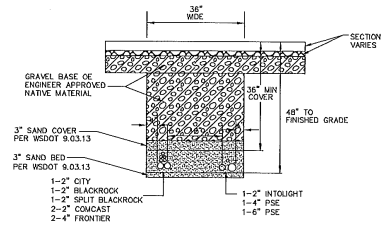

COMMON UTILITY TRENCH
 APPROX STA 55+28 TO 55+69, RT
 APPROX STA 56+85 TO 57+50, RT

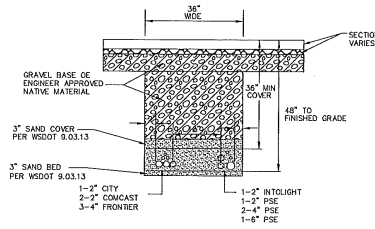

COMMON UTILITY TRENCH
 APPROX STA 57+50 TO 58+50, RT

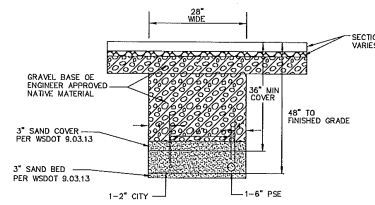

COMMON UTILITY TRENCH
 APPROX STA 58+50 TO 59+00, RT

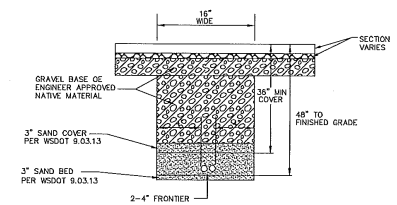

COMMON UTILITY TRENCH
 CROSSING APPROX STA 37+40
 (LENGTH APPROX 65 LF)

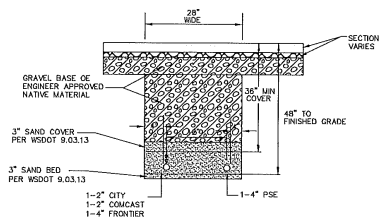

COMMON UTILITY TRENCH
 CROSSING APPROX STA 44+86
 (LENGTH APPROX 160 LF)

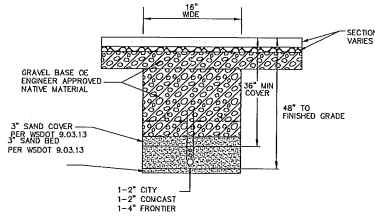

COMMON UTILITY TRENCH
 CROSSING APPROX STA 46+53
 (LENGTH APPROX 110 LF)
 CROSSING APPROX STA 48+40
 (LENGTH APPROX 183 LF)

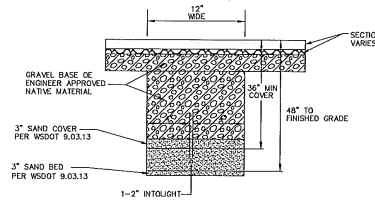

COMMON UTILITY TRENCH
 CROSSING APPROX STA 49+60
 CROSSING APPROX STA 55+64
 (LENGTH APPROX 75 LF)

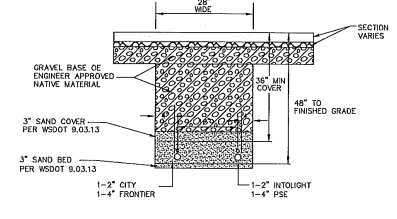

COMMON UTILITY TRENCH
 CROSSING APPROX STA 52+50
 (LENGTH APPROX 80 LF)

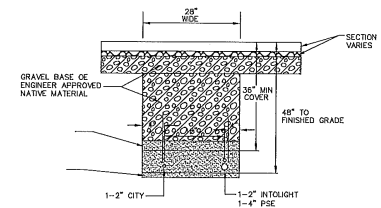

COMMON UTILITY TRENCH
 CROSSING APPROX STA 57+44
 (LENGTH APPROX 75 LF)

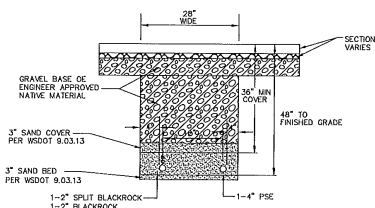

COMMON UTILITY TRENCH
 APPROX STA 57+47, 37' RT TO 245' RT
 (LENGTH APPROX 208 LF)

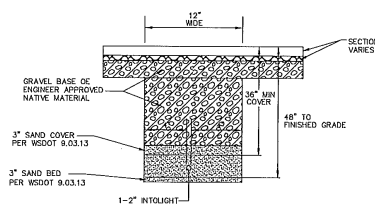

COMMON INTOLIGHT UTILITY TRENCH
 APPROX STA 49+65 TO 51+45, LT
 APPROX STA 52+50 TO 52+75, LT
 APPROX STA 54+25 TO 56+00, LT
 APPROX STA 57+44 TO 57+83, LT

FRONTIER HANDHOLE SCHEDULE

STATION	OFFSET	DIMENSIONS
37+41	37' LT	3W x 5L x 3D
37+41	28' RT	3W x 5L x 3D
38+12	28' RT	3W x 5L x 3D
44+82	135' LT	3W x 5L x 3D
44+84	28' RT	3W x 5L x 3D
46+48	28' RT	3W x 5L x 3D
46+56	102' RT	3W x 5L x 3D
49+47	132' RT	3W x 5L x 3D
52+47	44' RT	3W x 5L x 3D
52+50	39' LT	3W x 5L x 3D
54+27	39' RT	3W x 5L x 3D
54+30	17.5' RT	3W x 5L x 3D
54+88	17.5' RT	3W x 5L x 3D
58+38	38' RT	3W x 5L x 3D

NOTE:
 STATION AND OFFSET ARE APPROXIMATE ONLY. LOCATIONS ARE SUBJECT TO CHANGE.

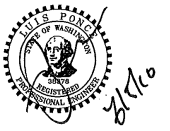

DESIGNED BY
 LP
 DRAWN BY
 LMC
 CHECKED BY



REICHARDT & EBE
 ENGINEERING, INC.
 CONSULTING ENGINEERS

PO Box 978 423 Front St., Ste 201 Ph (360) 354-3887
 Lynden, Washington 98264 Fax (360) 354-0407

NO.	DATE	REVISION	BY

CITY OF FERDALE
 PO BOX 936
 FERDALE, WA 98248

MAIN STREET
 ADDENDUM I

JOB# / DWG	DET	DATE
08018	DET	8-5-10
SCALE	SHEET	
H/A	V/A	43

P:\Projects\08018\dwg\08018_SP1.dwg, ADDENDUM, 8/5/2010 2:17:29 PM

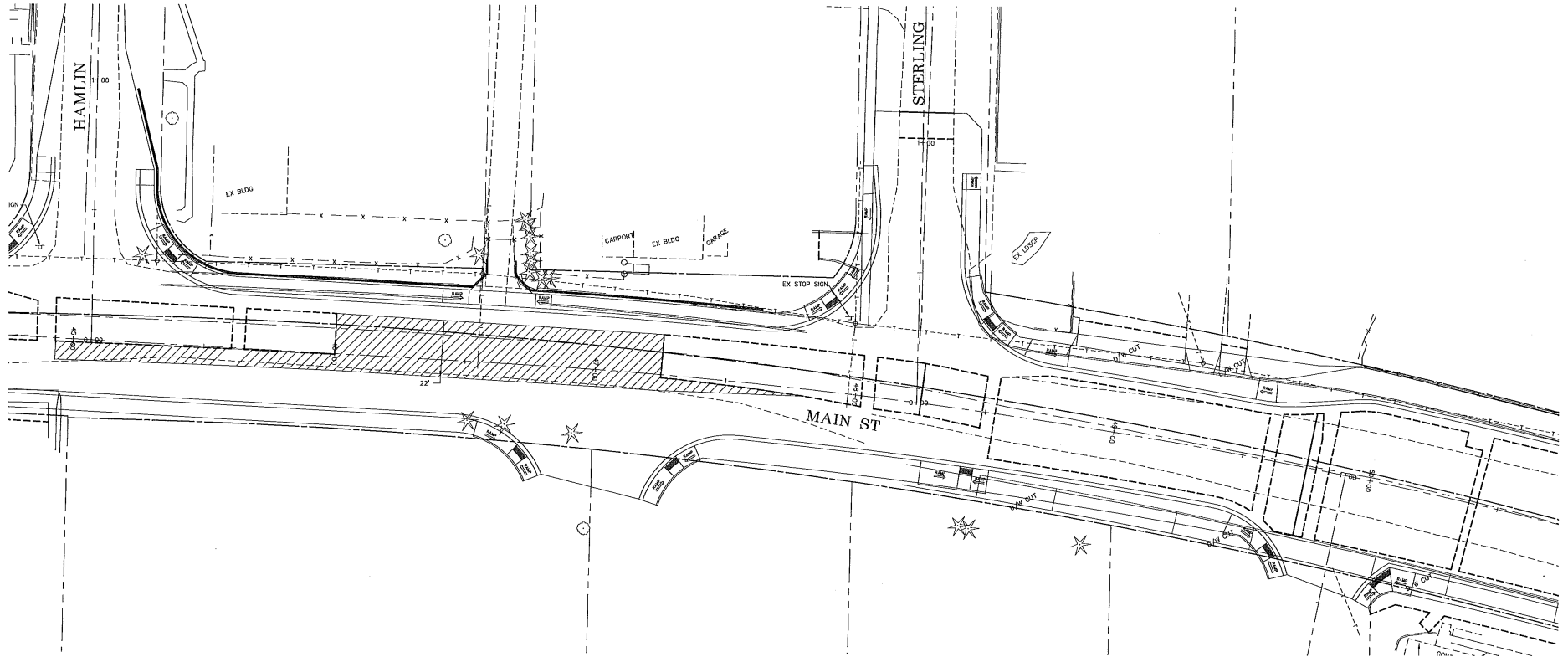

 =TEMPORARY PAVEMENT SECTION, 4" HMA DEPTH

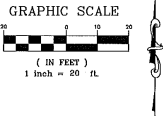

Handwritten signature/initials

DESIGNED BY LP	 REICHHARDT & EBE ENGINEERING, INC. CONSULTING ENGINEERS PO Box 978 423 Front St., Ste 201 Ph (360) 354-3687 Lynden, Washington 98264 Fax (360) 354-0407	NO.	DATE	REVISION	BY	CITY OF FERDALE PO BOX 936 FERDALE, WA 98248	MAIN STREET TEMPORARY PAVEMENT SECTION ADDENDUM 1	JOB# / DWG 08018 08018_SP1 SCALE H: 1"=20' v: N/A	DATE 8-5-10 SHEET 44
DRAWN BY									
CHECKED BY									

Aug 05, 2010 - 4:00pm P:\Projects\06018\Drawn\Received\PS\06-4-10-PS-101063873.dwg, Page 5 - Site Plan, 8/5/2010 4:00:34 PM
 P:\Projects\06018\Drawn\Received\PS\06-4-10-PS-101063873.dwg, Page 5 - Site Plan, 8/5/2010 4:00:34 PM

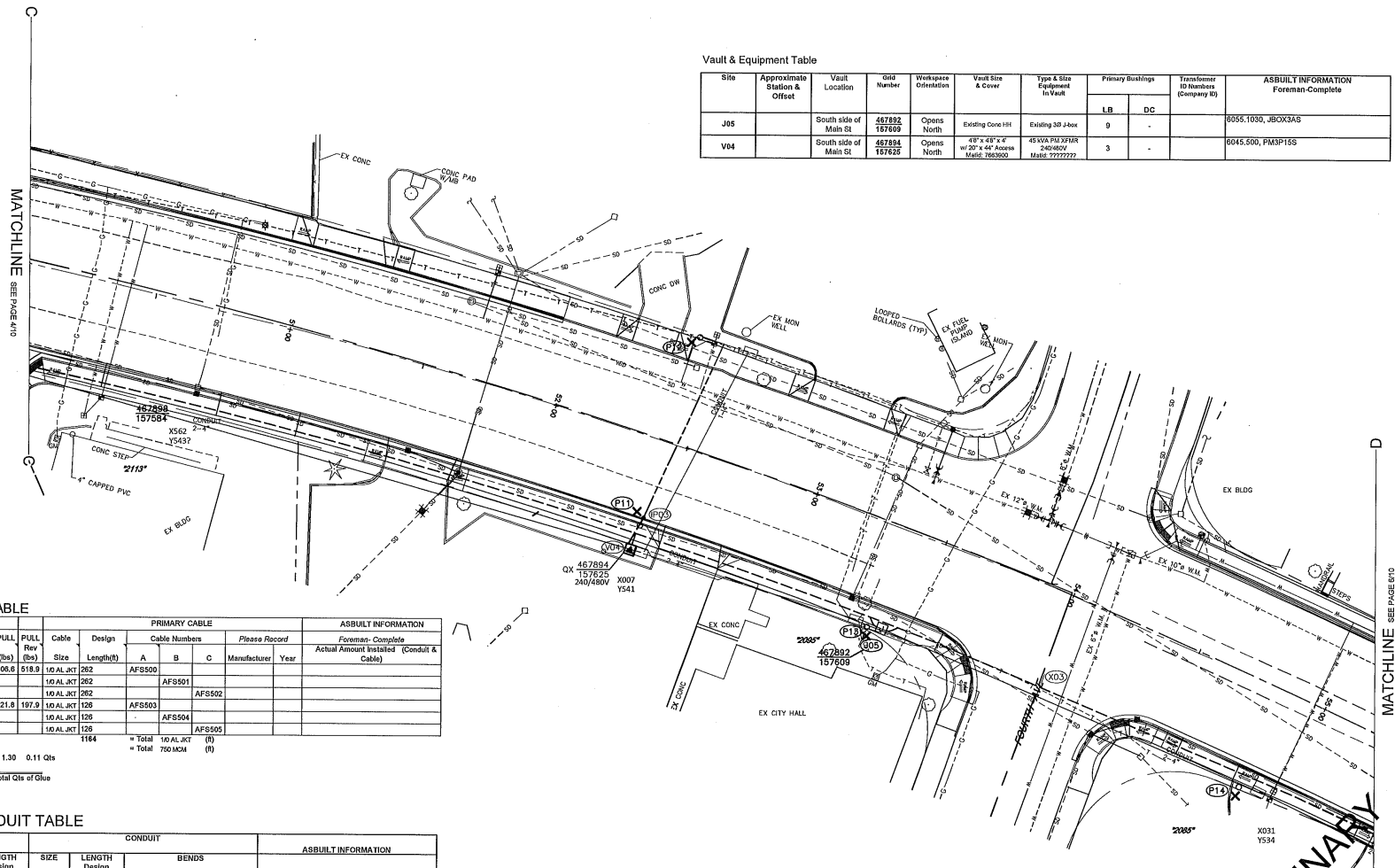

Vault & Equipment Table

Site	Approximate Station & Offset	Vault Location	Old Number	Workspace Orientation	Vault Size & Cover	Type & Size Equipment In Vault	Primary Bushings		Transformer ID Numbers (Company ID)	ASBUILT INFORMATION Foreman-Complete
							LB	DC		
J05		South side of Main St	467892 187609	Opens North	Existing Conc 18"	Existing 30' Hex	0	-		8055.1030, JBOX3AS
V04		South side of Main St	467894 157625	Opens North	48" x 48" x 4" w/ 20" x 44" Access Manhole 785909	45 3/4" x 3/4" x 3/4" 240/480V	3	-		8045.5000, PK3P1S6

PRIMARY CABLE & CONDUIT TABLE

LOCATION	Size Qty	Design	CONDUIT				PULL Rev (lbs)	Cable Size	Design	PRIMARY CABLE			Please Record	ASBUILT INFORMATION Foreman-Complete Actual Amount Installed (Conduit & Cable)
			Length (ft)	90°	45°	22°				11°	Length(ft)	A		
J05	J06	4	2	232	1		600.6	518.9	10 AL JKT	282	AFS500			
"	"	"	"	"	"	"	"	"	10 AL JKT	282	AFS01			
J05	V04	4	1	96	1		221.8	197.9	10 AL JKT	128	AFS003		AFS02	
"	"	"	"	"	"	"	"	"	10 AL JKT	128	AFS04		AFS05	
"	"	"	"	"	"	"	"	"	10 AL JKT	128	AFS05			
			2" PVC (B) & Bends = 3				1.30		0.11 Qts		1164		= Total 10 AL JKT (ft)	
			3" PVC (B) & Bends = 560										= Total 750 MCM (ft)	
			4" PVC (B) & Bends = 560											
			6" PVC (B) & Bends = 560											
							Total Qts of Glue							

SECONDARY CABLE & CONDUIT TABLE

LOCATION	FROM	TO	CABLE		CONDUIT				ASBUILT INFORMATION Foreman-Complete Actual Amount Installed (Conduit & Cable)		
			SIZE	LENGTH Design (ft)	SIZE	LENGTH Design (ft)	BENDS				
V04	IP03		7	25	3	110	90°	45°	22°	11°	

CROSSINGS CONDUIT TABLE

X-ING NO.	LOCATION	POWER			Length (ft)	Remarks (type of crossing) (Primary, Feeder, Secondary, St, Light, Gas Only, etc.)
		SIZE	Type	Qty		
X03	J05	J06	4	DB120	1	Primary
X03	PV01	PV02	8	DB120	1	Feeder

SERVICE RELOCATIONS AND CONVERSIONS

Name & Address	Meter Location	Old Point of Delivery	New Point of Delivery	Service Notes
Main St. Sewer Pump	West of 7-11 parking entrance	P03	V02	Existing OH svc to be converted

PRELIMINARY NOT FOR CONSTRUCTION

REV#	DATE	BY	DESCRIPTION	DESIGNED BY	CHECKED BY	APPROVED BY
1						
2						
3						

FUNCTION	CONTACT	City of Farm
PROJECT MGR	Jason Downing	(360) 661-2987 4/20/10
DRAWN BY	Jason Downing	(360) 661-2987 4/20/10
CHECKED BY	Javier Valdez	(360) 661-3876 4/20/10
APPROVED BY		

UTILITIES	Black Rock Cable	Cascade Natural Gas	Comcast	Verizon
CONTACT	Nancy Wilson	Glenn VanCott	Bill Inama	Dean Day
PHONE#	(360) 366-6498	(206) 661-3095	(360) 816-8354	(360) 263-7

PUGET SOUND ENERGY
 Main Street Sch .74
 Overhead to Underground Conversion
 Main St. between Cornell Dr. & 3rd Ave., Ferndale

DESIGNED BY **POTELCO INC**
 SCALE: 1" = 20'

Aug 05, 2010 - 4:06pm P:\Projects\061010\061010\Received\PSR-4-10-PSE\10063823 Main Street 8-4-10.dwg
 P:\Projects\061010\061010\Received\PSR-4-10-PSE\10063823 Main Street 8-4-10.dwg, Page 6 - Site Plan, 9/5/2010 4:06:28 PM

SERVICE RELOCATIONS AND CONVERSIONS

Name & Address	Meter Location	Old Point of Delivery	New Point of Delivery	Service Notes
Shell Station, 2085 Main St. Vocus Frews Holdings, 2089 Main St.	SE side of building West side of building	P14 P16	V05 V08	Existing OH Svc to be converted Existing OH Svc to be converted

Vault & Equipment Table

Site	Approximate Station & Offset	Vault Location	Grid Number	Workspace Orientation	Vault Size & Cover	Type & Size Equipment in Vault	Primary Bushings		Transformer ID Number (Company ID)	ASBUILT INFORMATION Foreman-Complete
							LB	DC		
PV02		South side of Main St.	467886 157653	Opens North	5108 Sheet Vault w/ 2 Amlock Doors Mater: 9995168	Ø9 12" Straight Splice Mater: 9995168	-	-		6051.2000, SVD0AS
J06		South side of Main St.	467881 157656	Opens N&S	48" x 48" x 4" w/ 2 3/4" Amlock Doors Mater: 7653000	3 - 4 Position J-Bus Mater: 7652900	6	6		6055.1030, JBOX3AS
J07		South side of Main St.	467869 157678	Opens N&S	64" x 110" x 42" w/ 7 Amlock Doors Mater: 9995168	15KV 3 - 4 Position J-Bus Mater: 7652900	10	2		6055.1030, JBOX3AS
V05A		Near Apt. Complex	467870 157623	Opens North	Existing Concrete	Existing 3Ø TUT Xtrn	-	-		Replace vault lid
V05B		West of Shell Station	467879 157653	Opens East	48" x 48" x 4" Undertilted Mater: 7653000	37.5 KVA PM XTRN 120040V Mater: 6247500	1	1		6045.1010, MINUTSR
V06		South side of Main St.	467873 157670	Opens North	48" x 48" x 4" Undertilted Mater: 7653000	25 KVA PM XTRN 120040V Mater: 6247500	1	1		6045.1010, MINUTSR
V07		Behind Rite-Aid	467866 157660	Opens East	48" x 48" x 4" w/ 2 3/4" Amlock Doors Mater: 7653000	225 KVA PM XTRN 120040V Mater: 6247500	3	-		6045.500, PM3P15S

SECONDARY CABLE & CONDUIT TABLE

LOCATION		CABLE		CONDUIT				ASBUILT INFORMATION		
FROM	TO	SIZE	LENGTH Design (ft)	SIZE	LENGTH (ft)	BENDS				Foreman - Complete
						90°	45°	22°	11°	Actual Amount Installed (Conduit & Cable)
V06	P18	110-40-300	265	3	210					
V07	P18	410 Quad	95	4	10					

PRIMARY CABLE & CONDUIT TABLE

LOCATION		CONDUIT		PRIMARY CABLE				ASBUILT INFORMATION		
Item	Qty	Design Length (ft)	BENDS	PULL Length (ft)	PULL Rev (lbs)	Cable Size	Design Length (ft)	Cable Numbers	Phase Record	Foreman-Complete
			90° 45° 22° 11°					A B C	Manufacturer Year	Actual Amount Installed (Conduit & Cable)
J06	J07	4	2	257	4	10 AL AKT 535	417.9	417.9	AFS508	
"	"	"	"	"	"	10 AL AKT 535	"	"	AFS507	
"	"	"	"	"	"	10 AL AKT 535	"	"	AFS508	
J06	V05B	2	1	30	148.5	10 AL AKT 60	147.7	147.7	AFS508	
J06	IP04	"	"	"	"	10 AL AKT	"	"	3715	Reroute cables into J06
"	"	"	"	"	"	10 AL AKT	"	"	3718	Reroute cables into J06
"	"	"	"	"	"	10 AL AKT	"	"	3717	Reroute cables into J06
J07	V06	2	1	80	221.6	10 AL AKT 135	221.9	221.9	AFS510	
J07	V07	4	1	293	395.4	10 AL AKT 323	521.1	521.1	AFS511	
"	"	"	"	"	"	10 AL AKT 323	"	"	AFS512	
"	"	"	"	"	"	10 AL AKT 323	"	"	AFS513	
J07	IP05	"	"	"	"	10 AL AKT	"	"	ACE894	Reroute cables into J07
"	"	"	"	"	"	10 AL AKT	"	"	ACE895	Reroute cables into J07
"	"	"	"	"	"	10 AL AKT	"	"	ACE896	Reroute cables into J07
2" PVC (N) & Bends = 110		1	2		0.22	0.09 Qts	2769			= Total 10 AL AKT (ft)
3" PVC (R) & Bends = 807		1	10		2.39	0.95 Qts				= Total 750 MCM (ft)
4" PVC (N) & Bends = 807										
6" PVC (N) & Bends =										
Total Qts of Glue										

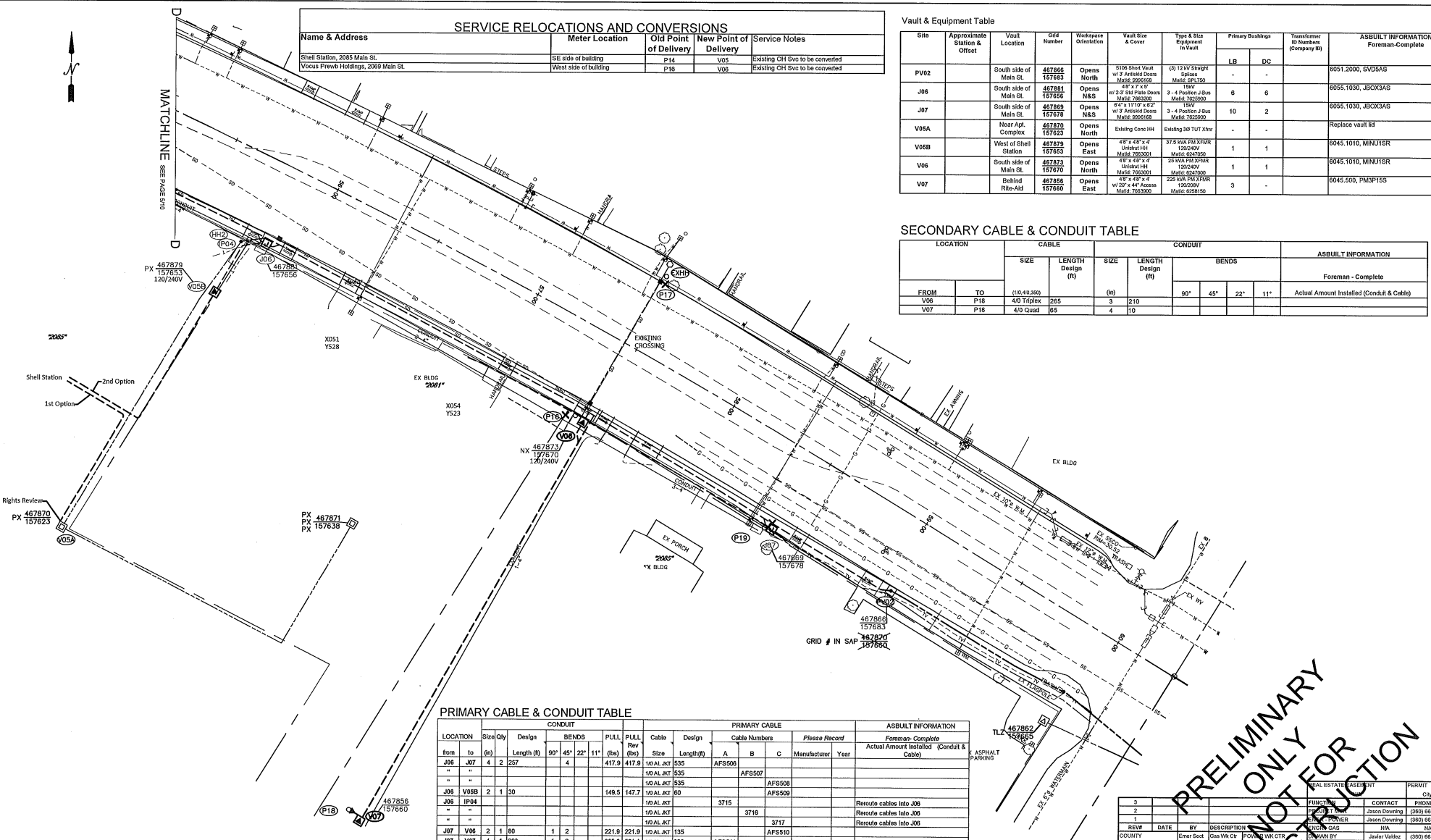

PRELIMINARY ONLY NOT FOR CONSTRUCTION

REV#	DATE	BY	DESCRIPTION	DESIGNED BY	CHECKED BY	APPROVED BY	FOREMAN #1	FOREMAN #2
3								
2								
1								
0								

FUNCTION	CONTACT	PHONE NO.	City of Fern
DESIGN	Jason Downing	(352) 661-2987	4201K
PERMIT	Jason Downing	(352) 661-2987	4201K
CONSTRUCTION	Javier Valdez	(352) 661-3976	4201K

UTILITIES	Black Rock Cable	Cascade Natural Gas	Comcast	Verizon
CONTRACT	Blank Wilson	Golden Val/Curbish	Bill Irms	Dean Dup
PHONE#	(352) 206-5488	(352) 661-3099	(352) 816-8364	(352) 759-7

PUGET SOUND ENERGY
 Main Street Sch .74
 Overhead to Underground Conversion
 Main St, between Cornell Dr. & 3rd Ave., Florida

DESIGNED BY: **POTELCO INC**
 SCALE: 1" = 20'
 INCIDENT: N/A
 Eject Order: 101063873

Removal of Existing Facilities

CIRCUIT FEET REMOVED: 2,214

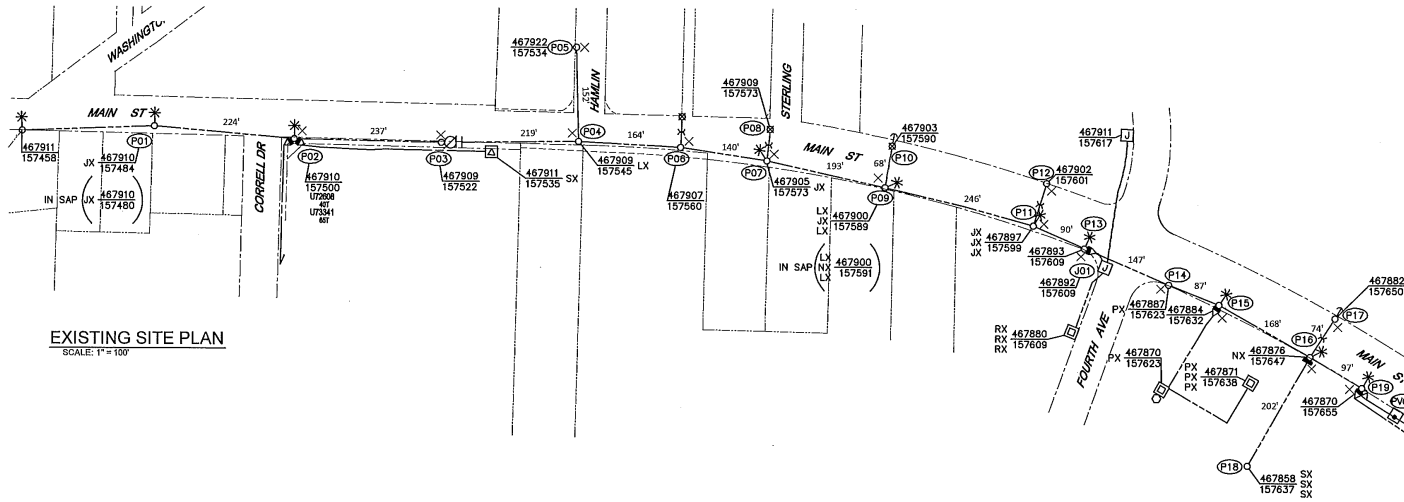

EXISTING SITE PLAN
SCALE: 1" = 100'

SITE #	POLE DATA				POLE		TEMP TRANSFERS			TRANSFERS
	GRID #	HEIGHT	CLASS	YEAR	TOPPED	RMVD	TEL	TV	FIBER	ST. LIGHT
P01	467910-157484	40		1972	<input type="checkbox"/>	<input type="checkbox"/>	<input type="checkbox"/>	<input type="checkbox"/>	<input type="checkbox"/>	<input type="checkbox"/>
P02	467910-157500	45	3	1998	<input type="checkbox"/>	<input type="checkbox"/>	<input type="checkbox"/>	<input type="checkbox"/>	<input type="checkbox"/>	<input type="checkbox"/>
P03	467909-157522	45	3	1998	<input type="checkbox"/>	<input type="checkbox"/>	<input type="checkbox"/>	<input type="checkbox"/>	<input type="checkbox"/>	<input type="checkbox"/>
P04	467909-157545	45		1977	<input type="checkbox"/>	<input type="checkbox"/>	<input type="checkbox"/>	<input type="checkbox"/>	<input type="checkbox"/>	<input type="checkbox"/>
P05	467922-157534	35		1984	<input type="checkbox"/>	<input type="checkbox"/>	<input type="checkbox"/>	<input type="checkbox"/>	<input type="checkbox"/>	<input type="checkbox"/>
P06	467907-157560	45		1977	<input type="checkbox"/>	<input type="checkbox"/>	<input type="checkbox"/>	<input type="checkbox"/>	<input type="checkbox"/>	<input type="checkbox"/>
P07	467905-157573	45		1977	<input type="checkbox"/>	<input type="checkbox"/>	<input type="checkbox"/>	<input type="checkbox"/>	<input type="checkbox"/>	<input type="checkbox"/>
P08	467900-157589 (467900-157591)			1979 (1978)	<input type="checkbox"/>	<input type="checkbox"/>	<input type="checkbox"/>	<input type="checkbox"/>	<input type="checkbox"/>	<input type="checkbox"/>
P11	467897-157599	40		1981	<input type="checkbox"/>	<input type="checkbox"/>	<input type="checkbox"/>	<input type="checkbox"/>	<input type="checkbox"/>	<input type="checkbox"/>
P12	467902-157601				<input type="checkbox"/>	<input type="checkbox"/>	<input type="checkbox"/>	<input type="checkbox"/>	<input type="checkbox"/>	<input type="checkbox"/>
P13	467893-157609	45		1978	<input type="checkbox"/>	<input type="checkbox"/>	<input type="checkbox"/>	<input type="checkbox"/>	<input type="checkbox"/>	<input type="checkbox"/>
P14	467887-157623	45		1978	<input type="checkbox"/>	<input type="checkbox"/>	<input type="checkbox"/>	<input type="checkbox"/>	<input type="checkbox"/>	<input type="checkbox"/>
P15	467884-157632	45		1978	<input type="checkbox"/>	<input type="checkbox"/>	<input type="checkbox"/>	<input type="checkbox"/>	<input type="checkbox"/>	<input type="checkbox"/>
P16	467876-157647	40		1984	<input type="checkbox"/>	<input type="checkbox"/>	<input type="checkbox"/>	<input type="checkbox"/>	<input type="checkbox"/>	<input type="checkbox"/>
P17	467882-157650				<input type="checkbox"/>	<input type="checkbox"/>	<input type="checkbox"/>	<input type="checkbox"/>	<input type="checkbox"/>	<input type="checkbox"/>
P18	467870-157655	45	H1	2004	<input type="checkbox"/>	<input type="checkbox"/>	<input type="checkbox"/>	<input type="checkbox"/>	<input type="checkbox"/>	<input type="checkbox"/>

Transformer Removal Table

Site	Grid	Size (kVA)	Secondary Voltage	Company ID#	Remarks
P01	467910-157484 (467910-157480)	10	120/240V	467910-157480P1	
P04	467909-157545	15	120/240V	467909-157545P1	
P07	467905-157573	10	120/240V	467905-157573P1	
P09	467900-157589 (467900-157591)	15	120/240V	36340	
P09	467900-157589 (467900-157591)	25	120/240V	36341	
P09	467900-157589 (467900-157591)	15	120/240V	36425	
P11	467897-157599	10	240/480V	36426	
P11	467897-157599	10	240/480V	36426	
P11	467897-157599	10	240/480V	36427	
P14	467887-157623	37.5	120/208V	36334	
P16	467876-157647	25	120/240V	DB2481	
P18	467858-157637	75	120/208V	36328	
P18	467858-157637	75	120/208V	36330	
P18	467858-157637	75	120/208V	36329	
P06	404195-160281	25	277/480V	DD4538	

OH WIRE REMOVAL TABLE

Location		Wire Size & Type	Quantity	Length (per conductor)	Remarks
P01	P19	336 ACSR	3	2,012	
P01	P19	4/0 ACSR	1	2,012	
P16	P18	#2 ACSR	4	202'	
P04	P05	1/0 Triplex	1	152'	
P14	P15	1/0 Triplex	1	87'	
P10	P18	1/0 Triplex	1	202'	
					6,030' Total 336 ACSR Removed
					2,012' Total 4/0 ACSR Removed
					808' Total #2 ACSR Removed
					441' Total 1/0 Triplex Removed

UG CABLE REMOVAL TABLE					
Location		Wire Size & Type	Quantity	Length (per conductor)	Remarks
P19	PV02	750 MCM	3	102'	Cable # ADE027-029
P13	J05	1/0 Al Jkt	3	65'	Cable # 7906-7908
					309' Total 750 MCM Removed
					195' Total 1/0 Al Jkt Removed

REV#	DATE	BY	DESCRIPTION	DATE	BY	DESCRIPTION
1			Initial			
2			Revised			
3			Revised			
4			Revised			
5			Revised			
6			Revised			
7			Revised			
8			Revised			
9			Revised			
10			Revised			
11			Revised			
12			Revised			
13			Revised			
14			Revised			
15			Revised			
16			Revised			
17			Revised			
18			Revised			
19			Revised			
20			Revised			
21			Revised			
22			Revised			
23			Revised			
24			Revised			
25			Revised			
26			Revised			
27			Revised			
28			Revised			
29			Revised			
30			Revised			
31			Revised			
32			Revised			
33			Revised			
34			Revised			
35			Revised			
36			Revised			
37			Revised			
38			Revised			
39			Revised			
40			Revised			
41			Revised			
42			Revised			
43			Revised			
44			Revised			
45			Revised			
46			Revised			
47			Revised			
48			Revised			
49			Revised			
50			Revised			

POTELCO INC
 Overhead to Underground Conversion
 Main St. between Correll Dr. & 3rd Ave., Fossilville
 SCALE: 1" = 100'
 DESIGNED BY: P
 CHECKED BY: P
 APPROVED BY: P
 FOREMAN #1: P
 FOREMAN #2: P
 FOREMAN #3: P
 FOREMAN #4: P
 FOREMAN #5: P
 FOREMAN #6: P
 FOREMAN #7: P
 FOREMAN #8: P
 FOREMAN #9: P
 FOREMAN #10: P
 FOREMAN #11: P
 FOREMAN #12: P
 FOREMAN #13: P
 FOREMAN #14: P
 FOREMAN #15: P
 FOREMAN #16: P
 FOREMAN #17: P
 FOREMAN #18: P
 FOREMAN #19: P
 FOREMAN #20: P
 FOREMAN #21: P
 FOREMAN #22: P
 FOREMAN #23: P
 FOREMAN #24: P
 FOREMAN #25: P
 FOREMAN #26: P
 FOREMAN #27: P
 FOREMAN #28: P
 FOREMAN #29: P
 FOREMAN #30: P
 FOREMAN #31: P
 FOREMAN #32: P
 FOREMAN #33: P
 FOREMAN #34: P
 FOREMAN #35: P
 FOREMAN #36: P
 FOREMAN #37: P
 FOREMAN #38: P
 FOREMAN #39: P
 FOREMAN #40: P
 FOREMAN #41: P
 FOREMAN #42: P
 FOREMAN #43: P
 FOREMAN #44: P
 FOREMAN #45: P
 FOREMAN #46: P
 FOREMAN #47: P
 FOREMAN #48: P
 FOREMAN #49: P
 FOREMAN #50: P
 FOREMAN #51: P
 FOREMAN #52: P
 FOREMAN #53: P
 FOREMAN #54: P
 FOREMAN #55: P
 FOREMAN #56: P
 FOREMAN #57: P
 FOREMAN #58: P
 FOREMAN #59: P
 FOREMAN #60: P
 FOREMAN #61: P
 FOREMAN #62: P
 FOREMAN #63: P
 FOREMAN #64: P
 FOREMAN #65: P
 FOREMAN #66: P
 FOREMAN #67: P
 FOREMAN #68: P
 FOREMAN #69: P
 FOREMAN #70: P
 FOREMAN #71: P
 FOREMAN #72: P
 FOREMAN #73: P
 FOREMAN #74: P
 FOREMAN #75: P
 FOREMAN #76: P
 FOREMAN #77: P
 FOREMAN #78: P
 FOREMAN #79: P
 FOREMAN #80: P
 FOREMAN #81: P
 FOREMAN #82: P
 FOREMAN #83: P
 FOREMAN #84: P
 FOREMAN #85: P
 FOREMAN #86: P
 FOREMAN #87: P
 FOREMAN #88: P
 FOREMAN #89: P
 FOREMAN #90: P
 FOREMAN #91: P
 FOREMAN #92: P
 FOREMAN #93: P
 FOREMAN #94: P
 FOREMAN #95: P
 FOREMAN #96: P
 FOREMAN #97: P
 FOREMAN #98: P
 FOREMAN #99: P
 FOREMAN #100: P
 FOREMAN #101: P
 FOREMAN #102: P
 FOREMAN #103: P
 FOREMAN #104: P
 FOREMAN #105: P
 FOREMAN #106: P
 FOREMAN #107: P
 FOREMAN #108: P
 FOREMAN #109: P
 FOREMAN #110: P
 FOREMAN #111: P
 FOREMAN #112: P
 FOREMAN #113: P
 FOREMAN #114: P
 FOREMAN #115: P
 FOREMAN #116: P
 FOREMAN #117: P
 FOREMAN #118: P
 FOREMAN #119: P
 FOREMAN #120: P
 FOREMAN #121: P
 FOREMAN #122: P
 FOREMAN #123: P
 FOREMAN #124: P
 FOREMAN #125: P
 FOREMAN #126: P
 FOREMAN #127: P
 FOREMAN #128: P
 FOREMAN #129: P
 FOREMAN #130: P
 FOREMAN #131: P
 FOREMAN #132: P
 FOREMAN #133: P
 FOREMAN #134: P
 FOREMAN #135: P
 FOREMAN #136: P
 FOREMAN #137: P
 FOREMAN #138: P
 FOREMAN #139: P
 FOREMAN #140: P
 FOREMAN #141: P
 FOREMAN #142: P
 FOREMAN #143: P
 FOREMAN #144: P
 FOREMAN #145: P
 FOREMAN #146: P
 FOREMAN #147: P
 FOREMAN #148: P
 FOREMAN #149: P
 FOREMAN #150: P
 FOREMAN #151: P
 FOREMAN #152: P
 FOREMAN #153: P
 FOREMAN #154: P
 FOREMAN #155: P
 FOREMAN #156: P
 FOREMAN #157: P
 FOREMAN #158: P
 FOREMAN #159: P
 FOREMAN #160: P
 FOREMAN #161: P
 FOREMAN #162: P
 FOREMAN #163: P
 FOREMAN #164: P
 FOREMAN #165: P
 FOREMAN #166: P
 FOREMAN #167: P
 FOREMAN #168: P
 FOREMAN #169: P
 FOREMAN #170: P
 FOREMAN #171: P
 FOREMAN #172: P
 FOREMAN #173: P
 FOREMAN #174: P
 FOREMAN #175: P
 FOREMAN #176: P
 FOREMAN #177: P
 FOREMAN #178: P
 FOREMAN #179: P
 FOREMAN #180: P
 FOREMAN #181: P
 FOREMAN #182: P
 FOREMAN #183: P
 FOREMAN #184: P
 FOREMAN #185: P
 FOREMAN #186: P
 FOREMAN #187: P
 FOREMAN #188: P
 FOREMAN #189: P
 FOREMAN #190: P
 FOREMAN #191: P
 FOREMAN #192: P
 FOREMAN #193: P
 FOREMAN #194: P
 FOREMAN #195: P
 FOREMAN #196: P
 FOREMAN #197: P
 FOREMAN #198: P
 FOREMAN #199: P
 FOREMAN #200: P
 FOREMAN #201: P
 FOREMAN #202: P
 FOREMAN #203: P
 FOREMAN #204: P
 FOREMAN #205: P
 FOREMAN #206: P
 FOREMAN #207: P
 FOREMAN #208: P
 FOREMAN #209: P
 FOREMAN #210: P
 FOREMAN #211: P
 FOREMAN #212: P
 FOREMAN #213: P
 FOREMAN #214: P
 FOREMAN #215: P
 FOREMAN #216: P
 FOREMAN #217: P
 FOREMAN #218: P
 FOREMAN #219: P
 FOREMAN #220: P
 FOREMAN #221: P
 FOREMAN #222: P
 FOREMAN #223: P
 FOREMAN #224: P
 FOREMAN #225: P
 FOREMAN #226: P
 FOREMAN #227: P
 FOREMAN #228: P
 FOREMAN #229: P
 FOREMAN #230: P
 FOREMAN #231: P
 FOREMAN #232: P
 FOREMAN #233: P
 FOREMAN #234: P
 FOREMAN #235: P
 FOREMAN #236: P
 FOREMAN #237: P
 FOREMAN #238: P
 FOREMAN #239: P
 FOREMAN #240: P
 FOREMAN #241: P
 FOREMAN #242: P
 FOREMAN #243: P
 FOREMAN #244: P
 FOREMAN #245: P
 FOREMAN #246: P
 FOREMAN #247: P
 FOREMAN #248: P
 FOREMAN #249: P
 FOREMAN #250: P
 FOREMAN #251: P
 FOREMAN #252: P
 FOREMAN #253: P
 FOREMAN #254: P
 FOREMAN #255: P
 FOREMAN #256: P
 FOREMAN #257: P
 FOREMAN #258: P
 FOREMAN #259: P
 FOREMAN #260: P
 FOREMAN #261: P
 FOREMAN #262: P
 FOREMAN #263: P
 FOREMAN #264: P
 FOREMAN #265: P
 FOREMAN #266: P
 FOREMAN #267: P
 FOREMAN #268: P
 FOREMAN #269: P
 FOREMAN #270: P
 FOREMAN #271: P
 FOREMAN #272: P
 FOREMAN #273: P
 FOREMAN #274: P
 FOREMAN #275: P
 FOREMAN #276: P
 FOREMAN #277: P
 FOREMAN #278: P
 FOREMAN #279: P
 FOREMAN #280: P
 FOREMAN #281: P
 FOREMAN #282: P
 FOREMAN #283: P
 FOREMAN #284: P
 FOREMAN #285: P
 FOREMAN #286: P
 FOREMAN #287: P
 FOREMAN #288: P
 FOREMAN #289: P
 FOREMAN #290: P
 FOREMAN #291: P
 FOREMAN #292: P
 FOREMAN #293: P
 FOREMAN #294: P
 FOREMAN #295: P
 FOREMAN #296: P
 FOREMAN #297: P
 FOREMAN #298: P
 FOREMAN #299: P
 FOREMAN #300: P
 FOREMAN #301: P
 FOREMAN #302: P
 FOREMAN #303: P
 FOREMAN #304: P
 FOREMAN #305: P
 FOREMAN #306: P
 FOREMAN #307: P
 FOREMAN #308: P
 FOREMAN #309: P
 FOREMAN #310: P
 FOREMAN #311: P
 FOREMAN #312: P
 FOREMAN #313: P
 FOREMAN #314: P
 FOREMAN #315: P
 FOREMAN #316: P
 FOREMAN #317: P
 FOREMAN #318: P
 FOREMAN #319: P
 FOREMAN #320: P
 FOREMAN #321: P
 FOREMAN #322: P
 FOREMAN #323: P
 FOREMAN #324: P
 FOREMAN #325: P
 FOREMAN #326: P
 FOREMAN #327: P
 FOREMAN #328: P
 FOREMAN #329: P
 FOREMAN #330: P
 FOREMAN #331: P
 FOREMAN #332: P
 FOREMAN #333: P
 FOREMAN #334: P
 FOREMAN #335: P
 FOREMAN #336: P
 FOREMAN #337: P
 FOREMAN #338: P
 FOREMAN #339: P
 FOREMAN #340: P
 FOREMAN #341: P
 FOREMAN #342: P
 FOREMAN #343: P
 FOREMAN #344: P
 FOREMAN #345: P
 FOREMAN #346: P
 FOREMAN #347: P
 FOREMAN #348: P
 FOREMAN #349: P
 FOREMAN #350: P
 FOREMAN #351: P
 FOREMAN #352: P
 FOREMAN #353: P
 FOREMAN #354: P
 FOREMAN #355: P
 FOREMAN #356: P
 FOREMAN #357: P
 FOREMAN #358: P
 FOREMAN #359: P
 FOREMAN #360: P
 FOREMAN #361: P
 FOREMAN #362: P
 FOREMAN #363: P
 FOREMAN #364: P
 FOREMAN #365: P
 FOREMAN #366: P
 FOREMAN #367: P
 FOREMAN #368: P
 FOREMAN #369: P
 FOREMAN #370: P
 FOREMAN #371: P
 FOREMAN #372: P
 FOREMAN #373: P
 FOREMAN #374: P
 FOREMAN #375: P
 FOREMAN #376: P
 FOREMAN #377: P
 FOREMAN #378: P
 FOREMAN #379: P
 FOREMAN #380: P
 FOREMAN #381: P
 FOREMAN #382: P
 FOREMAN #383: P
 FOREMAN #384: P
 FOREMAN #385: P
 FOREMAN #386: P
 FOREMAN #387: P
 FOREMAN #388: P
 FOREMAN #389: P
 FOREMAN #390: P
 FOREMAN #391: P
 FOREMAN #392: P
 FOREMAN #393: P
 FOREMAN #394: P
 FOREMAN #395: P
 FOREMAN #396: P
 FOREMAN #397: P
 FOREMAN #398: P
 FOREMAN #399: P
 FOREMAN #400: P
 FOREMAN #401: P
 FOREMAN #402: P
 FOREMAN #403: P
 FOREMAN #404: P
 FOREMAN #405: P
 FOREMAN #406: P
 FOREMAN #407: P
 FOREMAN #408: P
 FOREMAN #409: P
 FOREMAN #410: P
 FOREMAN #411: P
 FOREMAN #412: P
 FOREMAN #413: P
 FOREMAN #414: P
 FOREMAN #415: P
 FOREMAN #416: P
 FOREMAN #417: P
 FOREMAN #418: P
 FOREMAN #419: P
 FOREMAN #420: P
 FOREMAN #421: P
 FOREMAN #422: P
 FOREMAN #423: P
 FOREMAN #424: P
 FOREMAN #425: P
 FOREMAN #426: P
 FOREMAN #427: P
 FOREMAN #428: P
 FOREMAN #429: P
 FOREMAN #430: P
 FOREMAN #431: P
 FOREMAN #432: P
 FOREMAN #433: P
 FOREMAN #434: P
 FOREMAN #435: P
 FOREMAN #436: P
 FOREMAN #437: P
 FOREMAN #438: P
 FOREMAN #439: P
 FOREMAN #440: P
 FOREMAN #441: P
 FOREMAN #442: P
 FOREMAN #443: P
 FOREMAN #444: P
 FOREMAN #445: P
 FOREMAN #446: P
 FOREMAN #447: P
 FOREMAN #448: P
 FOREMAN #449: P
 FOREMAN #450: P
 FOREMAN #451: P
 FOREMAN #452: P
 FOREMAN #453: P
 FOREMAN #454: P
 FOREMAN #455: P
 FOREMAN #456: P
 FOREMAN #457: P
 FOREMAN #458: P
 FOREMAN #459: P
 FOREMAN #460: P
 FOREMAN #461: P
 FOREMAN #462: P
 FOREMAN #463: P
 FOREMAN #464: P
 FOREMAN #465: P
 FOREMAN #466: P
 FOREMAN #467: P
 FOREMAN #468: P
 FOREMAN #469: P
 FOREMAN #470: P
 FOREMAN #471: P
 FOREMAN #472: P
 FOREMAN #473: P
 FOREMAN #474: P
 FOREMAN #475: P
 FOREMAN #476: P
 FOREMAN #477: P
 FOREMAN #478: P
 FOREMAN #479: P
 FOREMAN #480: P
 FOREMAN #481: P
 FOREMAN #482: P
 FOREMAN #483: P
 FOREMAN #484: P
 FOREMAN #485: P
 FOREMAN #486: P
 FOREMAN #487: P
 FOREMAN #488: P
 FOREMAN #489: P
 FOREMAN #490: P
 FOREMAN #491: P
 FOREMAN #492: P
 FOREMAN #493: P
 FOREMAN #494: P
 FOREMAN #495: P
 FOREMAN #496: P
 FOREMAN #497: P
 FOREMAN #498: P
 FOREMAN #499: P
 FOREMAN #500: P
 FOREMAN #501: P
 FOREMAN #502: P
 FOREMAN #503: P
 FOREMAN #504: P
 FOREMAN #505: P
 FOREMAN #506: P
 FOREMAN #507: P
 FOREMAN #508:

No. 05 010 - 1557m A) Received (PSE) 4-10-10 PSE 11:06:37.3 Main Street Sch 74-10.dwg, Page 8 - Conduit, 8/5/2010 1:53:52 PM
 P:\05 010\1557m A) Received (PSE) 4-10-10 PSE 11:06:37.3 Main Street Sch 74-10.dwg, Page 8 - Conduit, 8/5/2010 1:53:52 PM

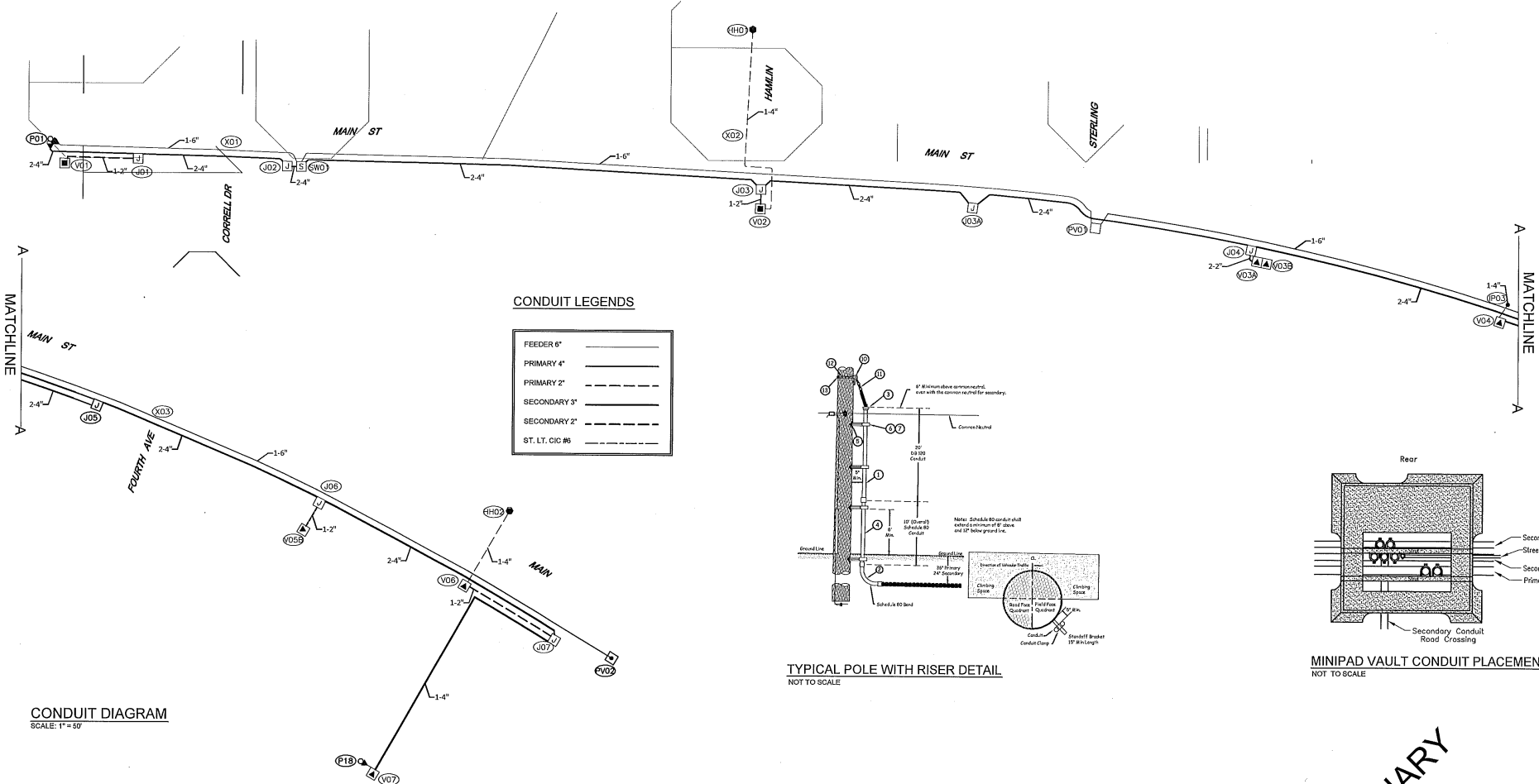

CONDUIT LEGENDS

FEEDER 6"	—————
PRIMARY 4"	—————
PRIMARY 2"	—————
SECONDARY 3"	—————
SECONDARY 2"	—————
ST. LT. CIC #6	—————

CONDUIT DIAGRAM
SCALE: 1" = 50'

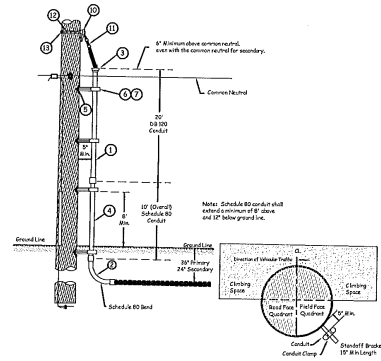

TYPICAL POLE WITH RISER DETAIL
NOT TO SCALE

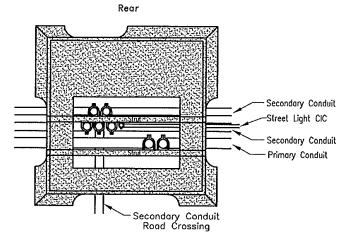

MINIPAD VAULT CONDUIT PLACEMENT
NOT TO SCALE

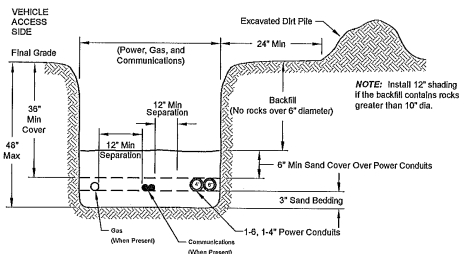

TRENCH EXCAVATION DETAIL
NOT TO SCALE

PRELIMINARY ONLY NOT FOR CONSTRUCTION

REV#	DATE	BY	DESCRIPTION	FUNCTION	CONTACT	PHONE NO
3						
2					Jason Downing	(360) 691-2687
1					Jason Downing	(360) 691-2687
0					Javier Valdez	(360) 691-2676

UTILITIES	COMPANY	CONTACT	PHONE
Black Rock Cable	Cascade Natural Gas	Comcast	Verizon
Randy Wilson	Golden West/Corbach	B/E Inmate	Dean Dop
(360) 300-5400	(360) 691-3500	(360) 616-6344	(360) 767-7

DESIGNED BY	CHECKED BY	APPROVED BY	DATE
PUCET SOUND ENERGY	EMERSON	FOREMAN #1	8/5/2010

INCIDENT	SCALE
Gas 4550R	1" = 50'
N/A	
101063873	

PUCET SOUND ENERGY
 Main Street Sch. 74
 Overhead to Underground Conversion
 Main St between Correll Dr. & 3rd Ave., Ferndale

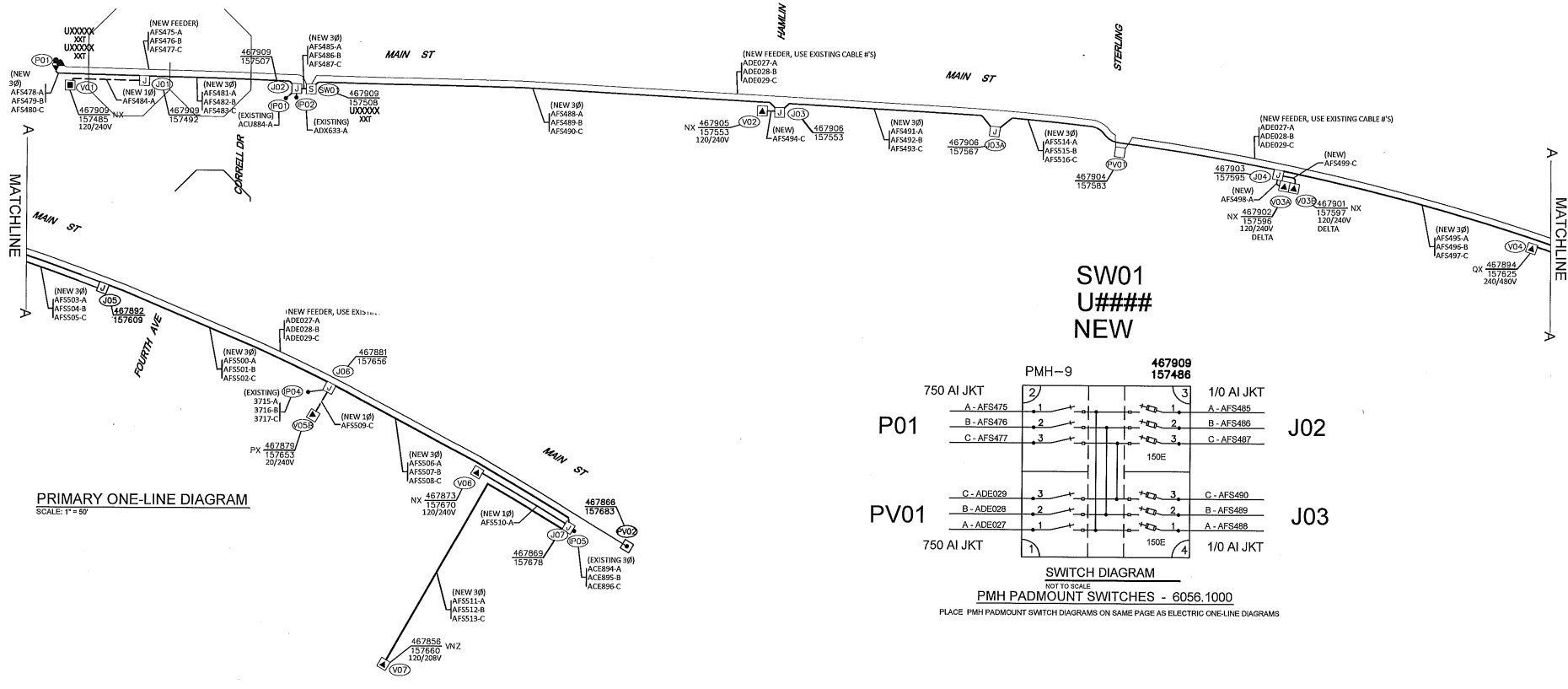

PRIMARY ONE-LINE DIAGRAM
SCALE: 1" = 50'

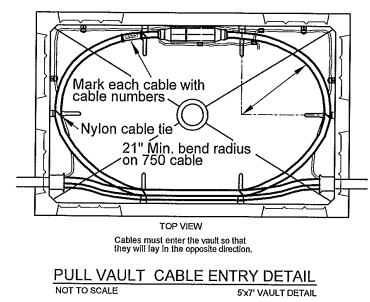
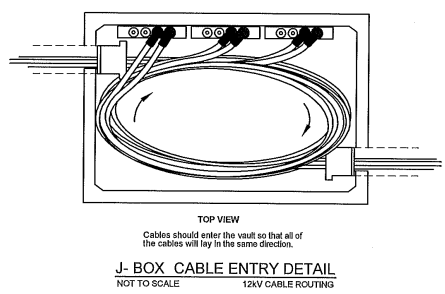
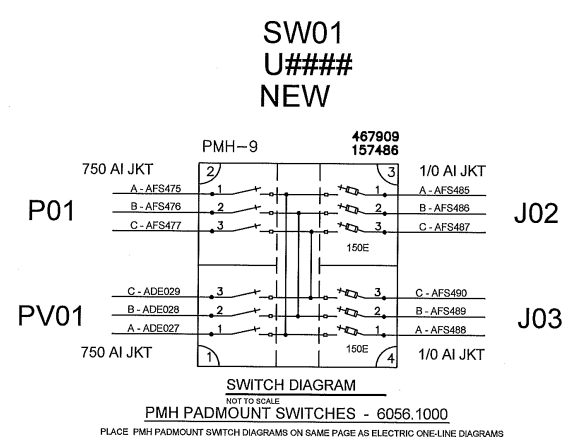

PRELIMINARY
NOT FOR
CONSTRUCTION

REAL ESTATE BROKER		PERMIT	
3	2	FUNCTION	CONTACT
1		DESIGNER	Jason Downing (360) 661-2967 4500/C
		INSPECTOR	Jason Downing (360) 661-2967 4500/C
		CHECKED BY	N/A
		APPROVED BY	Javier Valdez (360) 661-3870 4500/C
		FOREMAN #1	
		FOREMAN #2	
JOINT FACILITIES ARRANGEMENTS			
UTILITIES	Black Rock Cable	Cascade Natural Gas	Corral
CONTACT	Randy Wilson	Glendon VanCortsh	Bill Inema
PHONE#	(360) 336-0466	(360) 691-3099	(360) 816-6354
PUGET SOUND ENERGY Main Street Sch .74 Overhead to Underground Conversion Main St. between Carrell Dr. & 3rd Ave., Ferndale			Verdon 3200/7501.7 INCIDENT N/A S&S Order N/A Eject Order 101063873 SCALE 1" = 50'

D:\Projects\0600\dwg\Received\PS&E\5-4-10\INTOLIGHT\060018_SPL_8-4-10\02004.dwg_PG1_8/5/2010 3:48:22 PM

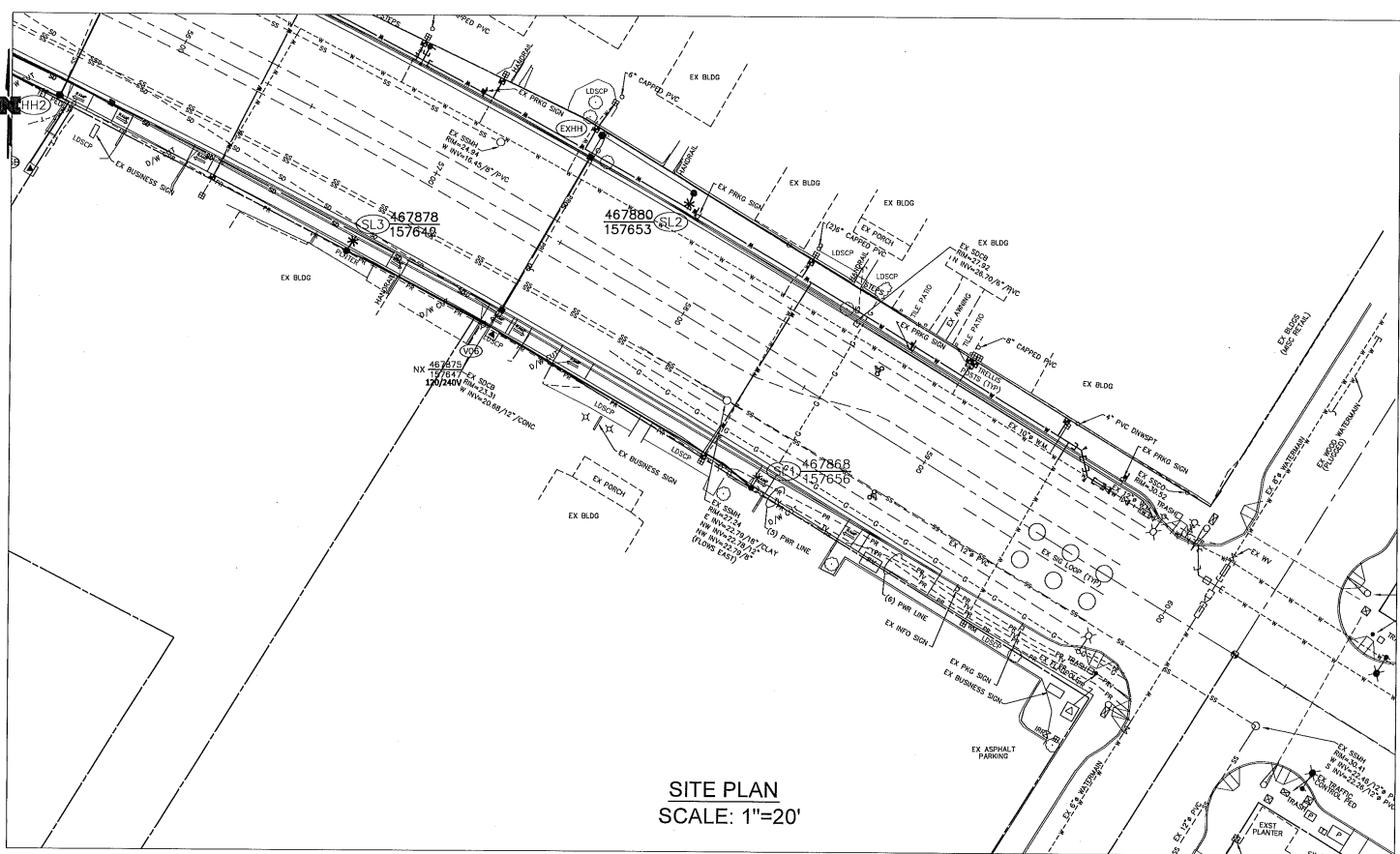

SITE PLAN
SCALE: 1"=20'

INTOLIGHT STREET LIGHT NOTES

- POTELCO:**
1. ALL STREET LIGHTING POLES ARE TO BE INSTALLED PER STANDARD 6375.4800 (page #2) IN THE "LINE WORK PRACTICES MANUAL".
 2. ALL POLES (WOOD, CONCRETE OR FIBERGLASS) ARE TO BE SET PLUMB AND EMBEDDED TO THE GROUND LINE MARKED ON THE POLE.
 3. BACKFILL AROUND POLE WITH 5/8" MINUS GRAVEL AND COMPACT IN 6" LIFTS. (PEA GRAVEL AND NATIVE SOILS ARE NOT ACCEPTABLE.) APPROXIMATELY 1 CU. YD. OF 5/8" MINUS RUSHED ROCK WILL BE REQUIRED.
 4. IN ALL SHOEBOX AND COBRAHEAD INSTALLATIONS, THE LUMINAIRE MUST BE LEVELED.

- DEVELOPER/CUSTOMER:**
1. THE DEVELOPER IS REQUIRED TO SUPPLY AND INSTALL PLASTIC (NON PAPER) STREET LIGHT TUBES (MINIMUM 18" DIAMETER) TO AID IN THE INSTALLATION OF THE STREET LIGHTING POLES.
 2. DEVELOPER MUST SUPPLY DURABLE LID/COVER AT EACH STREET LIGHT TUBE.

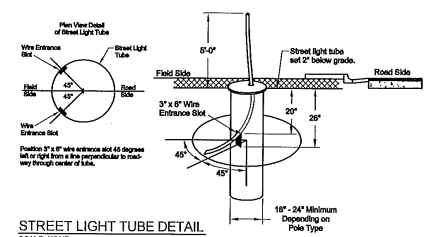

STREET LIGHT TUBE DETAIL
SCALE: NONE

FOREMAN (CHECK BOX WHEN COMPLETED)

PSE Equipment LSC/RESCUE/REPAIR & Work Area set to CLEAN/SAFE condition. Dual Chain, and Smith Formers UNLIDDED & UNWOUND.

Field Changes RECORDED on As-built.

Materials SPECIFIED and QUANTITIES noted on Paperwork.

Design/Construction Checked and Approved.

Contractors OK. ALL WORK IN ACCORD WITH Scope on As-built.

Include correct FIELD NOTES on ALL SHEETS, proper PLATES.

Correct SDC (including) provided.

Deviations noted on the As-built and their reason.

I certify that the work performed meets PSE standards and procedures and that all quality requirements are met.

Foreman's Signature _____ Date _____

PROJECT PHASE: NEW CORRECTIVE REPAIR

POLE	Supervisor	N/A	CREATED	N/A
	New CL Light	-	100005001	
	SL Light Head	-		
	Transformer	-		
	Transfer OH (Material)	-		
	N/A	-		
	N/A	-		
	N/A	-		
	N/A	-		
	N/A	-		
	N/A	-		
	N/A	-		
	N/A	-		
	N/A	-		

CABLE TV: YES NO

INTOLIGHT Contact Information: 306-664-3151 Please

Locales Required: YES NO

"Outages Required" YES NO

"Flagging Required" YES NO

ATTN: Luis Ponce-Reichardt and Ebo office

Job Site: _____

Owner / Developer Contact Info: _____

CITY OF FERNDAL CONTRACTOR TO PROVIDE ALL TRENCHING, SUPPLY AND INSTALL 2" CONDUIT, STUB UP AT ALL HANDHOLE LOCATIONS, SUPPLY AND INSTALL STREET LIGHT TUBES.

PSE/INTOLIGHT TO PROVIDE COMPOSITE HANDHOLES, CITY OF FERNDAL CONTRACTOR TO INSTALL ALL HANDHOLES.

INTOLIGHT/PSE CONTRACTOR, POTELCO, TO PULL IN NEW #6 UG TPX TO ALL HH & STREET LIGHT LOCATIONS & INSTALL ALL STREET LIGHT POLES, BISHOPS CROOK ARMS AND HEADS.

INTOLIGHT Contact Information: 306-664-3151 Please

Locales Required: YES NO

"Outages Required" YES NO

"Flagging Required" YES NO

ATTN: Luis Ponce-Reichardt and Ebo office

For contacts below dial 1-888-CALL PSE (225-9777) CALL (800) 414-48

2 BUSINESS DAYS BEFORE YOU'D

THIS IS NOT A CONTRACT. FOR A COMPLETE LIST OF SERVICES AND FEES, PLEASE REFER TO THE INTOLIGHT CONTRACT.

PROJECT PHASE	DATE	CORRECTIVE / 10 DAY WAIVED	REAL ESTATE/ASSESSMENT	PERMIT	FUNCTION	CONTACT	PHONE NO	DATE
1					ACCOUNT MGR	Shirley Clarke	426-626-2701	8/20/11
2					ENGR - POWER	Bryan Walters	426-730-9100	5/20/11
3					ENGR - GAS	Bryan Walters	426-730-9100	5/20/11
4					DRIVEN BY	Bryan Walters	426-730-9100	5/20/11
5					CHECKED BY			
6					APPROVED BY			
7					FOREMAN #1			
8					FOREMAN #2			
9					DRAFTING			

UTILITIES	CONTACT	PHONE	ADDRESS	INCIDENT	MAP
N/A	N/A	N/A	N/A	N/A	N/A
N/A	N/A	N/A	N/A	N/A	N/A
N/A	N/A	N/A	N/A	N/A	N/A

PSI PUJET SOUND ENERGY

FERNDAL 3RD & MAIN
NEW STREET LIGHT INSTALLATION
MAIN ST. FROM 3RD AVE TO CORNELL, FERNDAL, WA 98278

DESIGNED BY: INTOLIGHT

SCALE: 1" = 20'

PAGE: 1/7

P:\Projects\08018.dwg\Receive\PESE3-6-10-INT\LIGHT\08018_SP1-8-4-10_V2004.dwg_PG2_8/5/2010_3:48:42 PM

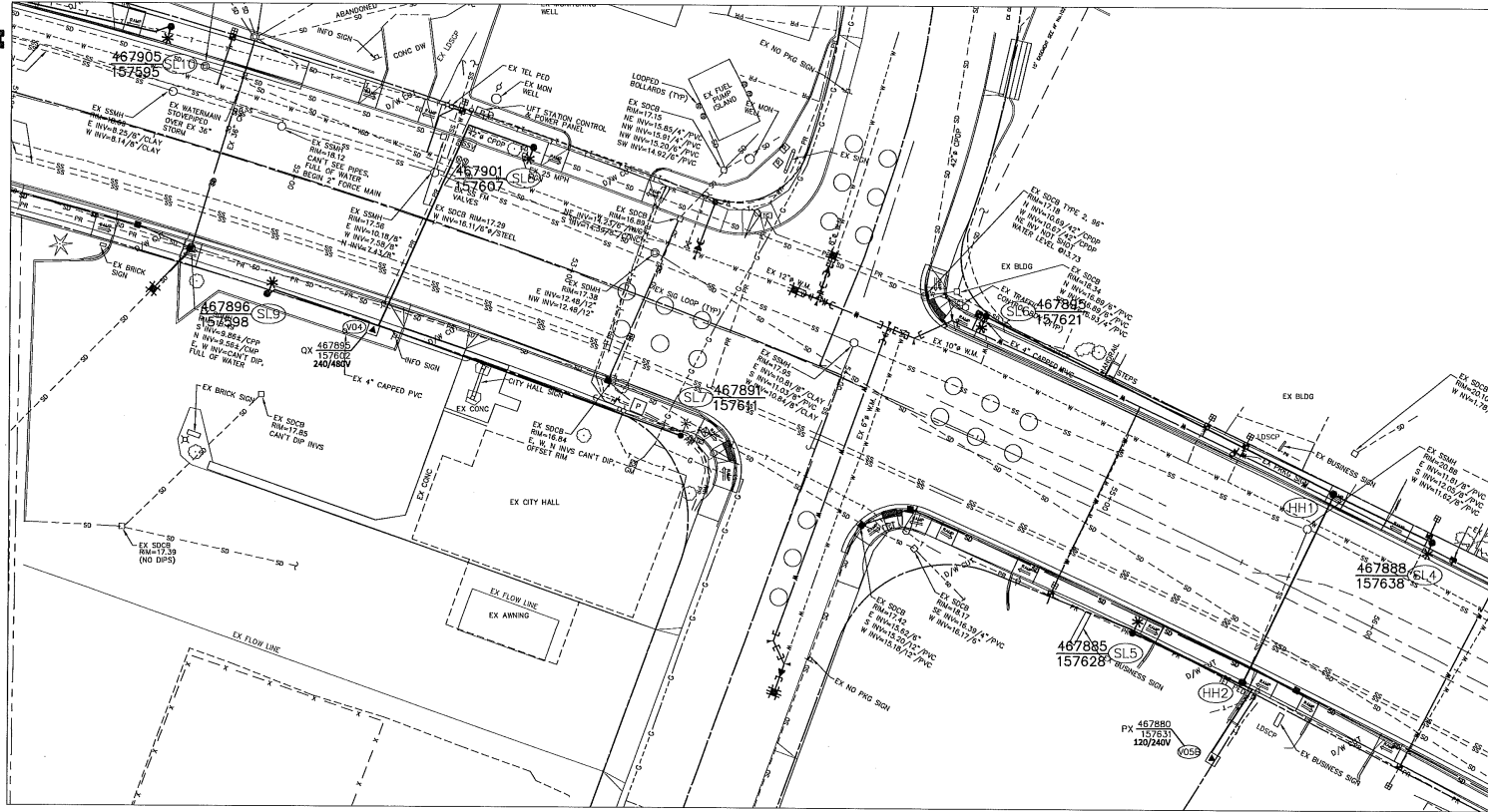

SITE PLAN
SCALE: 1"=20'

For contacts below dial 1-888-CALL PSE (225-5773) © CALL (800) 424-66

"Locales Required" No Yes ESB Yes No "Outlets Required" Yes No "Single Reuse" Yes No 2 BUSINESS DAYS BEFORE YOU D

THIS PROJECT IS TO BE REVIEWED BY EACH AGENCY TO EXISTING FACILITIES

<input checked="" type="checkbox"/>	NEW BUSINESS	<input type="checkbox"/>	CORRECTIVE / 15 DAY WAIVED	REAL ESTATE/RESEMENT	PERMIT
3				FUNCTION	CONTACT
2				ACCOUNT MGR	PHONE NO. DATE
1				ENGR - POWER	Bryan Waters 425-726-9100 8/04/11
NEW	BY	DESCRIPTION		SIGNER - GAS	DATE
COUNTY	Green Sect	Gas V&C	POWER WK CTR	DRAWN BY	Bryan Waters 425-726-9100 8/04/11
N/A	OP MAP	PLAT MAP		CHECKED BY	
N/A				APPROVED BY	
U&M PD (POWER)	OH CRT MAP	UG CRT MAP	CIRCUIT NO	FOREMAN #1	
N/A				FOREMAN #2	
				MAPPING	
UTILITY FACILITIES ARRANGEMENTS					
UTILITIES	N/A			N/A	N/A
CONTRACT	N/A			N/A	N/A
PROCES	N/A			N/A	N/A
INCIDENT MAP					
PSJ PUCET SOUND ENERGY					
FERNDALE 3RD & MAIN					
NEW STREET LIGHT INSTALLATION					
MAIN ST. FROM 3RD AVE TO CORRELL, FERNDALE, WA 98274					
				663 CHRT	ENR3 CHRT
				SCALE	PIECE
				1" = 20'	27

D:\Projects\06018.dwg\Receive\PSL18-4-10-V2004.dwg_COND_LAYOUT-8/5/2010 4:09:11 PM

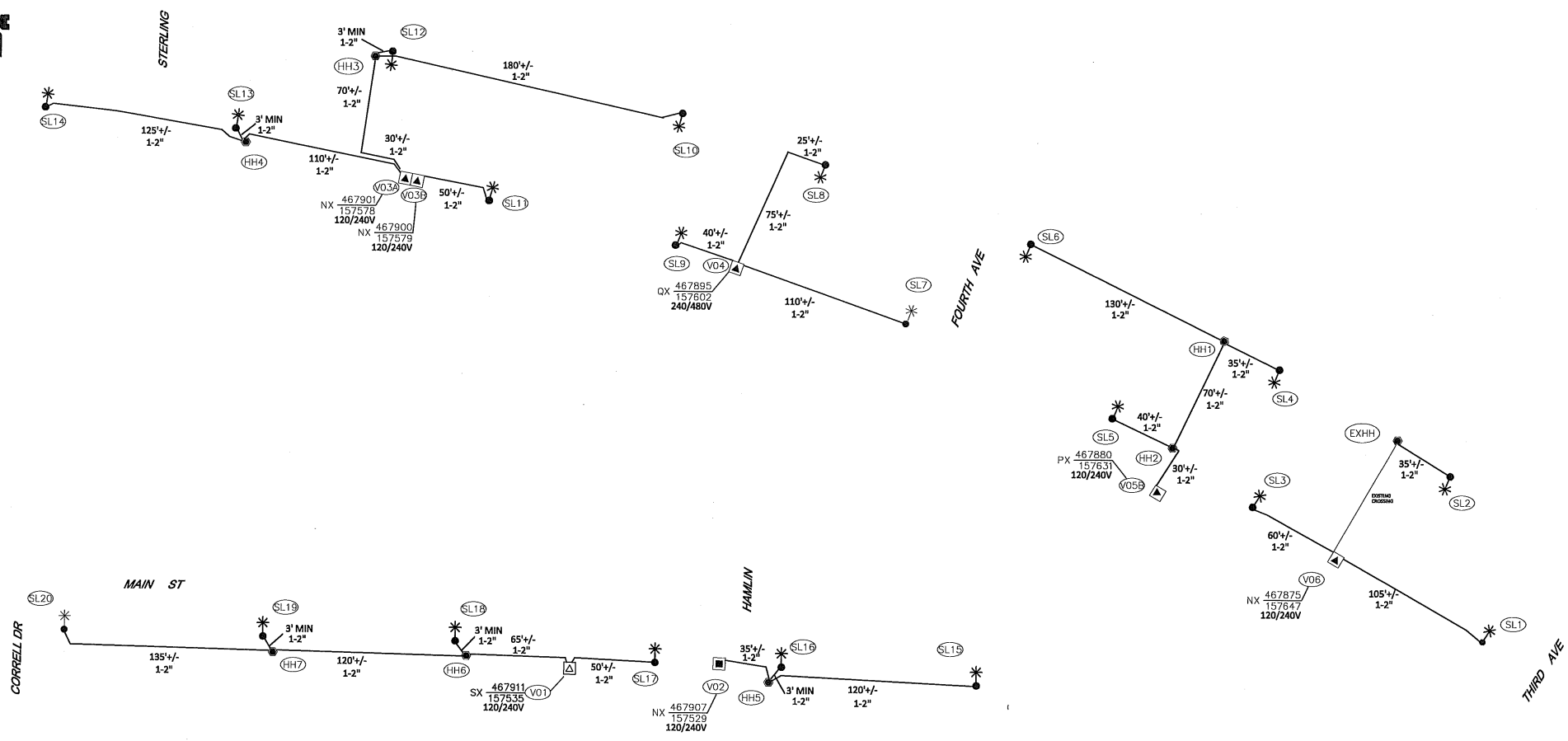

CONDUIT LAYOUT
N.T.S

"Locales Required"		Standard	Yes	ESL	For contacts below dtd 1-888-CALL P&E (225-5773) CALL (800) 484-66	
"Dedicated Required"		No	Yes	ESL	2 BUSINESS DAYS BEFORE YOU D	
"Bidding Required"		No	Yes	ESL	THIS SHEET MUST BE REVIEWED FOR EACH LOCATION OF THE PROJECT	
<input checked="" type="checkbox"/>	NEW BUSINESS	<input type="checkbox"/>	CORRECTIVE / 10 DAY WAIVED	<input type="checkbox"/>	REAL ESTATE/ASSESSMENT	PERMIT
3					FUNCTION	CONTACT
2					ACCOUNT MGR	PHONE NO DATE
1					ENGR - POWER	Bryan Waters 425-735-0109 ESD#1
ENR	BY	DESCRIPTION	ENGR - GAS	DRAWN BY	Bryan Waters	425-735-0109 ESD#1
COUNTRY	Emr Svc	Draw Vw Ctr	POWER Vw CTR	CHECKED BY	FOREMAN #1	
N/A	N/A	N/A	N/A	APPROVED BY	FOREMAN #2	
PL SEC	OP MAP	PLAT MAP			MAPPING	
(U/MAP NO (POWER)	CH CKT MAP	UG CKT MAP	CIRCUIT NO			
N/A	N/A	N/A	N/A			
UTILITIES						
CONTACT	N/A	N/A	N/A	N/A	N/A	N/A
PHONES	N/A	N/A	N/A	N/A	N/A	N/A
	FERNDALE 3RD & MAIN					INCIDENT
	NEW STREET LIGHT INSTALLATION					MAP
MAIN ST. FROM 3RD AVE TO CORNELL, FERNDALE, WA 98278					6/5 0/00	ENR 0/00
DESIGNED BY: BNOTLIGHT					SCALE	1/6500000
					N.T.S.	67

STREET LIGHT NOTES

Special Notes-

Site #	Station Offset	POLE				HEAD				TUBE	
		Grid #	IntoLight Tag #	Type	Mtg Ht	Arm	Watts	Style	Tube Length	Tube Diameter	
SL1		467898-167656		OCT CONC AMS GRN WITENON	25'	BISHOPS CROOK	200W	King K204, Viscoun drop-lens dk gm	5'	18"	
SL2		467898-167653		OCT CONC AMS GRN WITENON	25'	BISHOPS CROOK	200W	King K204, Viscoun drop-lens dk gm	5'	18"	
SL3		467878-167642		OCT CONC AMS GRN WITENON	25'	BISHOPS CROOK	200W	King K204, Viscoun drop-lens dk gm	5'	18"	
SL4		467888-167638		OCT CONC AMS GRN WITENON	25'	BISHOPS CROOK	200W	King K204, Viscoun drop-lens dk gm	5'	18"	
SL5		467896-167628		OCT CONC AMS GRN WITENON	25'	BISHOPS CROOK	200W	King K204, Viscoun drop-lens dk gm	5'	18"	
SL6		467896-167621		OCT CONC AMS GRN WITENON	25'	BISHOPS CROOK	200W	King K204, Viscoun drop-lens dk gm	5'	18"	
SL7		467891167611		OCT CONC AMS GRN WITENON	25'	BISHOPS CROOK	200W	King K204, Viscoun drop-lens dk gm	5'	18"	
SL8		467801-167607		OCT CONC AMS GRN WITENON	25'	BISHOPS CROOK	200W	King K204, Viscoun drop-lens dk gm	5'	18"	
SL9		467896-167598		OCT CONC AMS GRN WITENON	25'	BISHOPS CROOK	200W	King K204, Viscoun drop-lens dk gm	5'	18"	
SL10		467906-167595		OCT CONC AMS GRN WITENON	25'	BISHOPS CROOK	200W	King K204, Viscoun drop-lens dk gm	5'	18"	
SL11		467898-167584		OCT CONC AMS GRN WITENON	25'	BISHOPS CROOK	200W	King K204, Viscoun drop-lens dk gm	5'	18"	
SL12		467909-167577		OCT CONC AMS GRN WITENON	25'	BISHOPS CROOK	200W	King K204, Viscoun drop-lens dk gm	5'	18"	
SL13		467903-167568		OCT CONC AMS GRN WITENON	25'	BISHOPS CROOK	200W	King K204, Viscoun drop-lens dk gm	5'	18"	

STREET LIGHT NOTES

Special Notes-

Site #	Station Offset	POLE				HEAD				TUBE	
		Grid #	IntoLight Tag #	Type	Mtg Ht	Arm	Watts	Style	Tube Length	Tube Diameter	
SL14		467906-167555		OCT CONC AMS GRN WITENON	25'	BISHOPS CROOK	200W	King K204, Viscoun drop-lens dk gm	5'	18"	
SL15		467907-167543		OCT CONC AMS GRN WITENON	25'	BISHOPS CROOK	200W	King K204, Viscoun drop-lens dk gm	5'	18"	
SL16		467907-167528		OCT CONC AMS GRN WITENON	25'	BISHOPS CROOK	200W	King K204, Viscoun drop-lens dk gm	5'	18"	
SL17		467911-167540		OCT CONC AMS GRN WITENON	25'	BISHOPS CROOK	200W	King K204, Viscoun drop-lens dk gm	5'	18"	
SL18		467912-167528		OCT CONC AMS GRN WITENON	25'	BISHOPS CROOK	200W	King K204, Viscoun drop-lens dk gm	5'	18"	
SL19		467909-167496		OCT CONC AMS GRN WITENON	25'	BISHOPS CROOK	200W	King K204, Viscoun drop-lens dk gm	5'	18"	
SL20		467909-167484		OCT CONC AMS GRN WITENON	25'	BISHOPS CROOK	200W	King K204, Viscoun drop-lens dk gm	5'	18"	
SL21		467909-167648		EXISTING WOOD	25'	0'	200W	CHFL	N/A	N/A	

Street Light Wire & Conduit Table

LOCATION	#6 UG TPX		2" GREY PVC		BENDS				
	Size	Design Length	Size	Qty	Design Length	90°	45°	22°	11°
from	to	(in)	(ft)	(in)	(ft)				
V06	SL1	#6	115'	2	1 105'	2			
EXHH	SL2	#6	45'	2	1 35'	2			
V06	SL3	#6	70'	2	1 60'	2			
V05B	HH2	#6	40'	2	1 30'	3			
HH2	HH1	#6	80'	2	1 70'	2			
HH2	SL5	#6	50'	2	1 40'	2			
HH1	SL4	#6	45'	2	1 35'	2			
HH1	SL6	#6	140'	2	1 130'	2			
V04	SL7	#6	120'	2	1 110'	2			
V04	SL9	#6	50'	2	1 40'	2			
V04	SL8	#6	110'	2	1 100'	3			
V03B	SL11	#6	60'	2	1 50'	2			
V03A	HH3	#6	110'	2	1 100'	2			
HH3	SL10	#6	190'	2	1 180'	2			
HH3	SL12	#6	10'	2	1 5'	2			
V03A	HH4	#6	120'	2	1 110'	2			
HH4	SL13	#6	10'	2	1 5'	2			
HH4	SL14	#6	135'	2	1 125'	2			
V02	HH5	#6	45'	2	1 35'	2			
HH5	SL16	#6	10'	2	1 5'	2			
HH5	SL15	#6	130'	2	1 120'	2			
V01	SL17	#6	60'	2	1 50'	2			
V01	HH6	#6	75'	2	1 65'	2			
HH6	SL18	#6	10'	2	1 5'	2			
HH6	HH7	#6	130'	2	1 120'	2			
HH7	SL19	#6	10'	2	1 5'	2			
HH7	SL20	#6	145'	2	1 135'	2			

TOTAL #6 TPX = 2,090'

TOTAL 2" CONDUIT = 1,840'

STREET LIGHT HANDHOLE TABLE

Site	Pedestal or Handhole	Number of Positions Required	Remarks
HH1	COMP HH	3	
HH2	COMP HH	3	
HH3	COMP HH	3	
HH4	COMP HH	3	
HH5	COMP HH	3	
HH6	COMP HH	3	
HH7	COMP HH	3	

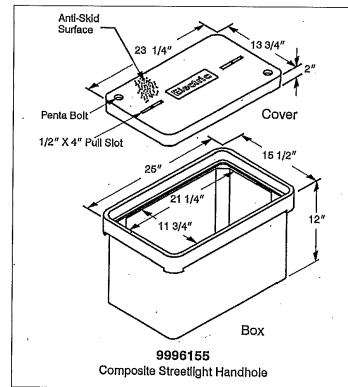

P:\Projects\08018.dwg\Received\PS&S-4-10-V2004.dwg-TABLES-8/5/2010-10:31-PM

For contacts below dial 1-888-CALL PSE (235-9378) CALL (800) 424-4545 2 BUSINESS DAYS BEFORE YOU D

THE PROJECT IS NOT TO BE RELEASED OR FOR CONSTRUCTION WITHOUT THE SIGNATURE OF THE PROJECT MANAGER

NEW BUSINESS	<input checked="" type="checkbox"/>	CORRECTIVE / 10 DAY WARRANTY	<input type="checkbox"/>
FUNCTION	N/A	CONTACT	N/A
ACCOUNT MGR	Shel Gaskin	PHONE NO	425-426-2751
ENGR - POWER	Bryan Walters	425-736-9100	BOOK1
ENGR - GAS			
CITY	Gen WA CV	POWER W/C CTR	
DRAWN BY	Bryan Walters	425-736-9100	BOOK1
CHECKED BY			
APPROVED BY			
FOREMAN #1			
FOREMAN #2			
MAPPING			

JOINT FACILITIES ARRANGEMENTS			
UTILITIES	N/A	N/A	N/A
CONTACT	N/A	N/A	N/A
PHONE	N/A	N/A	N/A

INCIDENT	MAJOR
SCALE	N.T.S.
PAGE	7/7

DESIGNED BY: INOTLIGHT

FERNDALE 3RD & MAIN
NEW STREET LIGHT INSTALLATION
MAIN ST. FROM 3RD AVE TO CORRELL FERNDALE, WA 98278