



Reichhardt & Ebe
ENGINEERING INC

TRANSMITTAL SHEET

Date sent: Friday, March 17, 2017
Sent to: All Planholders
Deliver to: Project Estimator
Transmission sent from: Reichhardt & Ebe Engineering
Number of pages including this page: 5

CONFIRMATION OF RECEIPT OF ADDENDUM

PROJECT: PORTAL WAY OVERLAY PROJECT
CITY PROJECT NUMBER ST2015-07

**Please complete the following form and
email back to Reichhardt & Ebe Engineering, Inc. at
officeadmin@recivil.com as soon as possible.**

**Have you received Addendum No. 1 for the above-mentioned
project?**

☐ **YES, we received Addendum No. 1**

Signed: _____ **Dated:** _____

Company name (Please Print): _____



TRANSMITTAL SHEET

TO:

ALL BIDDERS

FROM:

Luis Ponce, P.E.

COMPANY:

DATE:

March 17, 2017

ADDRESS:

TOTAL NO. OF PAGES INCLUDING COVER:

5

RE:

City of Ferndale
Addendum 1
PORTAL WAY OVERLAY PROJECT
CITY PROJECT NUMBER ST2015-07

NOTES/COMMENTS:

To the attention of all bidders for the above project:

Please find the enclosed Addendum for the above referenced project.

The enclosed ADDENDUM is to be considered as much a part of the Contract Documents as if it were included in the body of the plans and specifications, and will be incorporated in and made a part of the contract when awarded and when formally executed.

The Bidder shall acknowledge in writing, on the bid form, this addendum in order to have the bid considered.

Luis Ponce, P.E.



ADDENDUM NO. 1
To the Contract Provisions for
CITY OF FERNDAL, WASHINGTON

PORTAL WAY OVERLAY PROJECT
CITY PROJECT NUMBER ST2015-07

ITEM 1

Plan Sheet 10

The type of planing and dimensions are noted on the Plan Sheet.

ITEM 2

Plan Sheet 19

The text calling out the type of planing was deleted as this is a paving plan sheet.

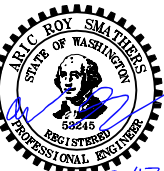
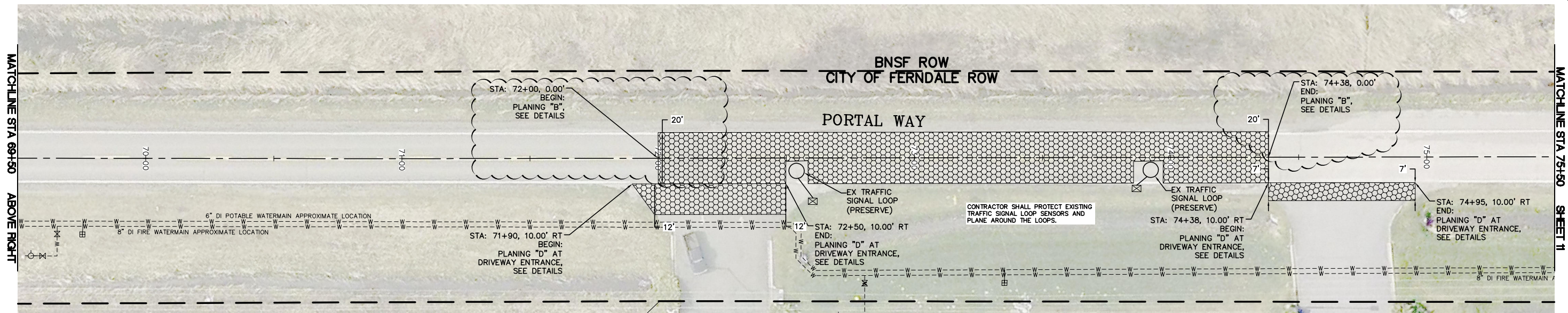
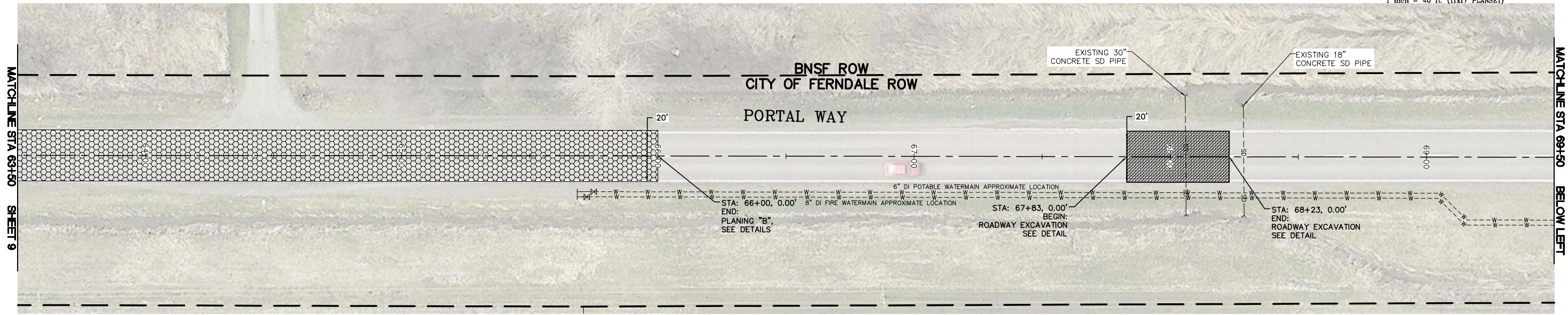
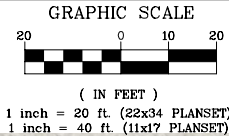

3/17/17

BID SET

DESIGNED BY
ARS
DRAWN BY
BLV
CHECKED BY
ARS



Reichhardt & Ebe
ENGINEERING INC

P.O. Box 978 | 423 Front Street, Lynden, WA 98264 (360) 354-3687
813 Metcalf Street, Sedro-Woolley, WA 98284 (360) 855-1713

NO.	DATE	DESCRIPTION	BY
1	3/17/17	ADDENDUM 1	ARS

CITY OF FERNDAL
2095 MAIN STREET
FERNDAL, WA 98248

PORTAL WAY OVERLAY PROJECT
NORTH ENTERPRISE ROAD TO GRANDVIEW ROAD
DEMO - STA. 63+50 TO 75+50

DWG 16016 BASEMAP

JOB#

16016

SCALE

H: 1"=20'

V: N/A

DATE

3/17/17

SHEET

10

of 22

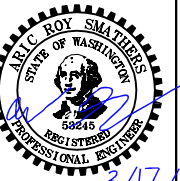
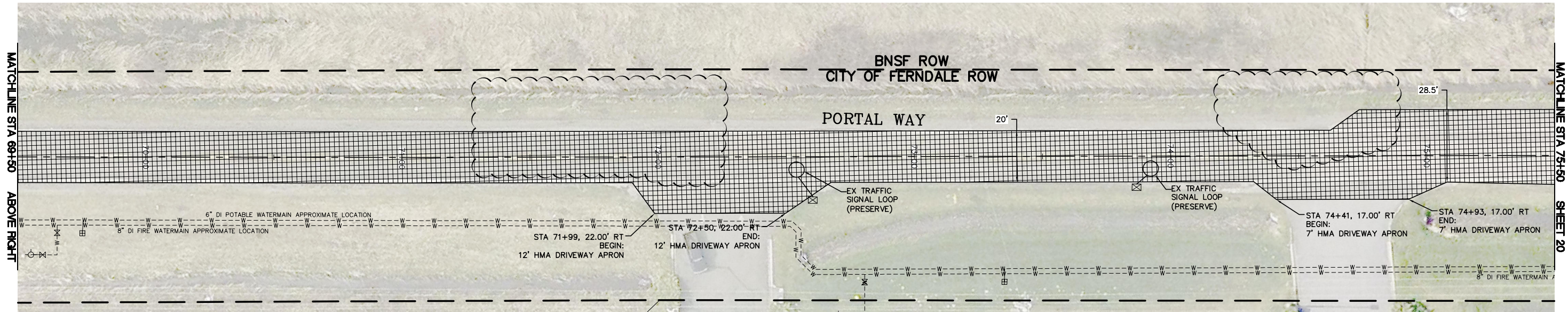
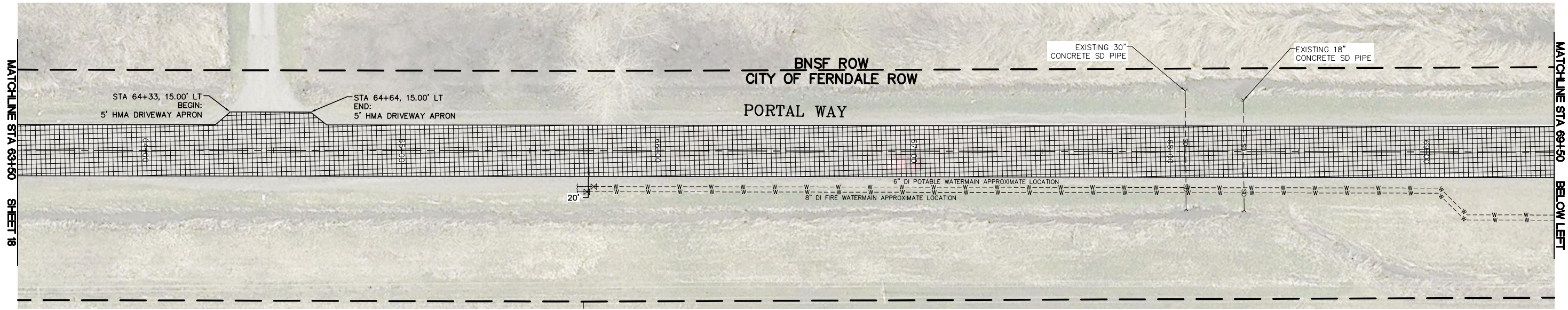
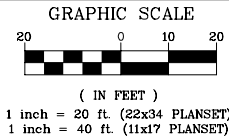

BID SET

DESIGNED BY
ARS
DRAWN BY
BLV
CHECKED BY
ARS

R&E Reichhardt & Ebe
ENGINEERING INC
P.O. Box 978 | 423 Front Street, Lynden, WA 98264 (360) 354-3687
813 Metcalf Street, Sedro-Woolley, WA 98284 (360) 855-1713

NO.	DATE	DESCRIPTION	BY
1	3/17/17	ADDENDUM 1	ARS

CITY OF FERNDAL
2095 MAIN STREET
FERNDAL, WA 98248

PORTAL WAY OVERLAY PROJECT
NORTH ENTERPRISE ROAD TO GRANDVIEW ROAD
PLAN - STA. 63+50 TO 75+50

DWG 16016 BASEMAP
JOB# 16016
SCALE H: 1"=20' V: N/A

DATE 3/17/17
SHEET 19
of 22