

PROJECT NO. SW2015-03

SHEET **1**
of 11

LEGEND

EXISTING	
	= EXISTING TOP OF BANK
	= EXISTING BOTTOM OF BANK
	= EXISTING DITCH CL
	= EXISTING GRADE BREAK
	= EXISTING MAJOR CONTOUR
	= EXISTING MINOR CONTOUR
	= EXISTING GUARDRAIL
	= EXISTING FENCE
	= EXISTING GRAVEL
	= EXISTING WALL
	= EXISTING BUILDING
	= EXISTING PROPERTY BOUNDARY
	= EXISTING RIGHT OF WAY
	= EXISTING RIGHT OF WAY CL
	= EXISTING EASEMENT
	= EXISTING ROAD CL
	= EXISTING WETLANDS BOUNDARY
	= EXISTING TRAFFIC STRIPING
	= EXISTING EDGE OF PAVEMENT
	= EXISTING FLOWLINE
	= EXISTING TOP BACK OF CURB
	= EXISTING SIDEWALK
	= EXISTING POWER BURIED
	= EXISTING OVERHEAD POWER
	= EXISTING COMMUNICATIONS BURIED
	= EXISTING OVERHEAD COMMUNICATIONS
	= EXISTING FIBER OPTICS BURIED
	= EXISTING TV BURIED
	= EXISTING TELEPHONE BURIED
	= EXISTING CONDUIT
	= EXISTING GAS MAIN
	= EXISTING WATER MAIN
	= EXISTING IRRIGATION LINE
	= EXISTING SANITARY SEWER FORCE MAIN
	= EXISTING SANITARY SEWER
	= EXISTING STORM DRAIN
	= EXISTING ORDINARY HIGH WATER
	= EXISTING CULVERT
	= EXISTING TREE LINE
	= EXISTING CONCRETE
	= EXISTING RR TRACKS

PROPOSED	
	= PROPOSED TOP OF BANK
	= PROPOSED TOE OF BANK
	= PROPOSED DITCH CL
	= PROPOSED GRADE BREAK
	= PROPOSED MAJOR CONTOUR
	= PROPOSED MINOR CONTOUR
	= PROPOSED GUARDRAIL
	= PROPOSED FENCE
	= PROPOSED GRAVEL
	= PROPOSED WALL
	= PROPOSED BUILDING
	= PROPOSED PAVEMENT VALLEY
	= PROPOSED RIGHT OF WAY
	= PROPOSED AUTOTURN
	= PROPOSED CONSTRUCTION EASEMENT
	= PROPOSED ROAD CL
	= PROPOSED SAWCUT
	= PROPOSED TRAFFIC STRIPE
	= PROPOSED ROAD EDGE OF PAVEMENT
	= PROPOSED CURB AND GUTTER
	= PROPOSED PATH
	= PROPOSED SIDEWALK
	= PROPOSED POWER LINE
	= PROPOSED ROCK WALL
	= PROPOSED PARKING STRIPE
	= PROPOSED TRAFFIC SIGNAL CONDUCTOR
	= PROPOSED FIBER OPTICS
	= PROPOSED SILT FENCE
	= PROPOSED CONDUIT
	= PROPOSED HANDRAIL
	= PROPOSED TEMPORARY CONSTRUCTION EASEMENT
	= PROPOSED IRRIGATION LINE
	= PROPOSED WATER MAIN
	= PROPOSED SANITARY SEWER FORCE MAIN
	= PROPOSED SANITARY SEWER
	= PROPOSED STORM DRAIN
	= PROPOSED CULVERT
	= PROPOSED TREE LINE
	= PROPOSED CONC. SIDEWALK/DRIVEWAY
	= PROPOSED INFILTRATION TRENCH
	= PROPOSED INFILTRATION FILTER MEDIA
	= PROPOSED GRIND
	= PROPOSED DEMOLITION AREA
	= PROPOSED ASPHALT
	= PROPOSED RIGHT OF WAY TAKE

EXISTING	
	= EXISTING SIGNAL POLE
	= EXISTING SIGNAL POLE W/ LUMINAIRE
	= EXISTING STREET LIGHT ASSEMBLY
	= EXISTING YARD LIGHT
	= EXISTING GUY WIRE
	= EXISTING GAS METER
	= EXISTING GAS VALVE
	= EXISTING TRANSFORMER PAD
	= EXISTING POWER VAULT
	= EXISTING JBOX
	= EXISTING SOIL BORING LOCATION
	= EXISTING MAIL BOX
	= EXISTING WATER SPIGOT
	= EXISTING WATER BLOW OFF
	= EXISTING WATER METER
	= EXISTING WATER VALVE
	= EXISTING FIRE HYDRANT
	= EXISTING TRAFFIC SIGNAL VAULT
	= EXISTING SEWER MANHOLE
	= EXISTING STORM DRAIN CATCH BASIN TYPE I
	= EXISTING STORM DRAIN CATCH BASIN TYPE II
	= EXISTING UTILITY POLE
	= EXISTING MONITORING WELL
	= EXISTING STORM CLEANOUT
	= EXISTING SEWER CLEANOUT
	= EXISTING SIGN
	= EXISTING TELEPHONE PEDESTAL
	= EXISTING COMMUNICATIONS VAULT
	= EXISTING BENCH MARK
	= EXISTING NAIL AND SHINER
	= EXISTING IRON PIPE
	= EXISTING MONUMENT (IN CASE)
	= EXISTING MONUMENT (SURFACE)
	= EXISTING ANGLE POINT
	= EXISTING TREE STUMP
	= EXISTING TREE
	= EXISTING VEGETATION

PROPOSED	
	= PROPOSED STORM DRAIN INLET
	= PROPOSED COUPLER
	= PROPOSED WATER METER
	= PROPOSED WATER VALVE
	= PROPOSED STORM DRAIN CATCH BASIN TYPE II
	= PROPOSED SANITARY SEWER MANHOLE
	= PROPOSED STORM DRAIN CATCH BASIN TYPE I
	= PROPOSED HYDRANT
	= PROPOSED UTILITY POLE
	= PROPOSED JBOX (TYPE I, II, III)
	= PROPOSED MONITORING WELL
	= PROP STORM CLEANOUT
	= PROPOSED SANITARY SEWER CLEAN OUT
	= PROPOSED SIGN
	= FLOW ARROW
	= PROPOSED TREE
	= SECTION MARK
	= EXISTING ELEVATION ● REFERENCED ALIGNMENT
	= PROPOSED ELEVATION ● REFERENCED ALIGNMENT
	= STATION

ABBREVIATIONS

Ø = DIAMETER	EVLS = END VERTICAL CURVE STATION	MOD = MODIFIED	S = SOUTH
AC = ASBESTOS CEMENT	EX, EXIST = EXISTING	MON = MONUMENT	SCH = SCHEDULE
AD = ALGEBRAIC DIFFERENCE	IR = EXISTING IRRIGATION	MPOC = MID-POINT ON CURVE	SD = STORM DRAIN
ASPH = ASPHALT	F&C = FRAME AND COVER	MTR = METER	SDCB = STORM DRAIN CATCH BASIN
BLDG = BUILDING	F&G = FRAME AND GRATE	MW = MONITORING WELL	SDMH = STORM DRAIN MANHOLE
BVCE = BEGIN VERTICAL CURVE ELEVATION	FF = FINISHED FLOOR	N = NORTH	SE = SOUTHEAST
BVCE = BEGIN VERTICAL CURVE STATION	FG = FINISHED GRADE	NE = NORTHEAST	SN = EXISTING SIGN
C&G = CURB & GUTTER	FL = FLOW LINE	NW = NORTHWEST	SP = STANDARD PLAN
CATV = CABLE TELEVISION	FT = FEET	OC = ON CENTER	SSMH = SANITARY SEWER MANHOLE
CDP = CONTROLLED DENSITY FILL	FT/FT = FEET PER FOOT	PC = POINT OF CURVATURE	STA = STATION
CL = GLASS, CENTERLINE	GALV = GALVANIZED	PCC = POINT OF COMPOUND CURVATURE,	STD = STANDARD
CMP = CORRUGATED METAL PIPE	GRVL = GRAVEL	PORTLAND CEMENT CONCRETE	SW = SOUTHWEST
CMU = CONCRETE MASONRY UNIT	GV = GATE VALVE	PED = PEDESTAL	TEL = TELEPHONE
COMP = COMPACTED	HDPE = HIGH DENSITY POLYETHYLENE	POC = POINT ON CURVE	TL = TRAFFIC LOOP
CON = CONIFER	HMA = HOT MIX ASPHALT	POSS = POSSIBLE	TYP = TYPICAL
CONC = CONCRETE	HP = HIGH POINT	PRC = POINT OF REVERSE CURVE	UP = UTILITY POLE
CONT = CONTOUR	HYD = HYDRANT	PROP = PROPOSED	UTIL = UTILITY
CPSSP = CORRUGATED POLYETHYLENE	IE, INV = INVERT ELEVATION	PT = POINT OF TANGENCY	VC = VERTICAL CURVE
STORM SEWER PIPE	IW = INJECTION WELL	PVC = POLYVINYL CHLORIDE	VLT = VAULT
CULV = CULVERT	L = LENGTH	PVI = POINT OF VERTICAL INTERSECTION	VPC = VERTICAL POINT OF CURVATURE
D/W = DRIVEWAY	LDCS = LANDSCAPING	PWR = POWER	VPI = VERTICAL POINT OF INTERSECTION
DEC = DECIDUOUS	LF = LINEAR FEET	R = RADIUS	VPT = VERTICAL POINT OF TANGENCY
DI = DUCTILE IRON	LOC = LOCATION	R&C = RING AND COVER	W = WEST
E = EASE	LP = LOW POINT	RET = RETAINING	WM = WATER METER
EOP, EP = EDGE OF PAVEMENT	LT = LEFT	ROW = RIGHT OF WAY	WSDOT = WASHINGTON STATE DEPARTMENT
EQUIV = EQUIVALENT	MAX = MAXIMUM	RT = RIGHT	OF TRANSPORTATION
EVCE = END VERTICAL CURVE ELEVATION	MIN = MINIMUM		XEOA = EXISTING EDGE OF ASPHALT

NOTES

1. FIELD WORK AND TOPOGRAPHIC SURVEY PERFORMED BY COMPASS POINT SURVEY, LLC, 523 FRONT ST., LYNDEN, WA.
2. HORIZONTAL DATUM: WASHINGTON STATE PLANE (NORTH) COORDINATES - NAD 83-2011, VERTICAL DATUM: NGVD 29
3. HERRINGBONE GRATES SHALL BE USED ON ALL STORM DRAIN STRUCTURE UNLESS OTHERWISE NOTED.
4. CATCH BASINS & MANHOLE CENTER OF STRUCTURE ORIENTATION RELATIVE TO FRAME & GRATE OR RING & COVER SHALL BE AS SHOWN ON THE PLANS.



6/15/17

BID SET

DESIGNED BY
DRAWN BY
CHECKED BY



Reichhardt & Ebe
ENGINEERING INC

P.O. Box 978 | 423 Front Street, Lynden, WA 98264 (360) 354-3687
813 Metcalf Street, Sedro-Woolley, WA 98284 (360) 855-1713

NO.	DATE	DESCRIPTION	BY

CITY OF FERNDALE
2095 MAIN STREET
FERNDALE, WA 98248

GATEWAY NORTH
ROADWAY AND UTILITIES IMPROVEMENT PROJECT
LEGEND AND ABBREVIATIONS

DWG 15021 COVER-GW

DATE

6/15/17

JOB#

15021

SCALE

H: N/A

V: N/A

SHEET

2

of 11

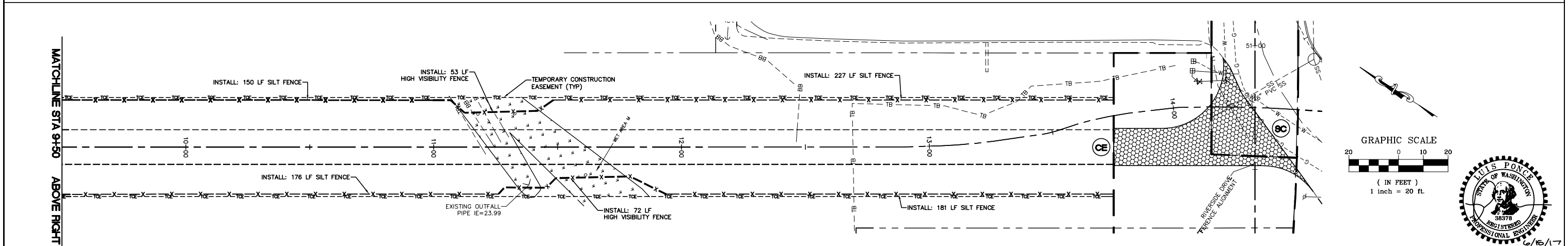
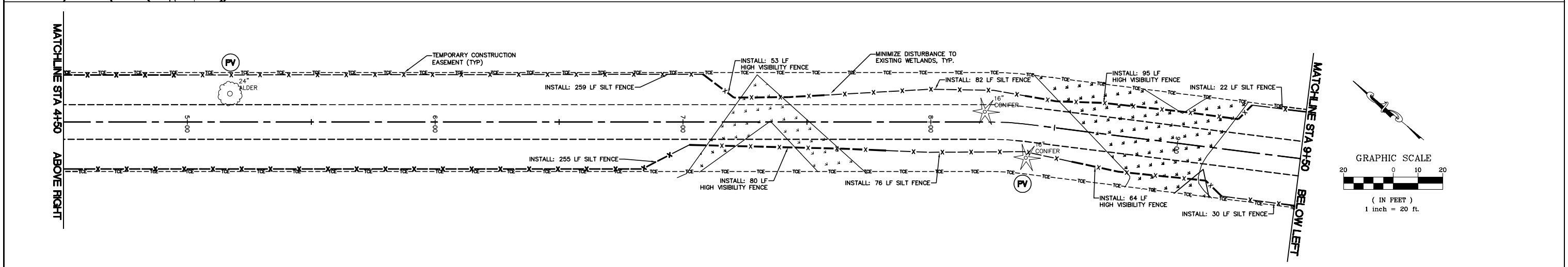
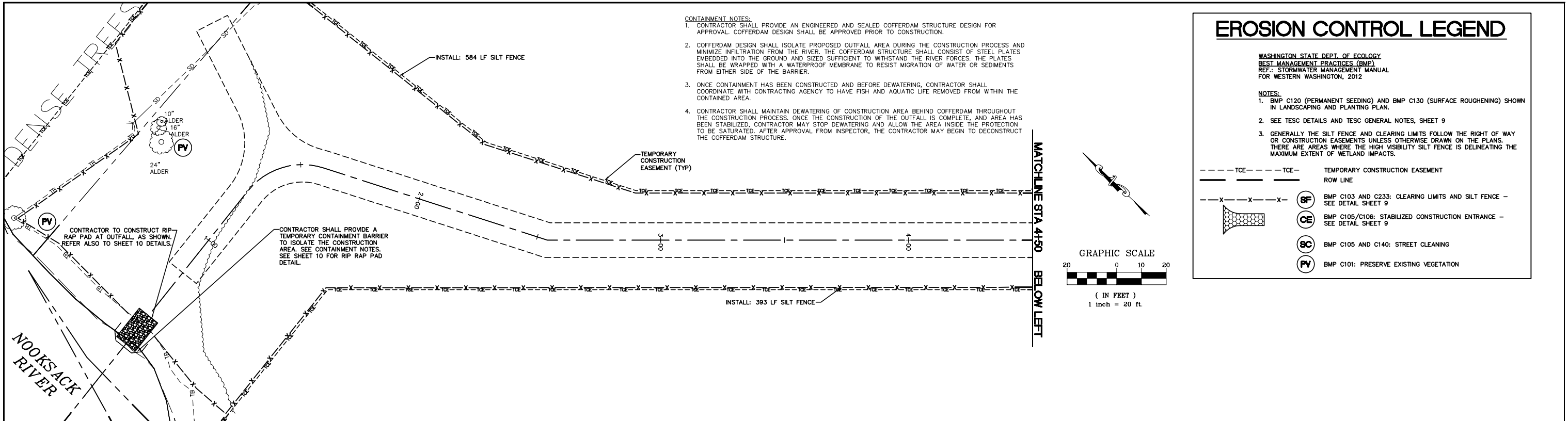

BID SET	DESIGNED BY BEK	<div><div><div>R&E</div><div>Reichhardt & Ebe</div><div>ENGINEERING INC</div></div><div>P.O. Box 978 423 Front Street, Lynden, WA 98264 (360) 354-3687 813 Metcalf Street, Sedro-Woolley, WA 98284 (360) 855-1713</div></div>					CITY OF FERNDAL 2095 MAIN STREET FERNDAL, WA 98248	GATEWAY NORTH EXISTING CONDITIONS TESC STA 0+00 TO 14+50	DWG 15021 EX COND TESC-GW	DATE 6/15/17	
	DRAWN BY RWG								JOB# 15021	SCALE H: 1"=20' V: N/A	SHEET 3 of 11
	CHECKED BY LP										
			NO.	DATE	DESCRIPTION	BY					

P:\Projects\15021\15. Civil\3D\01\Plans\Shores\GATEWAY\15021 EX COND TESC-GW.dwg 6/15/2017 10:26:17 AM

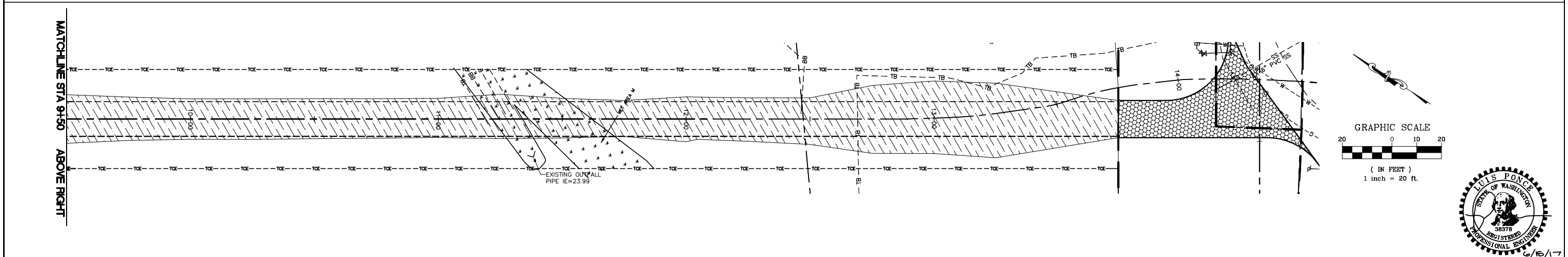
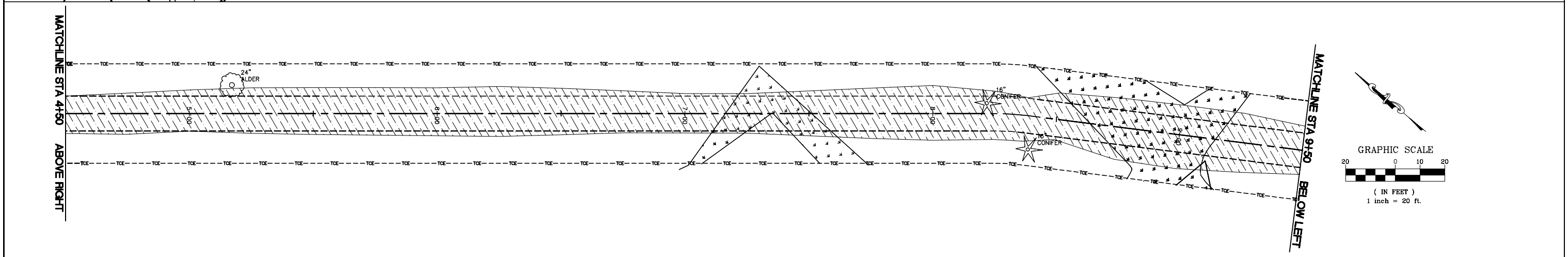
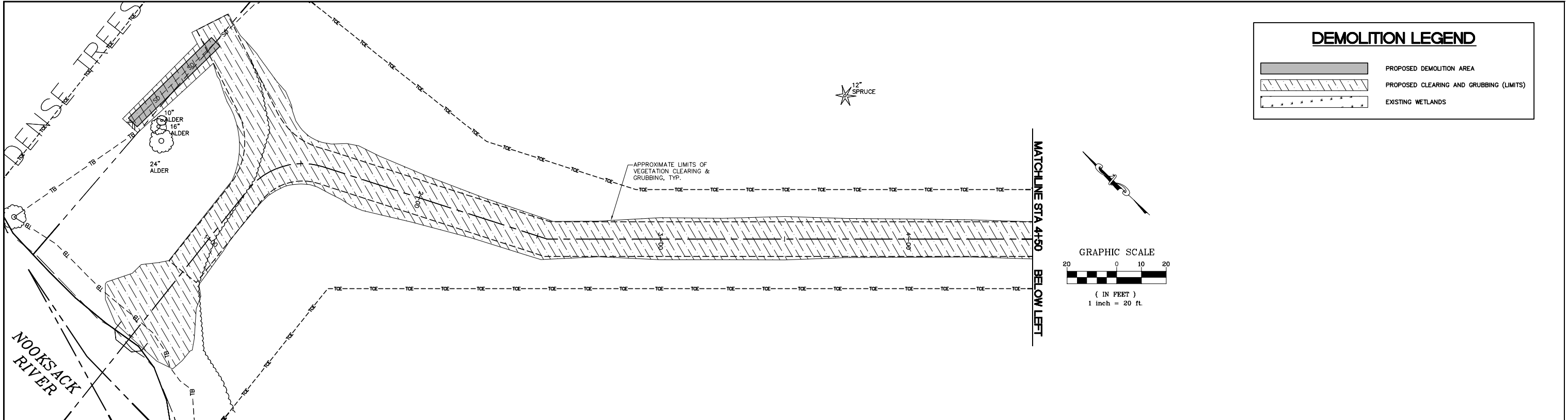

<div>BID SET</div>	DESIGNED BY BEK	<div><div>R&E</div><div>Reichhardt & Ebe ENGINEERING INC</div><div>P.O. Box 978 423 Front Street, Lynden, WA 98264 (360) 354-3687 813 Metcalf Street, Sedro-Woolley, WA 98284 (360) 855-1713</div></div>					CITY OF FERNDALE 2095 MAIN STREET FERNDALE, WA 98248	GATEWAY NORTH DEMO PLAN STA 0+00 TO 14+50	DWG 15021 DEMO-GW		DATE 6/15/17
	DRAWN BY RWG								JOB# 15021	SCALE H: 1"=20' V: N/A	SHEET 4 of 11
	CHECKED BY LP										
					NO.	DATE			DESCRIPTION	BY	

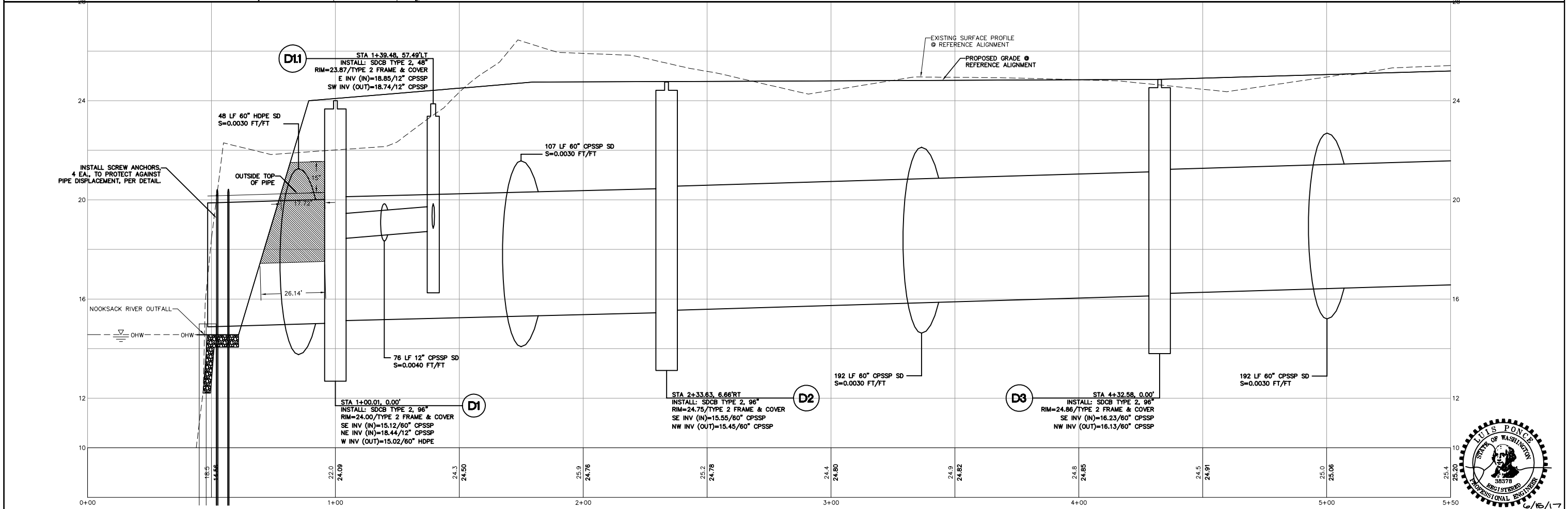
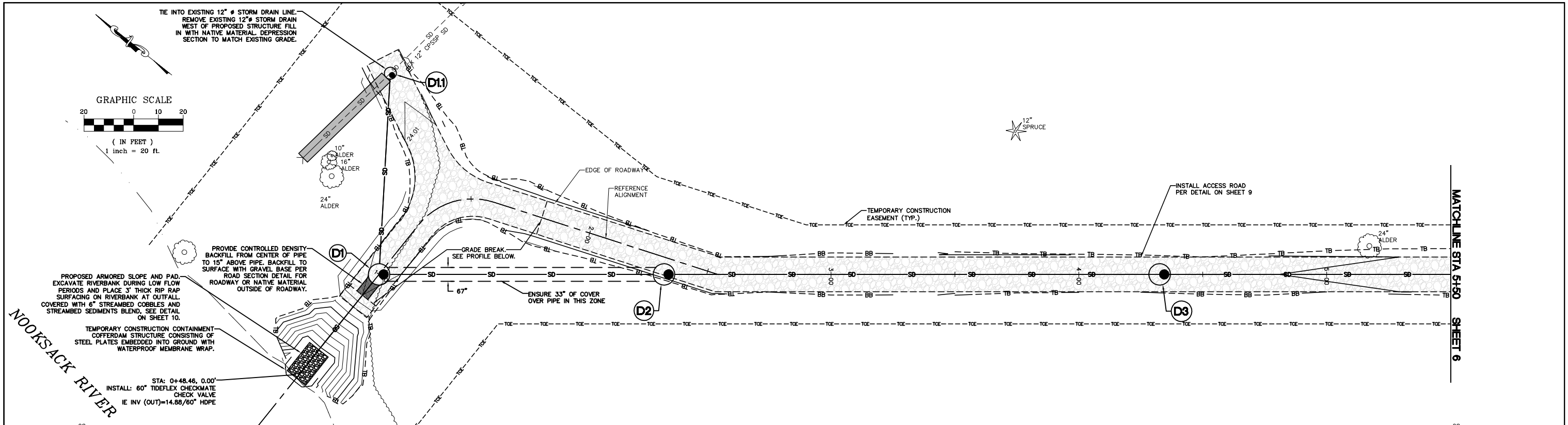

BID SET

DESIGNED BY
BEK
DRAWN BY
RWG
CHECKED BY
LP

R&E Reichhardt & Ebe
ENGINEERING INC
P.O. Box 978 | 423 Front Street, Lynden, WA 98264 (360) 354-3687
813 Metcalf Street, Sedro-Woolley, WA 98284 (360) 855-1713

NO.	DATE	DESCRIPTION	BY

CITY OF FERNDALE
2095 MAIN STREET
FERNDALE, WA 98248

GATEWAY NORTH
STORM - PLAN AND PROFILE
STA 0+00 TO 5+50

DWG	15021 STORM-GW	DATE	6/15/17
JOB#	15021	SCALE	H: 1"=20' V: 1"=2'
SHEET	5	of 11	

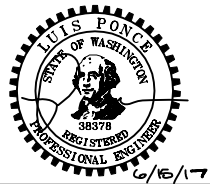
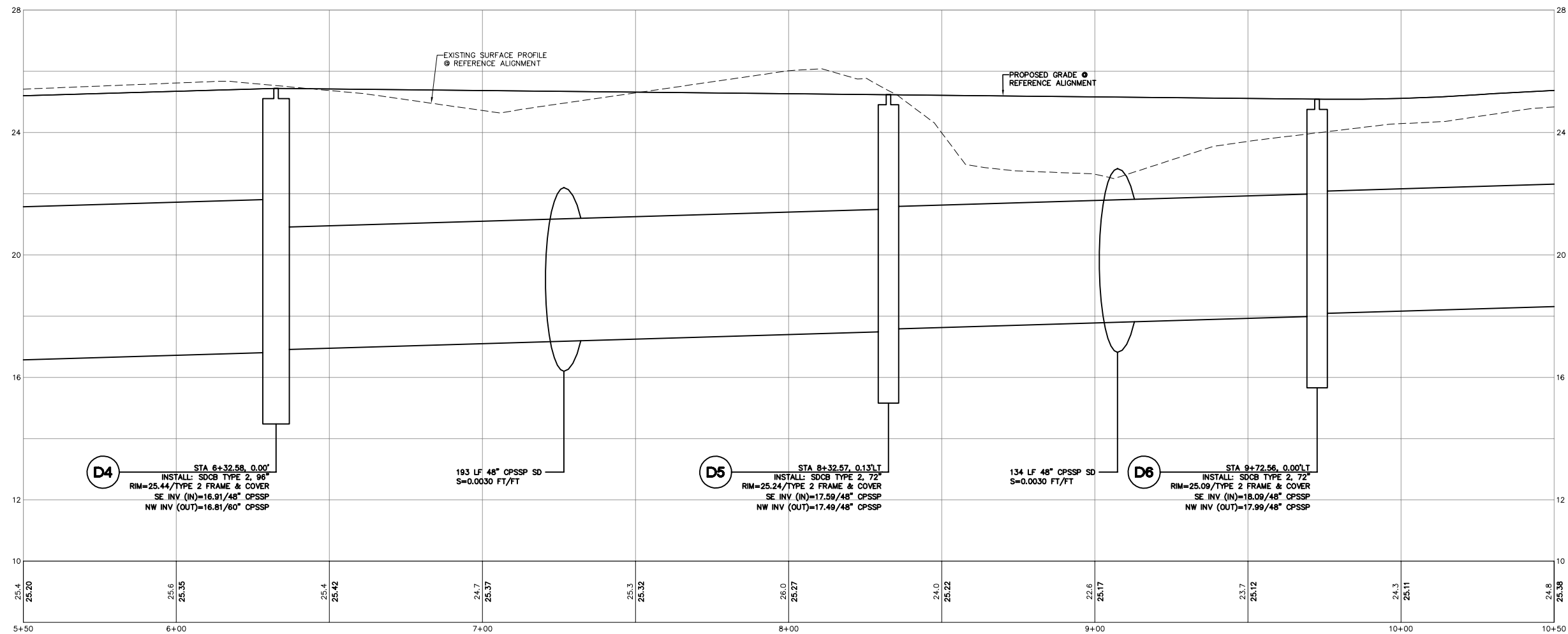
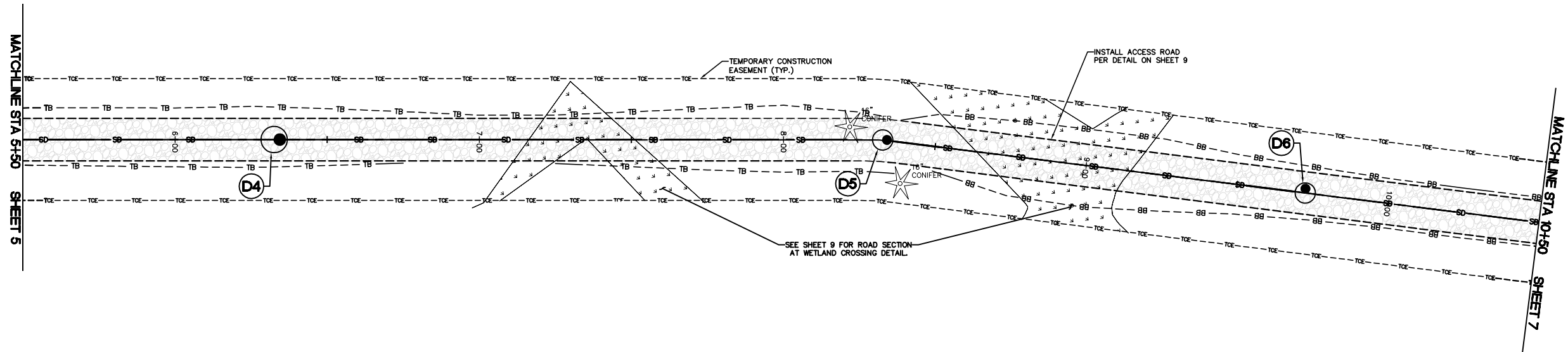
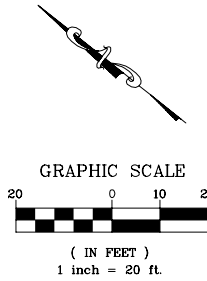

BID SET

DESIGNED BY
BEK
DRAWN BY
RWG
CHECKED BY
LP

R&E Reichhardt & Ebe
ENGINEERING INC
P.O. Box 978 | 423 Front Street, Lynden, WA 98264 (360) 354-3687
813 Metcalf Street, Sedro-Woolley, WA 98284 (360) 855-1713

NO.	DATE	DESCRIPTION	BY

CITY OF FERNDAL
2095 MAIN STREET
FERNDAL, WA 98248

GATEWAY NORTH
STORM - PLAN AND PROFILE
STA 5+50 TO 10+50

DWG 15021 STORM-GW	DATE 6/15/17
JOB# 15021	SCALE H: 1"=20' V: 1"=2'
SHEET 6 of 11	

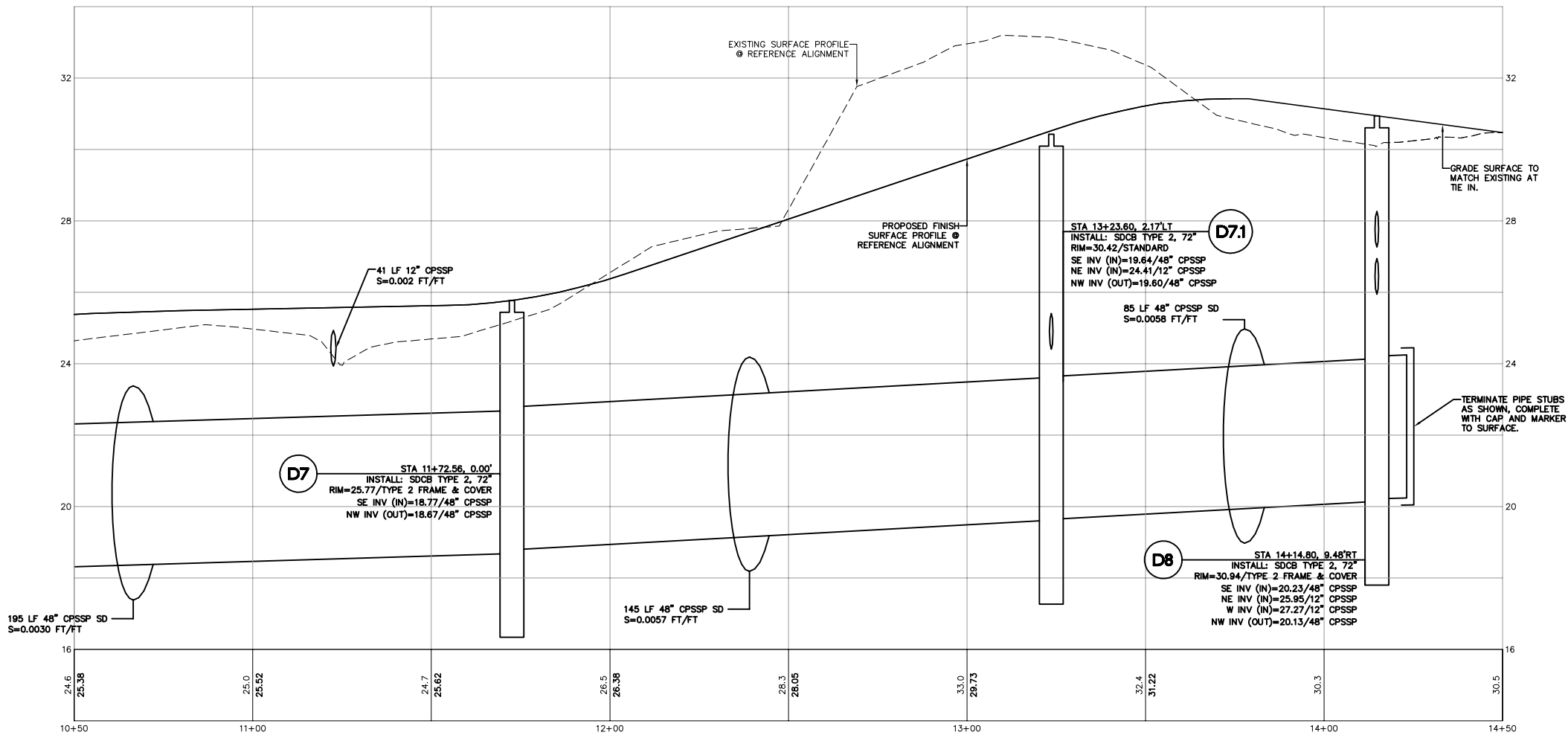
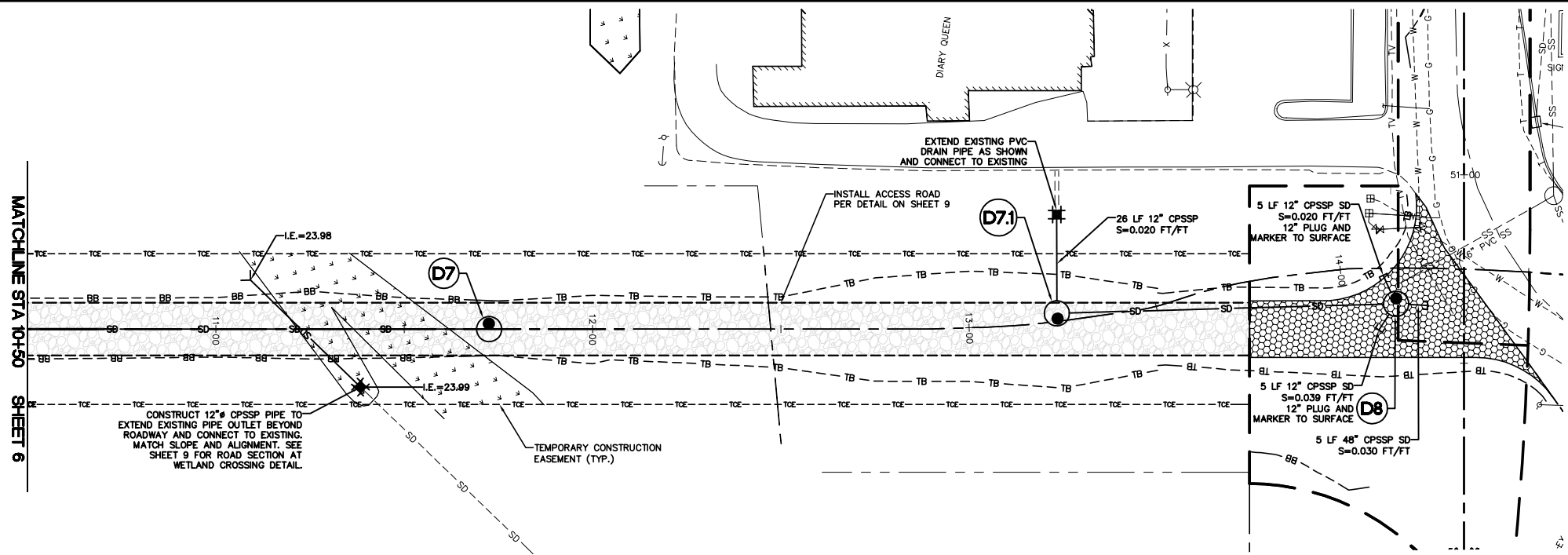
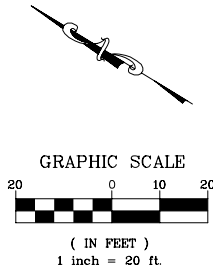

BID SET

DESIGNED BY
BEK
DRAWN BY
RWG
CHECKED BY
LP

R&E Reichhardt & Ebe
ENGINEERING INC
P.O. Box 978 | 423 Front Street, Lynden, WA 98264 (360) 354-3687
813 Metcalf Street, Sedro-Woolley, WA 98284 (360) 855-1713

NO.	DATE	DESCRIPTION	BY

CITY OF FERNDAL
2095 MAIN STREET
FERNDAL, WA 98248

GATEWAY NORTH
STORM - PLAN AND PROFILE
STA 10+50 TO 14+50

DWG 15021 STORM-GW

DATE 6/15/17

JOB#

15021

SCALE

H: 1"=20'

V: 1"=2'

SHEET

7

of 11

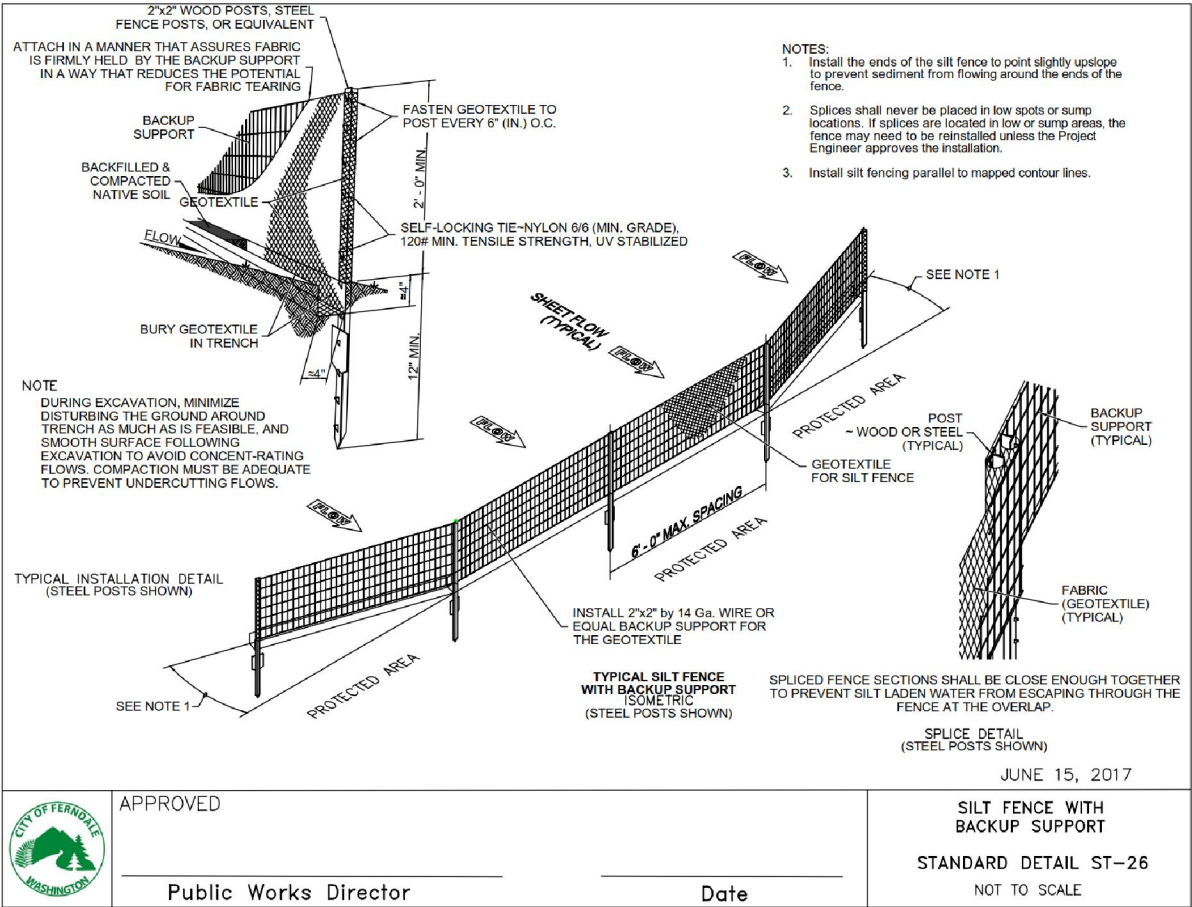
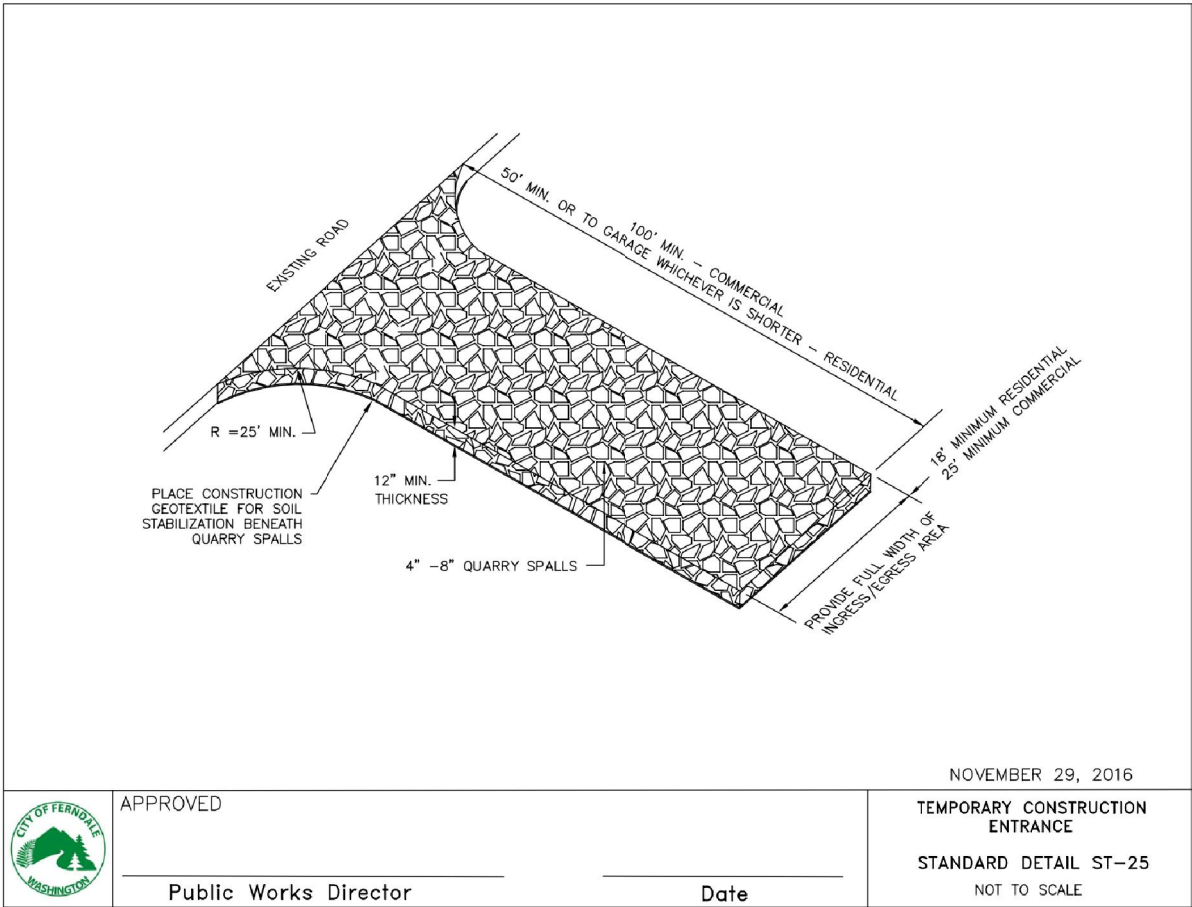

TESC GENERAL NOTES

- THIS PLAN REPRESENTS THE MINIMUM REQUIREMENTS FOR THIS PROJECT. ADDITIONAL EROSION CONTROL MAY BE REQUIRED BY THE ENGINEER AS ARE FOUND NECESSARY.
- THE TEMPORARY EROSION CONTROL SYSTEMS SHALL BE INSTALLED PRIOR TO ALL OTHER SITE CONSTRUCTION.
- ALL CLEARING LIMITS SHALL BE VISIBLY MARKED PRIOR TO CLEARING.
- ANY VEGETATION NOT IN THE CONSTRUCTION AREA SHALL BE LEFT UNDISTURBED.
- CONTRACTOR SHALL INFORM THE ENGINEER AND OBTAIN APPROVAL FROM THE ENGINEER OF ANY PROPOSED CHANGES IN PLAN PRIOR TO CONSTRUCTION OF THAT CHANGE. CONTRACTOR SHALL KEEP RECORD OF DEVIATIONS AND FORWARD TO THE ENGINEER.
- MAINTENANCE AND OPERATION OF THE EROSION CONTROL AND SEDIMENTATION SYSTEM SHALL BE THE RESPONSIBILITY OF THE CONTRACTOR. THE CONTRACTOR SHALL BE RESPONSIBLE FOR IMPLEMENTATION OF THE SEDIMENTATION AND EROSION CONTROL MEASURES, AS SHOWN AND AS INSTALLED ON AN AS NEEDED BASIS.
- THE CONSTRUCTED EROSION CONTROL AND SEDIMENTATION PLAN SHALL BE APPROVED BY THE ENGINEER PRIOR TO PERFORMING ANY SITE GRADING OR CLEARING.
- CONTRACTOR WILL HAVE A WATER TRUCK AVAILABLE ON SITE AT ALL TIMES. CONTRACTOR WILL WATER SURFACES OFTEN ENOUGH TO ABATE DUST AS APPROVED BY THE ENGINEER. WATERING WILL INCLUDE WEEKENDS AND HOLIDAYS.
- THE CONTRACTOR SHALL PERFORM ALL STREET CLEANING BY HAND OR WITH A SELF-PROPELLED PICKUP STREET SWEEPER. A STANDARD SELF-PROPELLED STREET SWEEPER WILL NOT BE ALLOWED.
- ALL DISTURBED AREAS SHALL BE HYDROSEEDING. GRASS SEEDING SHALL BE BROADCAST IN ACCORDANCE WITH THE CONTRACT DOCUMENTS.
- ALL CUT AND FILL SLOPES SHALL BE SEEDED AND FERTILIZED FOR EROSION CONTROL. CONTRACTOR SHALL BE RESPONSIBLE FOR SLOPE EROSION UNTIL VEGETATION IS FIRMLY ESTABLISHED.
- ALL STORM DRAIN FACILITIES WITHIN THE PROJECT BOUNDARY, OR WHICH ARE IMPACTED BY THE PROJECT ARE TO BE CLEARED OF SEDIMENT AND DEBRIS PRIOR TO FINAL ACCEPTANCE OF THE PROJECT.
- ALL WORK AND MATERIALS SHALL BE IN ACCORDANCE WITH THE CONTRACT DOCUMENTS.

DUST CONTROL:
CONTRACTOR SHALL LIMIT DUST GENERATION BY CLEARING ONLY THOSE AREAS WHERE IMMEDIATE EXCAVATION AND GRADING SHALL TAKE PLACE MAINTAINING THE ORIGINAL GROUND COVER AS LONG AS PRACTICAL. DUST CONTROL METHODS SHALL BE PERFORMED BY METHODS LISTED IN NOTE NUMBER EIGHT OF THE TESC GENERAL NOTES. SURFACES SHALL BE SPRAYED WITH WATER AS NEEDED IN ORDER TO ABATE DUST AS APPROVED BY THE ENGINEER.

STREET CLEANING:
CONTRACTOR SHALL PERFORM ALL STREET CLEANING AT A MINIMUM OF AT LEAST ONCE AT THE END OF EVERY DAY WORKED AND ON AN AS NEEDED BASIS BASED ON VEHICLE TRACK OUT. STREET CLEANING SHALL BE PERFORMED BY THE METHODS LISTED IN NOTE NUMBER 10 OF THE TESC GENERAL NOTES AND SHALL NOT ALLOW SEDIMENT INTO STORMWATER CONVEYANCE DITCHES OR STRUCTURES. STREET CLEANING METHODS SHALL BE APPROVED BY THE ENGINEER PRIOR TO THE BEGINNING OF CONSTRUCTION.

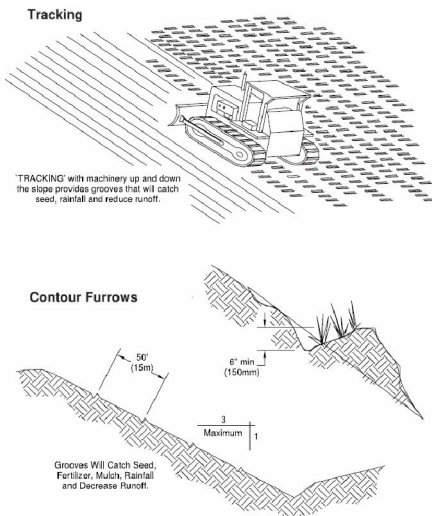

SURFACE ROUGHENING

NTS

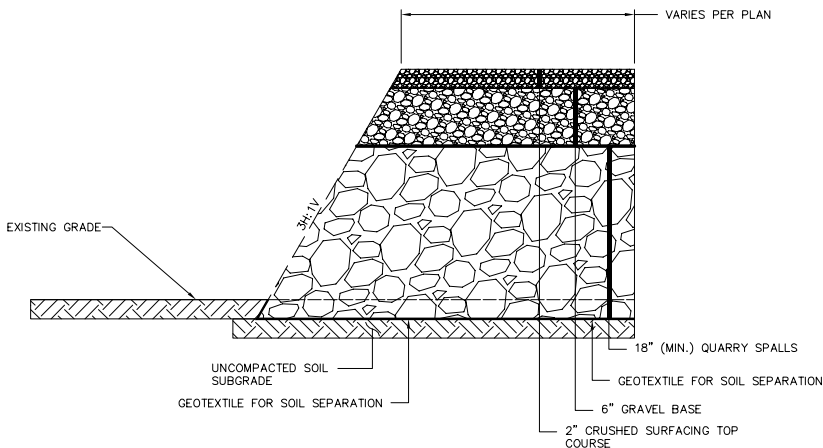

ROAD SECTION AT WETLAND CROSSING

NTS

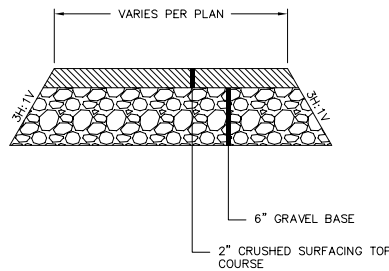

ACCESS ROAD SECTION

NTS

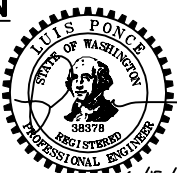

6/15/17

BID SET

DESIGNED BY
DRAWN BY
CHECKED BY
DATE

R&E Reichhardt & Ebe
ENGINEERING INC

P.O. Box 978 | 423 Front Street, Lynden, WA 98264 (360) 354-3687
813 Metcalf Street, Sedro-Woolley, WA 98284 (360) 855-1713

NO.	DATE	DESCRIPTION	BY

CITY OF FERNDAL
2095 MAIN STREET
FERNDAL, WA 98248

GATEWAY NORTH
DETAILS
TESC EROSION CONTROL DETAILS

DWG 15021 DETAILS-GW

JOB#

15021

SCALE

H: N/A

V: N/A

DATE

6/15/17

SHEET

9

of 11

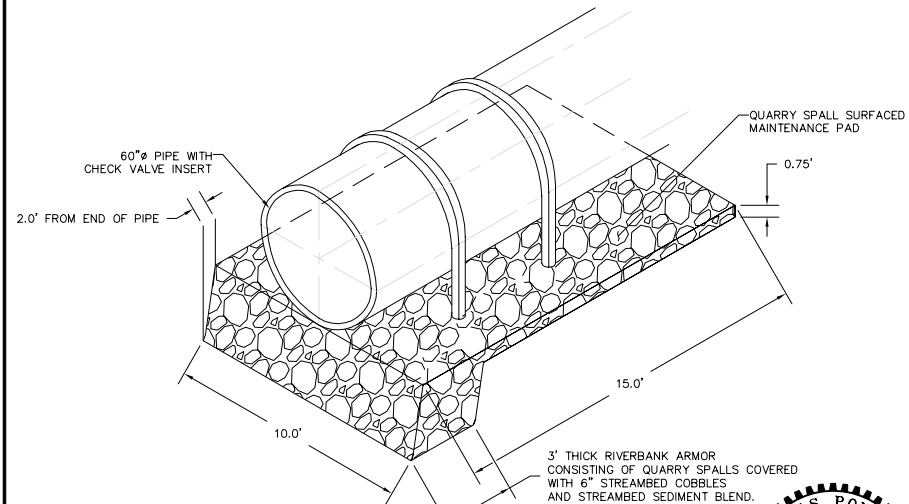
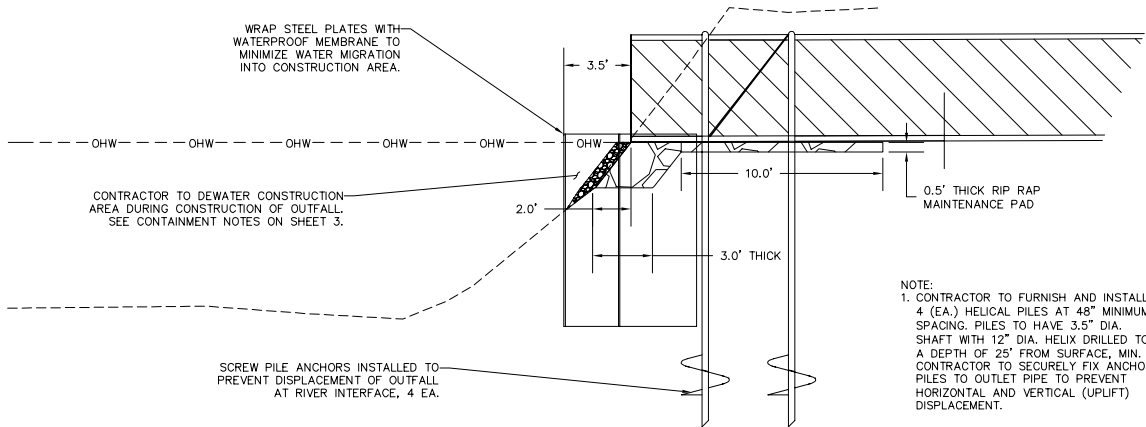
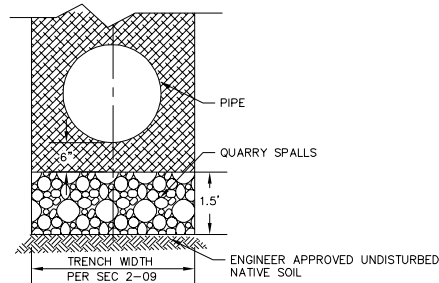
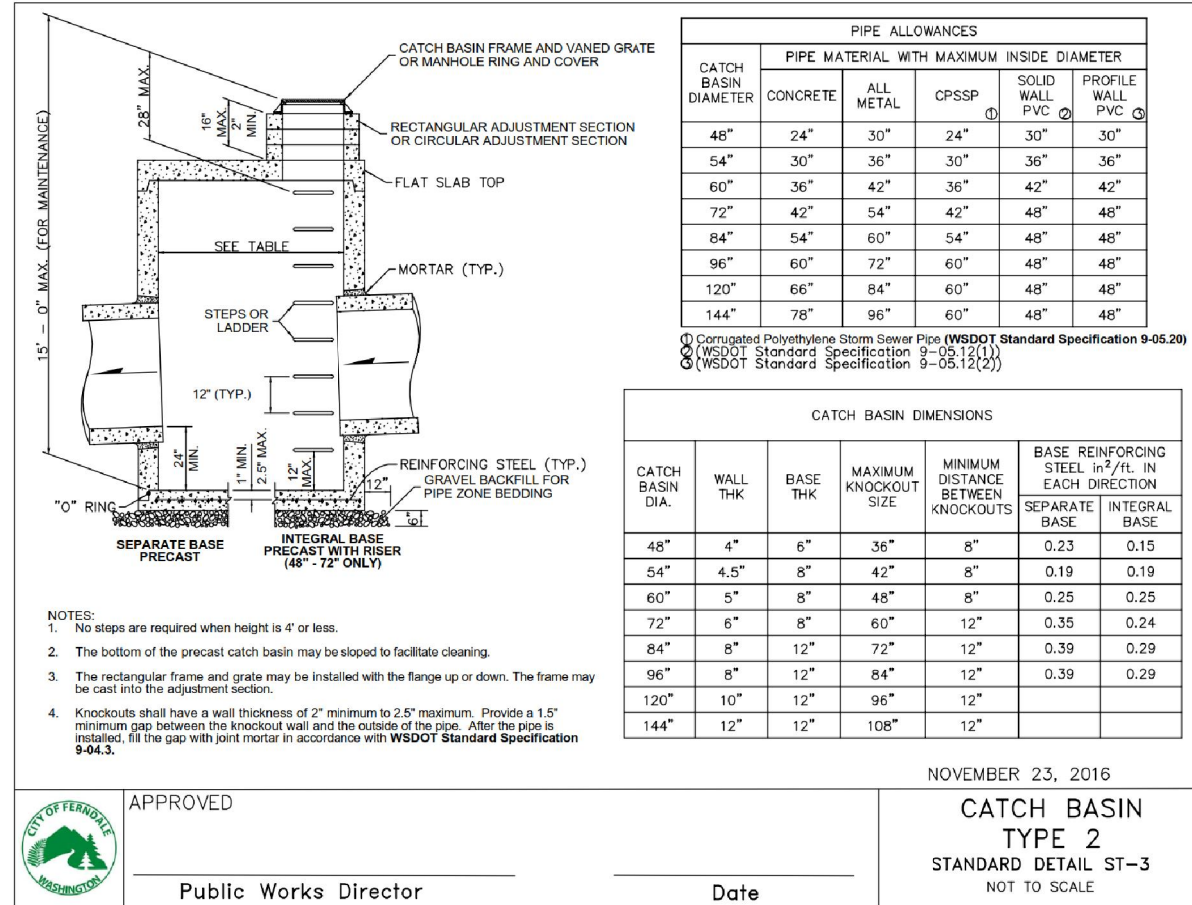
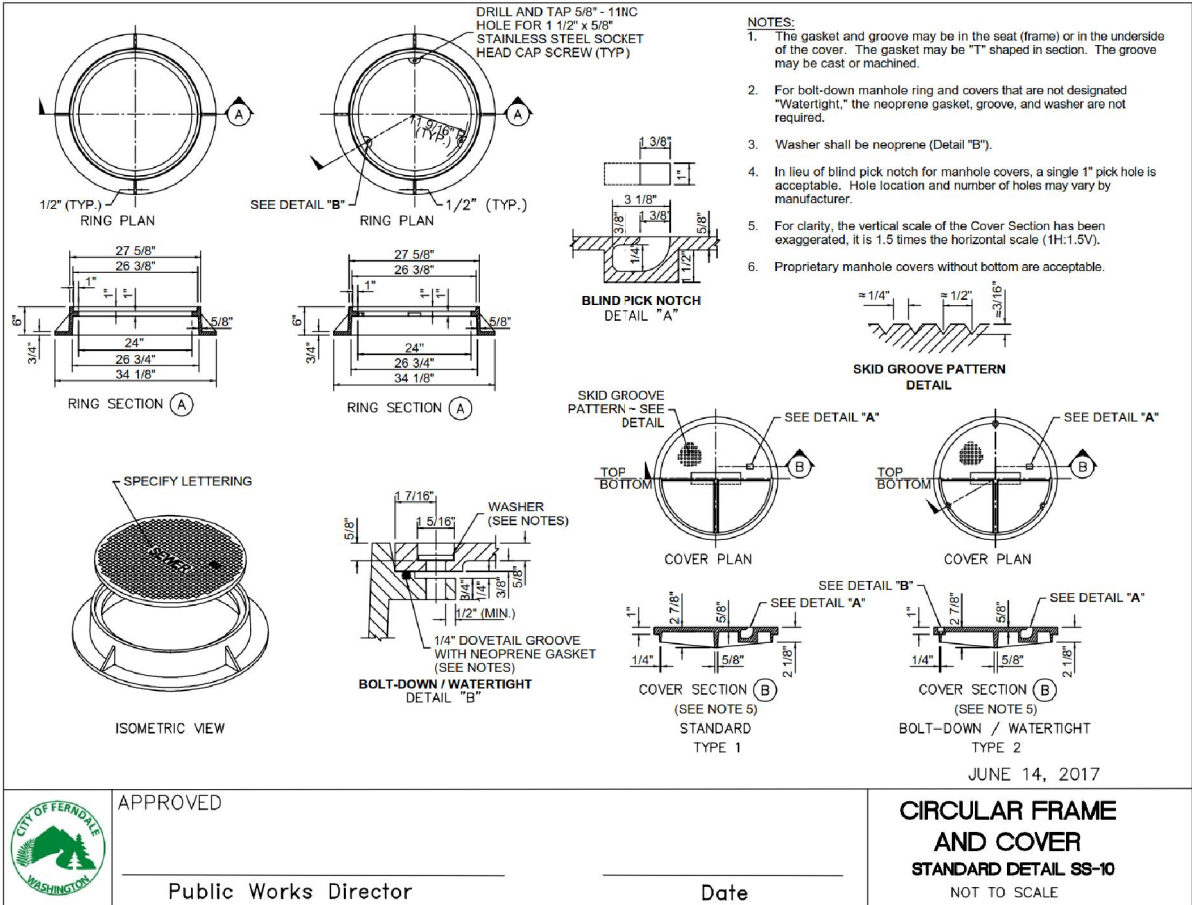

REMOVAL OF UNSUITABLE MATERIAL INCLUDING HAUL, TYPICAL SECTION

STEEL SHEET INSTALL DETAIL

OUTFALL MAINTENANCE PAD DETAIL

BID SET

DESIGNED BY
DRAWN BY
CHECKED BY
DATE

R&E Reichhardt & Ebe
ENGINEERING INC

P.O. Box 978 | 423 Front Street, Lynden, WA 98264 (360) 354-3687
813 Metcalf Street, Sedro-Woolley, WA 98284 (360) 855-1713

CITY OF FERNDALE
2095 MAIN STREET
FERNDALE, WA 98248

GATEWAY NORTH
DETAILS
STORM DETAILS 1

DWG 15021 DETAILS-GW

JOB# 15021

SCALE H: N/A V: N/A

DATE 6/15/17

SHEET 10 of 11

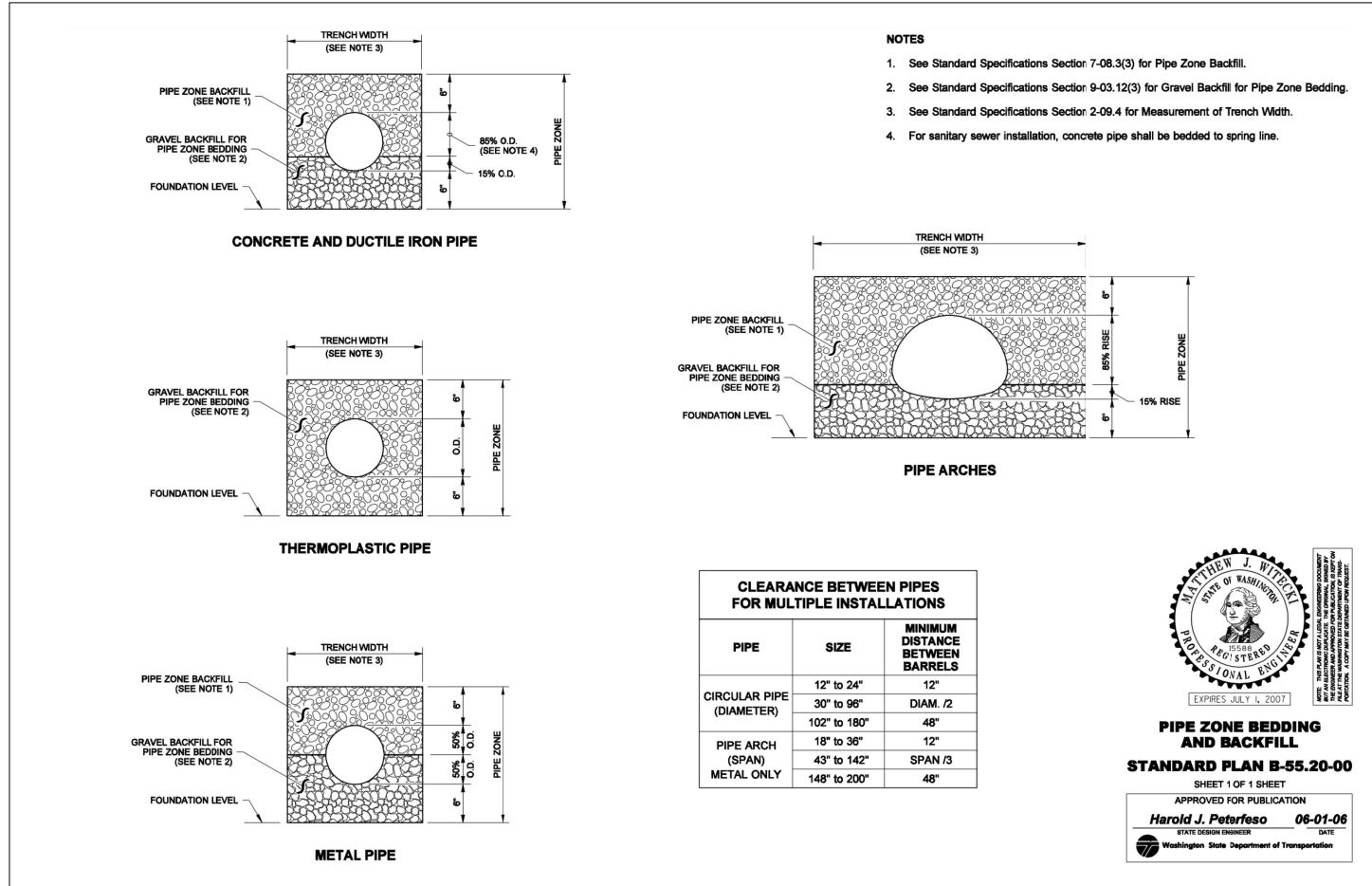
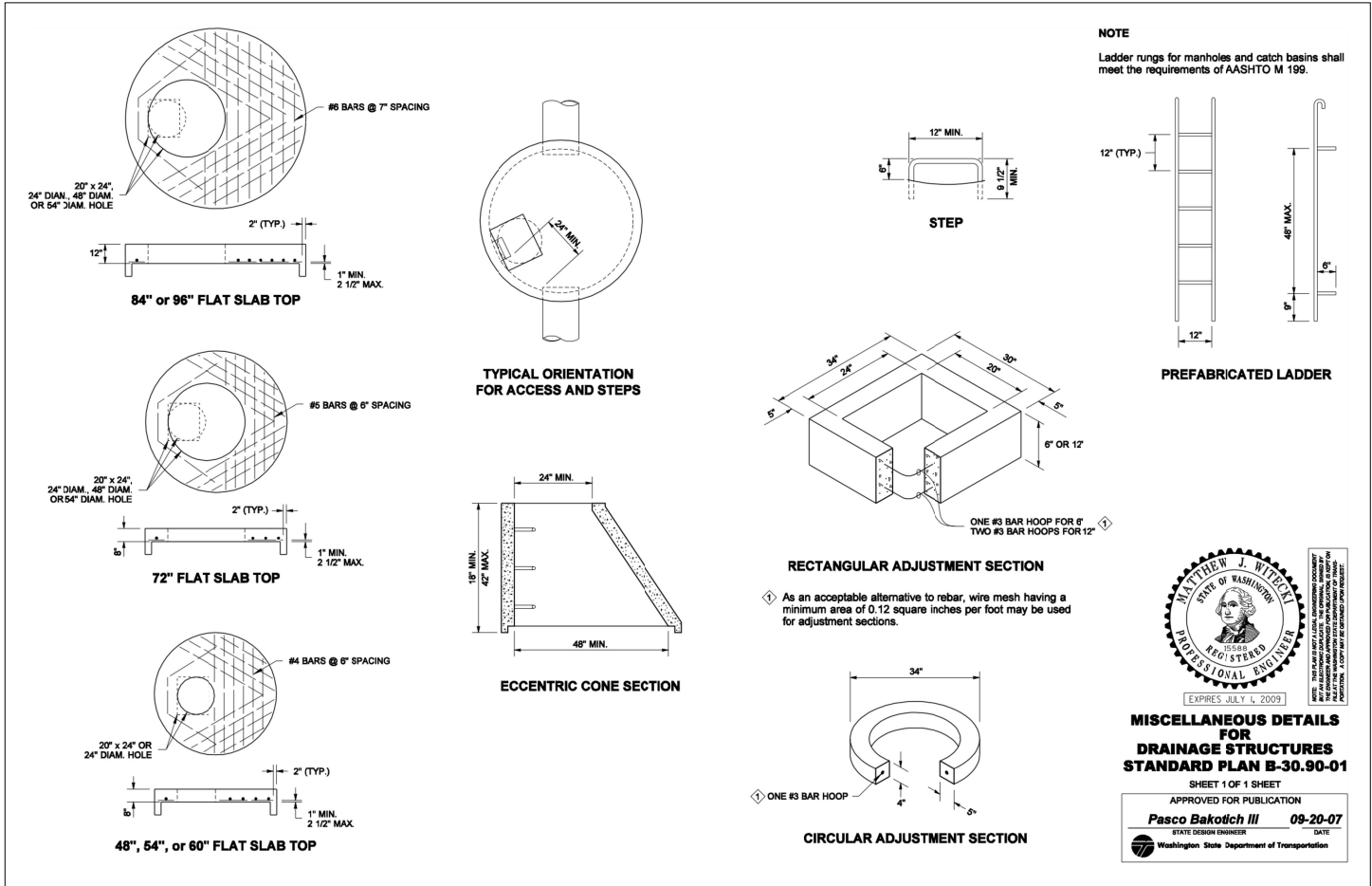

BID SET

DESIGNED BY
DESIGN
DRAWN BY
DRAWN
CHECKED BY
CHECK



Reichhardt & Ebe
ENGINEERING INC

P.O. Box 978 | 423 Front Street, Lynden, WA 98264 (360) 354-3687
813 Metcalf Street, Sedro-Woolley, WA 98284 (360) 855-1713

NO.	DATE	DESCRIPTION	BY

CITY OF FERNDAL
2095 MAIN STREET
FERNDAL, WA 98248

GATEWAY NORTH
DETAILS
STORM DETAILS 2

DWG 15021 DETAILS-GW

JOB#

15021

SCALE

H: N/A

V: N/A

DATE

6/15/17

SHEET

11

of 11

