



Reichhardt & Ebe
ENGINEERING INC

TRANSMITTAL SHEET

Date sent: Friday, August 14, 2015

Sent to: All Planholders

Deliver to: Project Estimator

Transmission sent from: Reichhardt & Ebe Engineering

CONFIRMATION OF RECEIPT OF ADDENDUM

PROJECT: MALLOY AVENUE SANITARY SEWER PROJECT
PROJECT # SS2015-02

Please complete the following form and fax or email back to Reichhardt & Ebe Engineering, Inc. 360-354-0407 or officeadmin@recivil.com as soon as possible.

Have you received Addendum No. 1 for the above-mentioned project?

YES, we received Addendum No. 1

Signed: _____ Dated: _____

Company name (Please Print): _____

Please fax back to Reichhardt & Ebe Engineering, Inc. at 360-354-0407 or email back to officeadmin@recivil.com



Reichhardt & Ebe
ENGINEERING INC

TRANSMITTAL SHEET

TO: ALL BIDDERS	FROM: Luis Ponce, P.E.
COMPANY:	DATE: August 14, 2015
ADDRESS:	TOTAL NO. OF PAGES INCLUDING COVER: 4
RE: City of Ferndale Addendum 1 MALLOY AVENUE SANITARY SEWER PROJECT PROJECT # SS2015-02	

NOTES/COMMENTS:

To the attention of all bidders for the above project:

Please find the enclosed Addendum for the above referenced project.

The enclosed ADDENDUM is to be considered as much a part of the Contract Documents as if it were included in the body of the plans and specifications, and will be incorporated in and made a part of the contract when awarded and when formally executed.

The Bidder shall acknowledge in writing, on the bid form, this addendum in order to have the bid considered.

Luis Ponce, P.E.

ADDENDUM NO. 1
To the Contract Provisions for
CITY OF FERNDALE, WASHINGTON

MALLOY AVENUE SANITARY SEWER PROJECT
PROJECT #SS2015-02

ITEM 1

Plan Sheet 5

Additional signage was added.

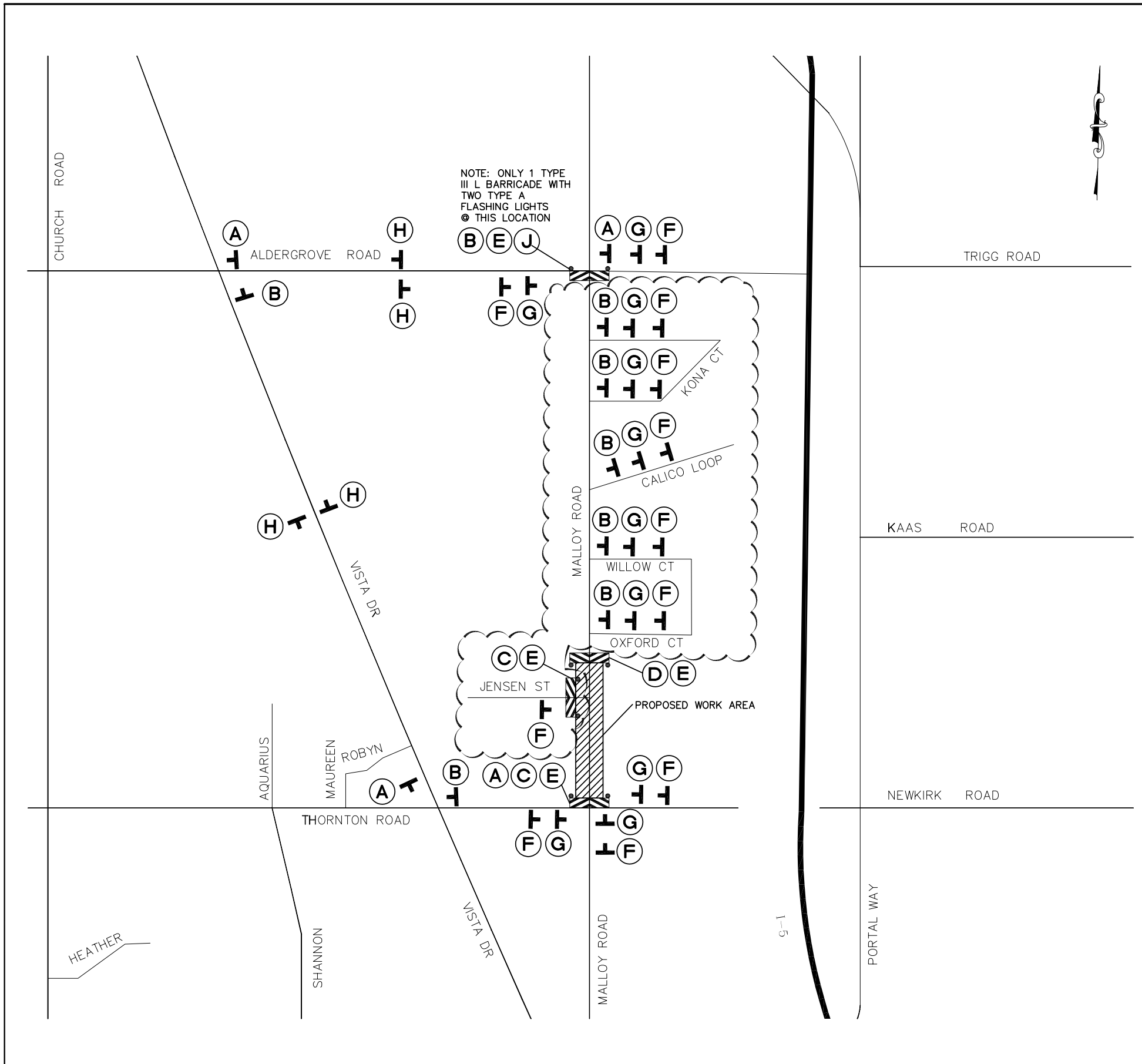

NOTE: ONLY 1 TYPE III L BARRICADE WITH TWO TYPE A FLASHING LIGHTS @ THIS LOCATION

LEGEND

- = SIGN (SHOWN FACING LEFT)
- = PROPOSED WORK AREA
- (A) M4-10L
- (B) M4-10R
- (C) R 11-2
- (D) R 11-4
- (E) TWO TYPE III R AND TYPE III L BARRICADE WITH 2 TYPE A FLASHING WARNING LIGHTS
- (F) W 20-3
- (G) W20-2
- (H) M4-8
- (I) M6-4
- (J) R 11-3

SIGN SPACING = X (1)		
RURAL ROADS	45/55 MPH	500'±
URBAN ARTERIALS & RURAL ROADS	35/40 MPH	350'±
RURAL ROADS, URBAN ARTERIALS, RESIDENTIAL & BUSINESS DISTRICTS	25/30 MPH	200'± (2)
URBAN STREETS	25 MPH OR LESS	100'± (2)

ALL SIGNS ARE BLACK ON ORANGE UNLESS DESIGNATED OTHERWISE

(1) ALL SPACING MAY BE ADJUSTED TO ACCOMMODATE AT-GRADE INTERSECTIONS AND DRIVEWAYS.
 (2) THIS SIGN SPACING MAY BE REDUCED IN URBAN AREAS TO FIT ROADWAY CONDITIONS.



BID SET

DESIGNED BY LP
 DRAWN BY RWG
 CHECKED BY LP

R&E Reichhardt & Ebe ENGINEERING INC
 P.O. Box 978 | 423 Front Street, Lynden, WA 98264 (360) 354-3687
 813 Metcalf Street, Sedro-Woolley, WA 98284 (360) 855-1713

NO.	DATE	DESCRIPTION	BY
	8/14/15	ADDENDUM-1 TRAFFIC CONTROL ADDITIONS TO MALLOY AVE.	LP

CITY OF FERNDALE
 2095 MAIN STREET
 FERNDALE, WA 98248

**MALLOY AVENUE
 SANITARY SEWER PROJECT
 TRAFFIC DETOUR PLAN**

DWG # 15009 ADDENDUM-1		DATE 7/29/2015
JOB # 15009	SCALE H: N/A V: N/A	SHEET 5 of 12