



**Reichhardt & Ebe**  
ENGINEERING INC

TRANSMITTAL SHEET

Date sent: Friday, October 25, 2013  
Sent to: All Planholders  
Deliver to: Project Estimator  
Transmission sent from: Reichhardt & Ebe Engineering  
Number of pages including this page: 10

**CONFIRMATION OF RECEIPT OF ADDENDUM**

PROJECT: Legoe and Washington Intersection Improvements Project

Please complete the following form and fax or email back to Reichhardt & Ebe Engineering, Inc. 360-354-0407 or [bburke@recivil.com](mailto:bburke@recivil.com) as soon as possible.

Have you received Addendum No. 1 for the above-mentioned project?

**YES, we received Addendum No. 1**

Signed: \_\_\_\_\_ Dated: \_\_\_\_\_

Company name (Please Print): \_\_\_\_\_

Please fax back to Reichhardt & Ebe Engineering, Inc. at 360-354-0407 or email back to [bburke@recivil.com](mailto:bburke@recivil.com)

**REICHHARDT & EBE ENGINEERING, INC.  
CONSULTING ENGINEERS**

---

---

**TRANSMITTAL**

---

---

TO: <b>ALL BIDDERS</b>	FROM: <b>Luis Ponce, P.E.</b>
COMPANY:	DATE: <b>10/25/13</b>
FAX NUMBER:	TOTAL NO. OF PAGES INCLUDING COVER: <b>9 +Confirmation of Receipt of Addendum</b>
PHONE NUMBER:	SENDER'S PHONE NUMBER: <b>(360) 855-1713</b>
RE:	SENDER'S FAX NUMBER: <b>(360) 354-0407</b>

City of Ferndale  
Addendum 1  
LEGOE AND WASHINGTON  
INTERSECTION IMPROVEMENTS  
PROJECT  
ST 2013-03

---

---

**ADDENDUM 1**

---

---

**LEGOE AND WASHINGTON INTERSECTION IMPROVEMENTS PROJECT  
ST 2013-03**

**To the attention of all bidders for the above project:**

Please find the enclosed Addendum for the above referenced project.

The enclosed ADDENDUM is to be considered as much a part of the Contract Documents as if it were included in the body of the plans and specifications, and will be incorporated in and made a part of the contract when awarded and when formally executed.

The Bidder shall acknowledge in writing, on the bid form, this addendum in order to have the bid considered.

  
Luis Ponce, P.E.

423 FRONT STREET  
LYNDEN, WASHINGTON 98264  
360-354-3687

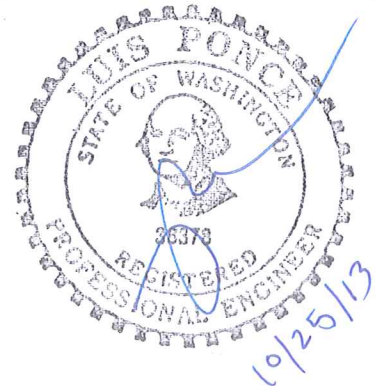

**ADDENDUM NO. 1**  
**To the Contract Provisions for**  
**CITY OF FERNDAL, WASHINGTON**

**LEGOE AND WASHINGTON INTERSECTION IMPROVEMENTS PROJECT**  
**ST 2013-03**

**ITEM 1**

The Bid Proposal Form is replaced in its entirety with the attached **REVISED BID PROPOSAL FORM**. Only bids submitted on the **REVISED BID PROPOSAL FORM** will be considered responsive.

Bid Proposal Form, ITEM NO. 23, the quantity for 'Inlet Protection', has been increased.

Bid Proposal Form, ITEM NO. 31, the quantity for 'Raised Pavement Marker, Type 1', has been increased.

Bid Proposal Form, ITEM NO. 32, the quantity for 'Raised Pavement Marker, Type 2', has been increased.

The 8.7% sales tax item has been removed.

**ITEM 2**

**Plan Sheet 004**

The attached Plan Sheet 004 shall replace Plan Sheet 004 dated 10/18/13. The existing SDCB located at approximately STA 2+12, 14'R shall receive inlet protection.

**ITEM 3**

**Plan Sheet 005**

The attached Plan Sheet 005 shall replace the Plan Sheet 005, dated 10/18/13. Spot elevations and flowline elevations were added to the drawing. A note was added indicating storm drain catch basin rim elevations shall remain.

**END OF ADDENDUM NO. 1**

**LEGOE AND WASHINGTON INTERSECTION IMPROVEMENTS  
CITY OF FERNDALE**

( ) SECTION REFERENCE

ITEM NO.	QUANTITY	DESCRIPTION	UNIT PRICE	TOTAL
1	1 LUMP SUM	MOBILIZATION (1-09)	\$	\$
			per LS	
2	1 LUMP SUM	SPILL PREVENTION, CONTROL, AND COUNTERMEASURES (SPCC) PLAN (1-07)	\$	\$
			per LS	
3	1 LUMP SUM	PROJECT TEMPORARY TRAFFIC CONTROL (1-10)	\$	\$
			per LS	
4	300 HOUR	FLAGGERS AND SPOTTERS (1-10)	\$	\$
			per HR	
5	30 HOUR	OTHER TRAFFIC CONTROL LABOR (1-10)	\$	\$
			per HR	
6	1 LUMP SUM	CLEARING & GRUBBING (2-01)		\$
			per LS	
7	1 LUMP SUM	REMOVAL OF STRUCTURES AND OBSTRUCTIONS (2-02)	\$	\$
			per LS	
8	324 LINEAR FOOT-INCH	SAWCUT ACP (2-02)	\$	\$
			per LF-IN	
9	48 LINEAR FOOT-INCH	SAWCUT PCC (2-02)	\$	\$
			per LF-IN	

**LEGOE AND WASHINGTON INTERSECTION IMPROVEMENTS  
CITY OF FERNDALE**

( ) SECTION REFERENCE

ITEM NO.	QUANTITY	DESCRIPTION	UNIT PRICE	TOTAL
10	342 CUBIC YARD	ROADWAY EXCAVATION INCLUDING HAUL (2-03)	\$	\$
			per CY	
11	100 CUBIC YARD	EMBANKMENT COMPACTION (2-03)	\$	\$
			per CY	
12	20 M GAL.	WATER (2-07)	\$	\$
			per M GAL.	
13	878 SQUARE YARD	CONSTRUCTION GEOTEXTILE FOR SUBGRADE SEPARATION (2-12)	\$	\$
			per SY	
14	373 TON	GRAVEL BASE (4-02)	\$	\$
			per TON	
15	125 TON	CRUSHED SURFACING TOP COURSE (4-04)		
			per TON	
16	163 TON	HMA CLASS 1/2" PG 64-22 (5-04)		
			per TON	
17	0 CALC	JOB MIX COMPLIANCE PRICE ADJUSTMENT (5-04)	\$	\$
			CALC	
18	0 CALC	COMPACTION PRICE ADJUSTMENT (5-04)	\$	\$
			CALC	

**LEGOE AND WASHINGTON INTERSECTION IMPROVEMENTS  
CITY OF FERNDALE**

( ) SECTION REFERENCE

ITEM NO.	QUANTITY	DESCRIPTION	UNIT PRICE	TOTAL
19	1 LUMP SUM	ADJUST TO FINISH GRADES (7-05)	\$	\$
			per LS	
20	100 CUBIC YARD	UNSUITABLE FOUNDATION EXCAVATION INCL. HAUL (7-08)	\$	\$
			per CY	
21	1 FORCE ACCOUNT	EROSION/WATER POLLUTION CONTROL (8-01)	\$	\$ 2,500.00
			FA	
22	1 LUMP SUM	ESC LEAD (8-01)	\$	\$
			per LS	
23	4 EACH	INLET PROTECTION (8-01)	\$	
			per EA	
24	170 LINEAR FOOT	SILT FENCE (8-01)	\$	\$
			per LF	
25	165 LINEAR FOOT	HIGH VISIBILITY FENCE (8-01)	\$	\$
			per LF	
26	1 FORCE ACCOUNT	LANDSCAPE RESTORATION (8-02)	\$	\$ 750.00
			FA	
27	37 SQUARE YARD	SEEDED LAWN INSTALLATION (8-01)	\$	\$
			per SY	

**LEGOE AND WASHINGTON INTERSECTION IMPROVEMENTS  
CITY OF FERNDALE**

( ) SECTION REFERENCE

ITEM NO.	QUANTITY	DESCRIPTION	UNIT PRICE	TOTAL
28	29 LINEAR FOOT	CEMENT CONCRETE TRAFFIC CURB AND GUTTER (8-04)	\$	\$
			per LF	
29	82 LINEAR FOOT	EXTRUDED CURB, TYPE 6 (8-04)	\$	\$
			per LF	
30	40 LINEAR FOOT	CEMENT CONCRETE PEDESTRIAN CURB (8-04)	\$	\$
			per LF	
31	0.22 HUNDRED	RAISED PAVEMENT MARKER TYPE 1 (8-09)	\$	\$
			per HUN	
32	0.07 HUNDRED	RAISED PAVEMENT MARKER TYPE 2 (8-09)	\$	\$
			per HUN	
33	6 SQUARE YARD	CEMENT CONCRETE SIDEWALK (8-14)	\$	\$
			per SY	
34	1 EACH	CEMENT CONCRETE CURB RAMP TYPE SINGLE DIRECTION A (8-14)	\$	\$
			per EA	
35	1 EACH	CEMENT CONCRETE CURB RAMP TYPE PARALLEL B (8-14)	\$	\$
			per EA	

**LEGOE AND WASHINGTON INTERSECTION IMPROVEMENTS  
CITY OF FERNDALE**

( ) SECTION REFERENCE

ITEM NO.	QUANTITY	DESCRIPTION	UNIT PRICE	TOTAL
36	1 LUMP SUM	PERMANENT SIGNING (8-21)	\$	
			per LS	
37	714 LINEAR FOOT	PAINT LINE (8-22)	\$	
			per LF	
38	12 LINEAR FOOT	PLASTIC STOP LINE (8-22)	\$	
			per LF	
39	1 EACH	POTHOLE EXISTING UNDERGROUND UTILITY (8-30)	\$	
			per EA	
40	1 FORCE ACCOUNT	REPAIR EXISTING PUBLIC AND PRIVATE FACILITIES (8-31)	\$	1,000.00
			FA	

**TOTAL: \$** \_\_\_\_\_



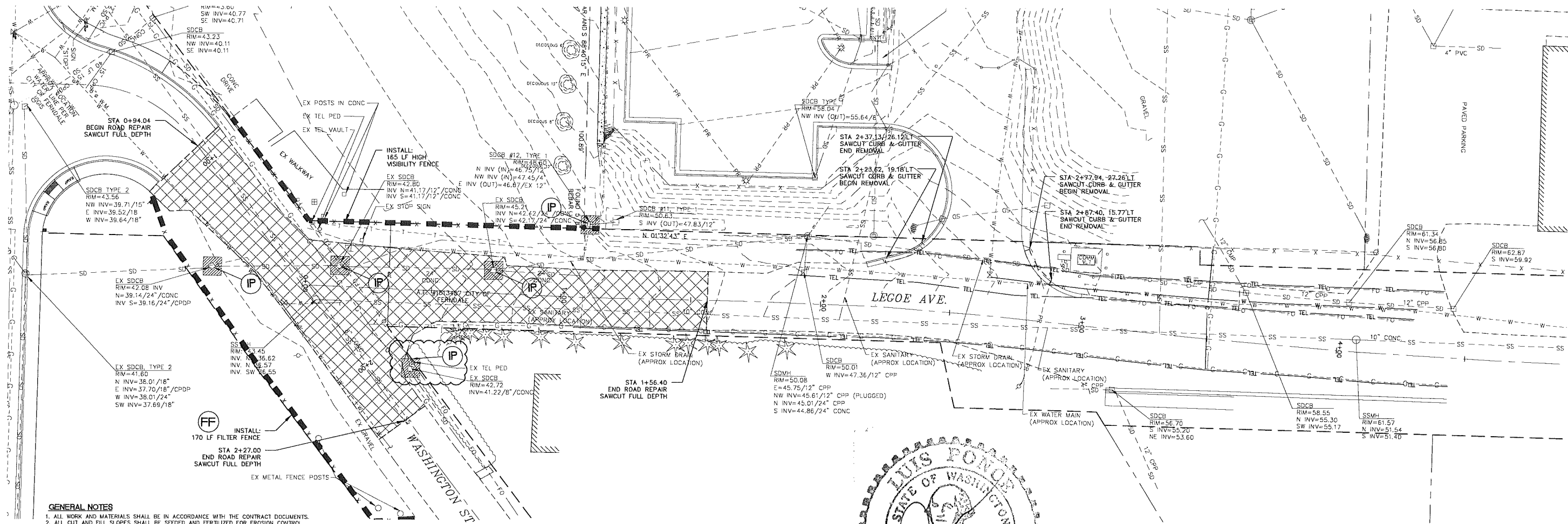
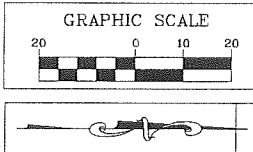

- GENERAL NOTES**
1. ALL WORK AND MATERIALS SHALL BE IN ACCORDANCE WITH THE CONTRACT DOCUMENTS.
  2. ALL CUT AND FILL SLOPES SHALL BE SEEDED AND FERTILIZED FOR EROSION CONTROL. CONTRACTOR SHALL BE RESPONSIBLE FOR SLOPE EROSION UNTIL VEGETATION IS FIRMLY ESTABLISHED.
  3. CONTRACTOR SHALL INFORM THE ENGINEER AND OBTAIN APPROVAL FROM THE ENGINEER OF ANY PROPOSED CHANGES IN PLAN PRIOR TO CONSTRUCTION OF THAT CHANGE. CONTRACTOR SHALL KEEP RECORD OF DEVIATIONS AND FORWARD TO THE ENGINEER.
  4. CONTRACTOR WILL HAVE A WATER TRUCK AVAILABLE ON SITE AT ALL TIMES. CONTRACTOR WILL WATER SURFACES OFTEN ENOUGH TO ABATE DUST AS APPROVED BY THE ENGINEER. WATERING WILL INCLUDE WEEKENDS AND HOLIDAYS.
  5. ALL DISTURBED AREAS SHALL BE HYDROSEEDED. GRASS SEEDING SHALL BE BROADCAST IN ACCORDANCE WITH THE CONTRACT DOCUMENTS.
  6. THE CONTRACTOR SHALL BE RESPONSIBLE FOR IMPLEMENTATION OF THE SEDIMENTATION AND EROSION CONTROL MEASURES AS SHOWN.
  7. THE CONSTRUCTED EROSION CONTROL AND SEDIMENTATION PLAN SHALL BE APPROVED BY THE ENGINEER PRIOR TO PERFORMING ANY SITE GRADING OR CLEARING.
  8. MAINTENANCE AND OPERATION OF THE EROSION CONTROL AND SEDIMENTATION SYSTEM SHALL BE THE RESPONSIBILITY OF THE CONTRACTOR. THE CONTRACTOR SHALL BE RESPONSIBLE FOR IMPLEMENTATION OF THE SEDIMENTATION AND EROSION CONTROL MEASURES.
  9. ANY VEGETATION NOT IN THE CONSTRUCTION AREA SHALL BE LEFT UNDISTURBED.
  10. ALL CLEARING LIMITS SHALL BE VISIBLY MARKED PRIOR TO CLEARING.
  11. ALL STORM DRAIN FACILITIES WITHIN THE PROJECT BOUNDARY, OR WHICH ARE IMPACTED BY THE PROJECT ARE TO BE CLEARED OF SEDIMENT AND DEBRIS PRIOR TO FINAL ACCEPTANCE OF THE PROJECT.
  12. THIS PLAN REPRESENTS THE MINIMUM REQUIREMENTS FOR THIS PROJECT. ADDITIONAL EROSION CONTROL MAY BE REQUIRED BY THE ENGINEER AS ARE FOUND NECESSARY.
  13. THE TEMPORARY EROSION CONTROL SYSTEMS SHALL BE INSTALLED PRIOR TO ALL OTHER SITE CONSTRUCTION.

**DEMOLITION PLAN LEGEND**

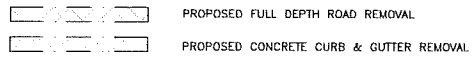

**TESC PLAN LEGEND**

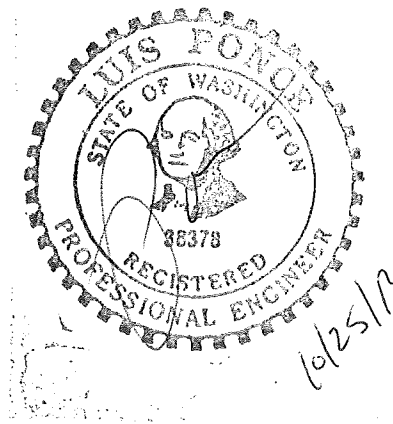
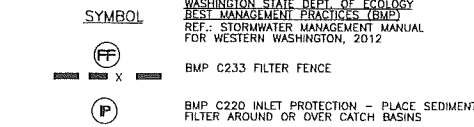

**BID SET**

DESIGNED BY  
KEC  
DRAWN BY  
KEC  
CHECKED BY  
LP

**R&E Reichhardt & Ebe ENGINEERING INC**  
P.O. Box 978 | 423 Front Street, Lynden, WA 98264 (360) 354-3687  
813 Metcalf Street, Sedro-Woolley, WA 98284 (360) 855-1713

NO.	DATE	DESCRIPTION	BY
1	10/25/13	ISSUED FOR ADDENDUM 1	KEC

CITY OF FERDALE  
2095 MAIN ST  
FERDALE, WA 98248

**LEGOE AND WASHINGTON INTERSECTION IMPROVEMENTS**

DWG DEMO AND TESC PLAN		DATE
JOB#	SCALE	SHEET
13041	H:1"=20' v: N.A.	004

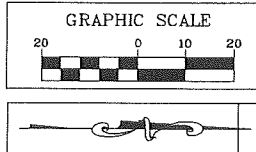

WASHINGTON C1, NORTH CURB	LEGOE C2, SOUTH CURB	LEGOE C3, NORTH CURB
R=15' L=11.99' Δ=45°48'07"	R=25' L=10.00' Δ=22°55'19"	R=25' L=15.23' Δ=34°47'11"
STA/OFFSET	STA/OFFSET	STA/OFFSET
EL=43.14 PC=1+45.12 11.11'L	PC=2+29.06 20.64'L	PC=2+77.52 26.99'L
EL=43.10 PT=1+55.86 15.69'L	PT=2+37.52 25.82'L	PT=2+87.40 15.77'L

(R1) (TYPICAL) - SEE DETAILS

NOTE:  
1. EXISTING STORM DRAIN CATCH BASIN RIM ELEVATIONS SHALL REMAIN.

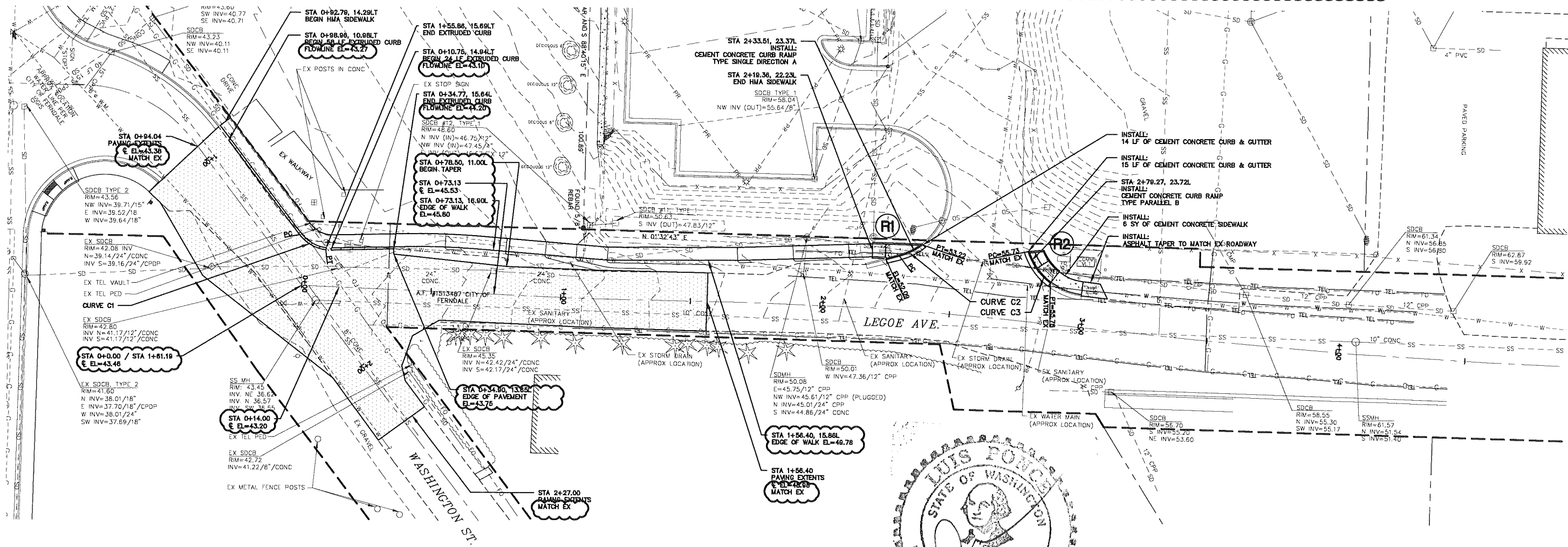

BID SET

DESIGNED BY  
KEC  
DRAWN BY  
KEC  
CHECKED BY  
LP

**R&E** Reichhardt & Ebe  
ENGINEERING INC  
P.O. Box 978 | 423 Front Street, Lynden, WA 98264 (360) 354-3687  
813 Metcalf Street, Sedro-Woolley, WA 98284 (360) 855-1713

NO.	DATE	DESCRIPTION	BY
1	10/25/13	ISSUED FOR ADDENDUM 1	KEC

CITY OF FERDALE  
2095 MAIN ST  
FERDALE, WA 98248

LEGOE AND WASHINGTON  
INTERSECTION IMPROVEMENTS

DWG SITE AND GRADING PLAN		DATE
JOB#	SCALE	10/18/13
13041	H: 1"=20' V: N.A.	SHEET
		005